



**RESOLUTION 19-19**

TO PROVIDE STATEMENT OF SERVICES FOR PARCEL NO.: 2800300680000 LOCATED ON SCOTTSLAWN ROAD WHICH IS PROPOSED TO BE ANNEXED

Whereas, The Scotts Company has filed with the Union County Board of County Commissioners a petition to annex an approximate 10.103 acre parcel (parcel no.: 2800300680000) which is contiguous to the City of Marysville Corporation limits as shown in the legal description and map attached and incorporated as Exhibit A; and

WHEREAS, pursuant to Section 709.023 ORC, the municipal corporation to which annexation is proposed shall adopt a resolution stating what services the municipal corporation will provide to the land petitioned to be annexed, now therefore;

BE IT RESOLVED BY THE COUNCIL OF THE CITY OF MARYSVILLE, OHIO, That:

SECTION I. The following statement of services is provided:

The City of Marysville can provide the following services upon annexation for the approximate 10.103 acre parcel on Scottslawn Road currently owned by The Scotts Company (parcel no.: 2800300680000). This property is currently located within Paris Township and the property owner, The Scotts Company, is requesting annexation into the City.

**Safety Services**

Due to its proximity to the City's current corporation limits, the proposed property can be adequately served by the City's Division of Police and Division of Fire.

**Utilities**

There is currently existing public water infrastructure along Scottslawn Road at an appropriate size and capacity for any use at this property. Also, there is existing privately owned and maintained wastewater infrastructure (by the current property owner) adjacent to this property. Further, the City's water treatment and wastewater treatment facilities have adequate capacity to provide service to this site.

SECTION II. The Clerk of Council shall forward this Resolution, upon its adoption, to the Union County Board of County Commissioners.

One Reading Only September 9, 2019  
Passed: September 9, 2019

Mark Peave  
MAYOR/PRESIDENT OF COUNCIL

APPROVED AS TO FORM:  
[Signature]  
Law Director      Date 9/4/19

ATTEST:  
Rebecca L. Dible  
CLERK OF COUNCIL

# EXHIBIT A

## DESCRIPTION OF NEW ANNEXATION OF A 10.103 ACRE TRACT FROM PARIS TOWNSHIP TO THE CITY OF MARYSVILLE UNION COUNTY, OHIO

Situated in the State of Ohio, County of Union, Township of Paris, Virginia Military Survey No. 5140, and being part of an 11.036 acre tract of land (Parcel Number 2800300680000, Map Number 1130000018000), conveyed to The Scotts Company, an Ohio Corporation, of record in Official Record Volume 277, Page 436, all references to records being on file in the Office of the Recorder, Union County, Ohio, said 10.103 acre tract being more fully described herein;

**BEGINNING** at an angle point in the existing City of Marysville Corporation Line as established in County Resolution No. 118-98 in C) 42, Page 478, being at the southeast corner of said 11.036 acre tract, the southwest corner of a 19.77 acre tract of land, conveyed to The Scotts Company, an Ohio Corporation, of record in Official Record Volume 43, Page 721, the north line of a 74 acre tract of land, conveyed to Jeanine Rausch and Thomas H. Rausch, Trustees, of record in Official Record Volume 93, Page 614, and being the south line of V.M.S. 5140 and the north line of V.M.S. 5141;

Thence, South 84°41'00" West, a distance of 1272.51 feet, with the south line of said 11.036 acre tract, and the north line of said 74 acre tract, to a point;

Thence, North 10°53'00" West, a distance of 5.51 feet, with the west line of said 11.036 acre tract, and an east line of said 74 acre tract, to a point on the west line of said 11.036 acre tract, on the east line of said 74 acre tract, the south right-of-way line of Scottslawn Road (County Road 105), and being at an angle point in said existing City of Marysville Corporation Line;

Thence, North 54°25'00" East, a distance of 1350.93 feet, through said 11.036 acre tract, with the south right-of-way line of said Scottslawn Road, and the existing City of Marysville Corporation Line, to a point on the east line of said 11.036 acre tract and on the west line of said 19.77 acre tract;

Thence, South 14°07'00" East, a distance of 694.56 feet, with the east line of said 11.036 acre tract, the west line of said 19.77 acre tract, and the existing City of Marysville Corporation Line, to the **TRUE POINT OF BEGINNING**, containing 10.103 acres.

For the purpose of this description a bearing of South 84°41'00" West was determined for the south line of an 11.036 acre tract of land (Parcel Number 2800300680000, Map Number 1130000018000), conveyed to The Scotts Company, an Ohio Corporation, of record in Official Record Volume 277, Page 436.

2,045 lineal feet of the 3,324 lineal feet herein described (61.5%), is contiguous with the existing City of Marysville corporation line.



CIVIL & ENVIRONMENTAL CONSULTANTS, INC.

7/25/2019

Mark Alan Smith, P.S.  
Registered Surveyor No. 8232

Date

# ANNEXATION OF 10.103 ACRES FROM PARIS TOWNSHIP TO CITY OF MARYSVILLE

STATE OF OHIO, COUNTY OF UNION, TOWNSHIP OF PARIS,  
VIRGINIA MILITARY SURVEY NO. 5140

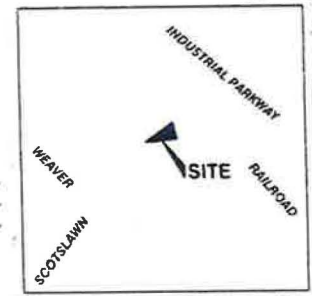

VICINITY MAP  
SCALE: 1"=5000'

### LEGEND

- EXISTING CORPORATION LINE
- PROPOSED CORPORATION LINE
- EXISTING RIGHT-OF-WAY
- PROPOSED CORPORATION AREA

### CONTIGUITY CALCULATION:

2,045 LINEAL FEET OF PERIMETER IS CONTIGUOUS WITH THE EXISTING CORPORATION LINE OF THE CITY OF MARYSVILLE.

A TOTAL OF 3,324 LINEAL FEET OF ANNEXED PERIMETER.

61.5% OF THE PERIMETER OF THE ANNEXED AREA IS CONTIGUOUS TO THE EXISTING CITY OF MARYSVILLE CORPORATION LINE.

THE SCOTTS COMPANY,  
AN OHIO CORPORATION  
114.70 ACRES  
O.R.V. 43, PAGE 721

EXISTING CITY OF MARYSVILLE  
COUNTY RESOLUTION NO: 118-98  
IN CJ 42, PAGE 478

THE SCOTTS COMPANY,  
AN OHIO CORPORATION  
19.77 ACRES  
O.R.V. 43, PAGE 721

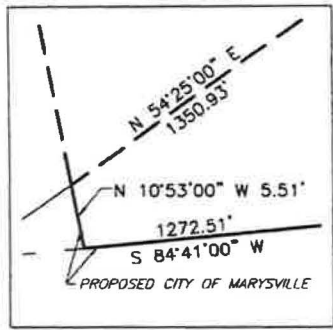

DETAIL "A"  
SCALE: 1"=10'

HERITAGE COOPERATIVE,  
INC., AN OHIO  
NON-PROFIT  
CORPORATION  
277.008 ACRES  
IN: 201402130001027

10.103 ACRES  
PARCEL NO. 2800300680000  
THE SCOTTS COMPANY, AN OHIO CORPORATION  
11.036 ACRES  
O.R.V. 277, PAGE 436  
MAP NO. 1130000018000

EXISTING CITY OF MARYSVILLE  
COUNTY RESOLUTION NO: 118-98  
IN CJ 42, PAGE 478

VMS 5140  
VMS 5141

S 84°41'00" W 1272.51'

SEE DETAIL "A"

PROPOSED CITY OF MARYSVILLE

P.O.B.

EXISTING CITY OF MARYSVILLE  
COUNTY RESOLUTION NO. 118-98  
IN CJ 42, PAGE 478

JEANINE RAUSCH AND THOMAS  
H. RAUSCH, TRUSTEES  
74 ACRES  
O.R.V. 93, PAGE 614

THIS ANNEXATION PLAT IS A GENERAL DESCRIPTION OF THE LOCATION OF PROPERTY TO BE ANNEXED AND IS NOT A BOUNDARY SURVEY AS DEFINED IN CHAPTER, 4733-37 OHIO ADMINISTRATIVE CODE.

*Mark Alan Smith* 7/25/2019  
DATE

MARK ALAN SMITH  
PROFESSIONAL LAND SURVEYOR NO. 8232



NORTH



Civil & Environmental Consultants, Inc.

250 Old Wilson Bridge Road Suite 250 Worthington, OH 43085  
614-540-6633 888-598-6908

www.cecmc.com

PLAT OF SURVEY

DRAWN BY: KAS	CHECKED BY: MAS	APPROVED BY: MAS	EXHIBIT
DATE: JULY 2019	DWG SCALE: 1"=200'	PROJECT NO: 193-198	

1 OF 1

P:\2019\193-198-Survey\Drawings\193-198-5101-Annex.dwg (1/25/2019 - 10:00am) - LP: 7/25/2019 2:14 PM