

ORDINANCE # 2017-12

AN ORDINANCE TO AMEND THE ZONING MAP OF THE CITY OF WALTERBORO, SOUTH CAROLINA, TO PROVIDE FOR CHANGES IN THE ZONING DISTRICTS OF THE CITY OF WALTERBORO BY CHANGING THE ZONING CLASSIFICATION OF TWO PARCELS OF LAND ON WICHMAN STREET DESIGNATED AS TMS #'S 163-11-00-135 AND 163-11-00-136 FROM GENERAL COMMERCIAL DISTRICT (GCD) TO CENTRAL BUSINESS DISTRICT (CBD).

WHEREAS, the Planning Commission of the City of Walterboro met on September 20, 2017 to consider a change in zoning classification from General Commercial District (GCD) to Central Business District (CBD) for the above mentioned properties; and

WHEREAS, pursuant to said meeting, the Planning Commission has recommended that the zoning classification of the property aforesaid be changed to the Central Business District (CBD) zoning classification.

NOW, THEREFORE, BE IT ORDAINED and ordered by the Mayor and Coty Council of the City of Walterboro, South Carolina, that the Zoning Map of the City of Walterboro, South Carolina is hereby amended by changing the Zoning District classification of the property located on Wichman Street, designated as tax map numbers 163-11-00-135 & 163-11-00-136 from General Commercial District (GCD) to Central Business District (CBD) as shown on the attached map.

DONE, this 14th day of November, 2017

William T. Young, Jr
Mayor

ATTEST:

Betty J. Hudson
City Clerk

First Reading: October 3, 2017
Public Hearing: November 14, 2017
Second Reading: November 14, 2017

Artisan Center Lots 163-11@135&136

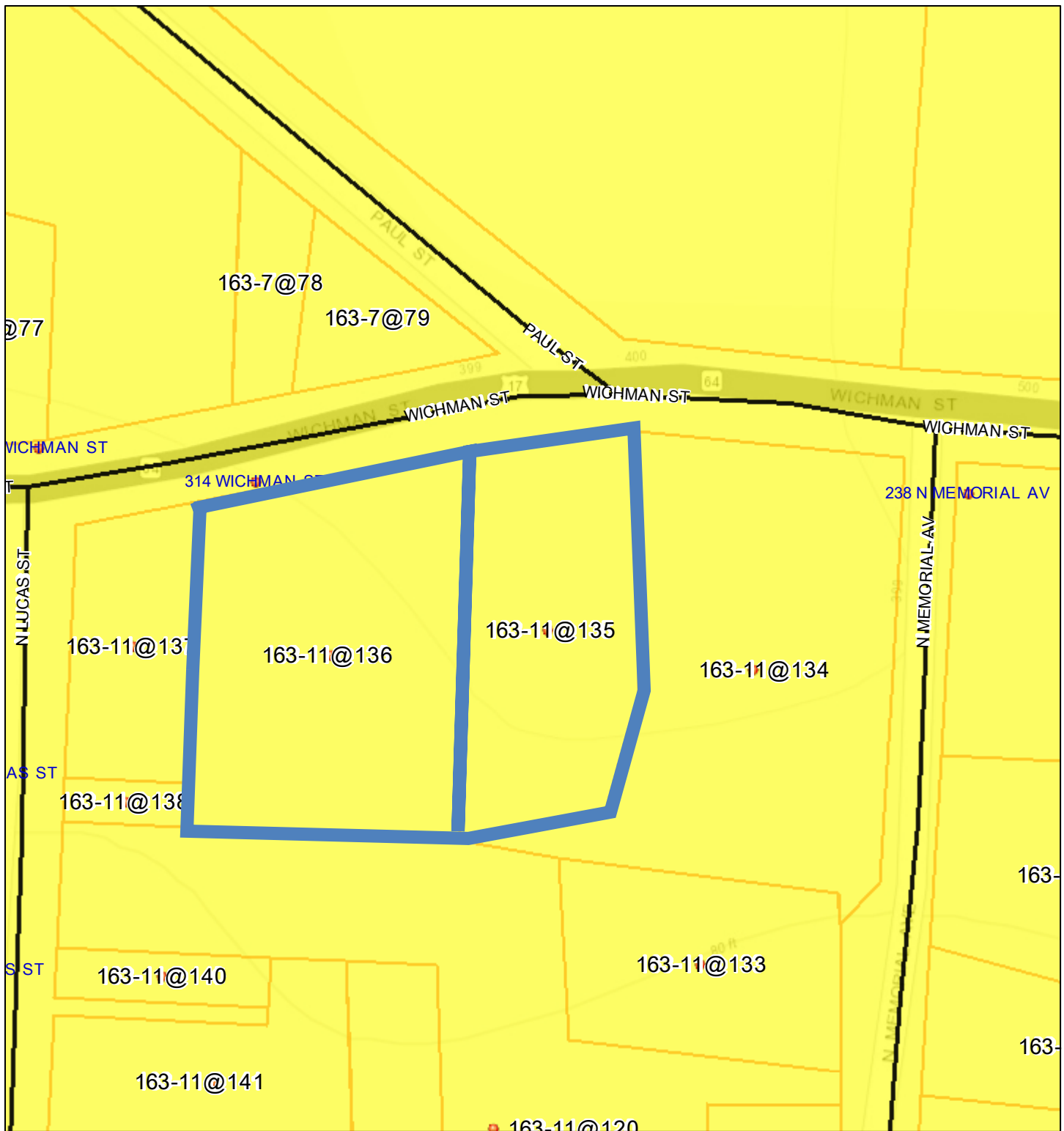

September 29, 2017

Lines

— Override 1

— 2016 Parcel Records (12/31/2016)

● Address Points

Road Centerlines

— Paved

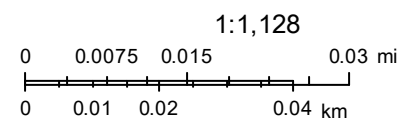

Sources: Esri, HERE, DeLorme, Intermap, increment P Corp., GEBCO, USGS, FAO, NPS, NRCAN, GeoBase, IGN, Kadaster NL, Ordnance Survey, Esri Japan, METI, Esri China (Hong Kong), swisstopo, MapmyIndia, © OpenStreetMap contributors, and the GIS User Community
Source: Esri, DigitalGlobe, GeoEye, Earthstar Geographics, CNES/Airbus

Colleton County Government