



* 2 0 0 6 - 1 5 1 4 9 4 *

2006-15149

THOMAS E. LYONS
LASALLE COUNTY RECORDER
OTTAWA, IL
RECORDED ON
06/16/2006 08:14AM

REC FEE: 34.00
PAGES: 4

2-6

Same

CITY OF EARLVILLE

ORDINANCE NO. ~~6-7-2006C~~
6-7-2006C

AN ORDINANCE ANNEXING CERTAIN TERRITORY TO THE CITY OF EARLVILLE,
LASALLE COUNTY, ILLINOIS

ADOPTED BY THE CITY COUNCIL
OF THE CITY OF EARLVILLE
THIS 7TH DAY OF JUNE, 2006

COPY

Published in pamphlet form by authority of the City Council
of the City of Earlville, LaSalle County, Illinois,
this 7th day of June, 2006.

EXHIBIT A

ANNEXATION DESCRIPTION

Part of the North Half (N1/2) of the Northeast Quarter (NE1/4) of Section Eighteen (18), Township Thirty-six (36) North, Range Three (3) East of the Third (3rd) Principal Meridian, bounded and described as follows, to wit:

Beginning at the Southeast corner of Lot Nineteen (19) according to the plat recorded in Book "K" of Plats, on Page 40; thence North 02 degrees 41 minutes 39 seconds West along the Easterly line of Lots Nineteen (19), Twenty (20), and Twenty-one (21) of said plat, 596.78 feet to the Northeast corner of said Lot Twenty-one (21); thence South 89 degrees 44 minutes 28 seconds East along the Easterly extension of said Lot Twenty-one (21), 145.50 feet; thence South 28 degrees 17 minutes 47 seconds East along the Westerly right of way line of the abandoned C.B & Q. Railroad, 678.27 feet more or less to a point on the South line of the North Half (N1/2) of said Northeast Quarter (NE1/4); thence South 89 degrees 44 minutes 28 seconds West along said South line, a distance of 439.01 feet to the Point of Beginning, containing 3.999 acres, more or less.

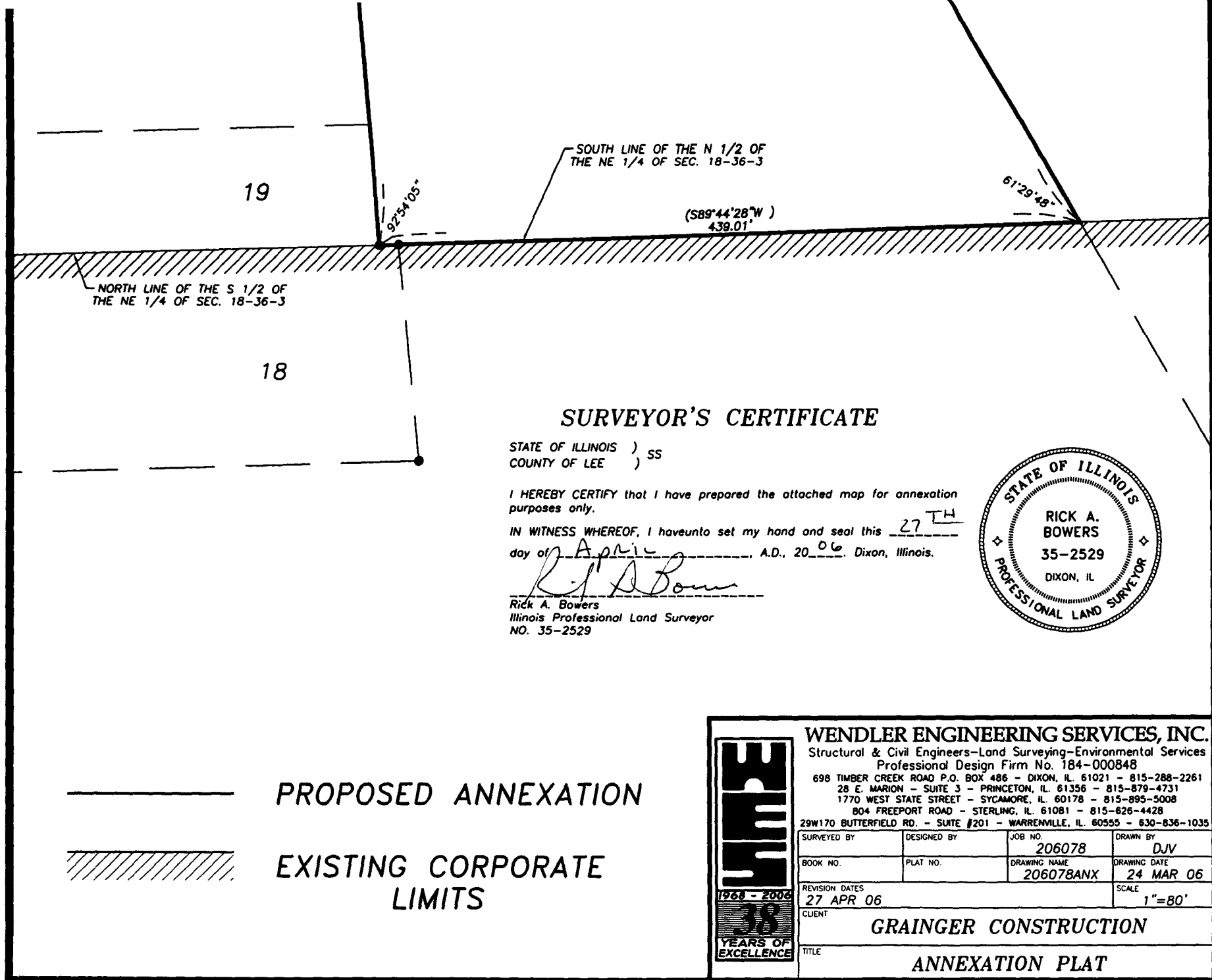

SURVEYOR'S CERTIFICATE

STATE OF ILLINOIS)
COUNTY OF LEE) SS

I HEREBY CERTIFY that I have prepared the attached map for annexation purposes only.

IN WITNESS WHEREOF, I have unto set my hand and seal this 27TH
day of April, A.D., 2006, Dixon, Illinois.

Rick A. Bowers
Rick A. Bowers
Illinois Professional Land Surveyor
NO. 35-2529



PROPOSED ANNEXATION

EXISTING CORPORATE
LIMITS

WENDLER ENGINEERING SERVICES, INC. Structural & Civil Engineers—Land Surveying—Environmental Services Professional Design Firm No. 184-000848 698 TIMBER CREEK ROAD P.O. BOX 486 - DIXON, IL. 61021 - 815-288-2261 28 E. MARION - SUITE 3 - PRINCETON, IL. 61356 - 815-879-4731 1770 WEST STATE STREET - SYCAMORE, IL. 60178 - 815-895-5008 804 FREEPORT ROAD - STERLING, IL. 61081 - 815-626-4428 29W170 BUTTERFIELD RD. - SUITE #201 - WARRENVILLE, IL. 60555 - 630-836-1035			
SURVEYED BY	DESIGNED BY	JOB NO.	DRAWN BY
		206078	DJV
BOOK NO.	PLAT NO.	DRAWING NAME	DRAWING DATE
		206078ANX	24 MAR 06
REVISION DATES		SCALE	
27 APR 06		1"=80'	
CLIENT			
GRAINGER CONSTRUCTION			
TITLE			
ANNEXATION PLAT			



R2006-15149 PAGE 4

EXHIBIT A

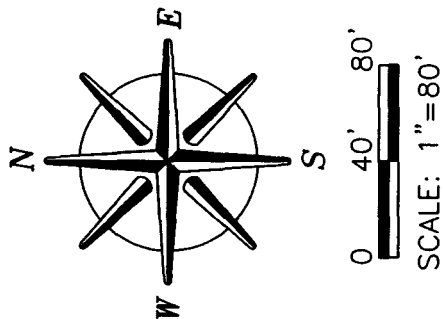

C.B. & Q. RAILROAD (ABANDONED)

(S28°17'47"E)
678.27

TOTAL AREA
3.999 ACRES

145.54'
(S89°44'28"E 145.50')

118°25'37"

87°10'29"

(N2°41'39"W 596.78')
596.63'

(40)

P.

K

(Bk.)

21

22

STATE OF ILLINOIS)
) SS.
COUNTY OF LASALLE)

CERTIFICATE

I, M. Joel Zimmerman, certify that I am the duly elected and acting municipal clerk of the City of Earlville, LaSalle County, Illinois.

I further certify that on June 7, 2006 the Corporate Authorities of the above municipality passed and approved Ordinance No. 06-07-2006C entitled AN ORDINANCE ANNEXING CERTAIN TERRITORY TO THE CITY OF EARLVILE, LASALLE COUNTY, ILLINOIS. The pamphlet form of Ordinance No. 06-07-2006C, including the Ordinance and a cover sheet thereof, was prepared, and a copy of the Ordinance was posted in the municipal building, commencing on June 7, 2006, and continuing for at least ten days thereafter. Copies of the Ordinance were also available for public inspection upon request in the office of the municipal clerk.

DATED at Earlville, Illinois, this 19th day of June, 2006.

(SEAL)

Municipal Clerk