

STATE OF SOUTH CAROLINA)
)
 COUNTY OF LEXINGTON) **ORDINANCE OF THE TOWN OF
 LEXINGTON**

WHEREAS, A petition for annexation dated October 10, 2014 signed by John T. Stephenson, Manager of the Barr Lake Homeowners Association, LLC, owner of the property described therein, was presented to the Town Council of the Town of Lexington; and

WHEREAS, the Town Council of the Town of Lexington has agreed to accept said petition and annex the area described therein unto the Town of Lexington pursuant to the terms of Section 5-3-150 of the Code of Laws of South Carolina 1976; and

WHEREAS, in accordance with Section §155.21.08 of the Zoning Ordinance of the Town of Lexington, the Town Council has received a recommendation from the Planning Commission that the area should be zoned Protected Residential 2 (PR2) and Wildlife Road should be classified as a Collector Road.

WHEREAS, the Town Council concurs with said recommendation; and

WHEREAS, the Town Council of the Town of Lexington has determined that all legal requirements necessary to the annexation of the below described area have been fully complied with,

NOW, THEREFORE, BE IT ORDERED AND ORDAINED BY THE TOWN COUNCIL OF LEXINGTON as follows:

1. That the area herein below is hereby annexed to the Town of Lexington and the corporate limits of the Town of Lexington are hereby extended to include said area being described as follows:

All that certain piece, parcel or tract of land, with the improvements thereon, if any, situate, lying and being in the County of Lexington, State of South Carolina, located off of Wildlife Road (SC 1207), the same being shown and delineated as **PARCEL 'A' 124.23 ACRES** on a plat entitled "Plat prepared for South Carolina Electric and Gas Company", prepared by Associated Engineers and Surveyors, Inc., Larry W. Smith, S.C. P.L.S. No. 3724, dated June 30, 1997 and recorded in the Office of the Register of Deeds for Lexington County, South Carolina on October 15, 1997 in **Slide 324, plat 7**. Reference is craved to said Plat for a more complete and accurate metes and bounds description of said PARCEL 'A'.

Also included shall be all portions of any State or County street, road or right of Way which abuts or adjoins the above-described property.

2. That pursuant to Section §155.15.08 of the Zoning Ordinance of the Town of Lexington the above described area is hereby zoned Protected Residential 2 (PR2) and Wildlife Road is classified as a Collector Road such zoning designations shall be shown on the official zoning map of the Town of Lexington.

3. The Municipal Clerk shall publish notice of this annexation once in a newspaper of general circulation within the Town of Lexington.

4. The Municipal Clerk shall notify and file with the Secretary of State, the State Department of Highways and Public Transportation, and the United States Department of Justice a copy of this Ordinance as notice and description of the new boundary of the Town of Lexington and is authorized to provide such agencies such additional documentation as may be required to fulfill any prerequisites for approval by said agencies

ENACTED AND RATIFIED by the Town Council of the Town of Lexington, this 1st day of December, 2014.



MAYOR

ATTEST:

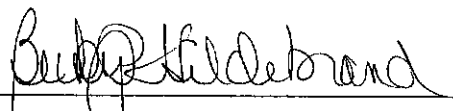

MUNICIPAL CLERK



FIRST READING: November 3, 2014

SECOND READING: December 1, 2014

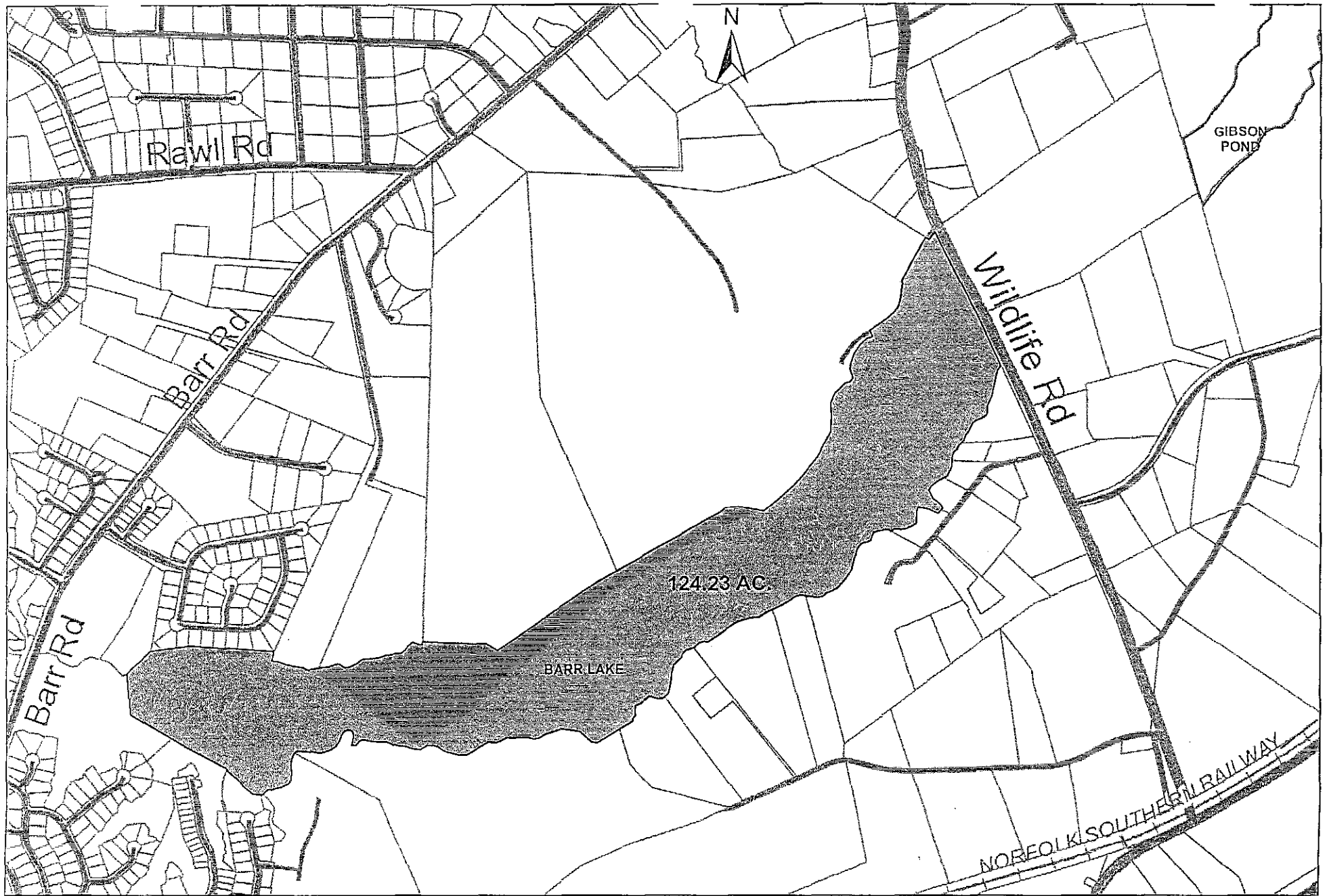
PUBLIC HEARING: December 1, 2014



Legend

-  NEW ANNEXATION BARR POND
-  CURRENT TOWN OF LXINGTON LIMITS

BARR LAKE HOMEOWNERS ASSOCIATION
ANNEXATION

0 225 450 900 1,350 1,800 Feet

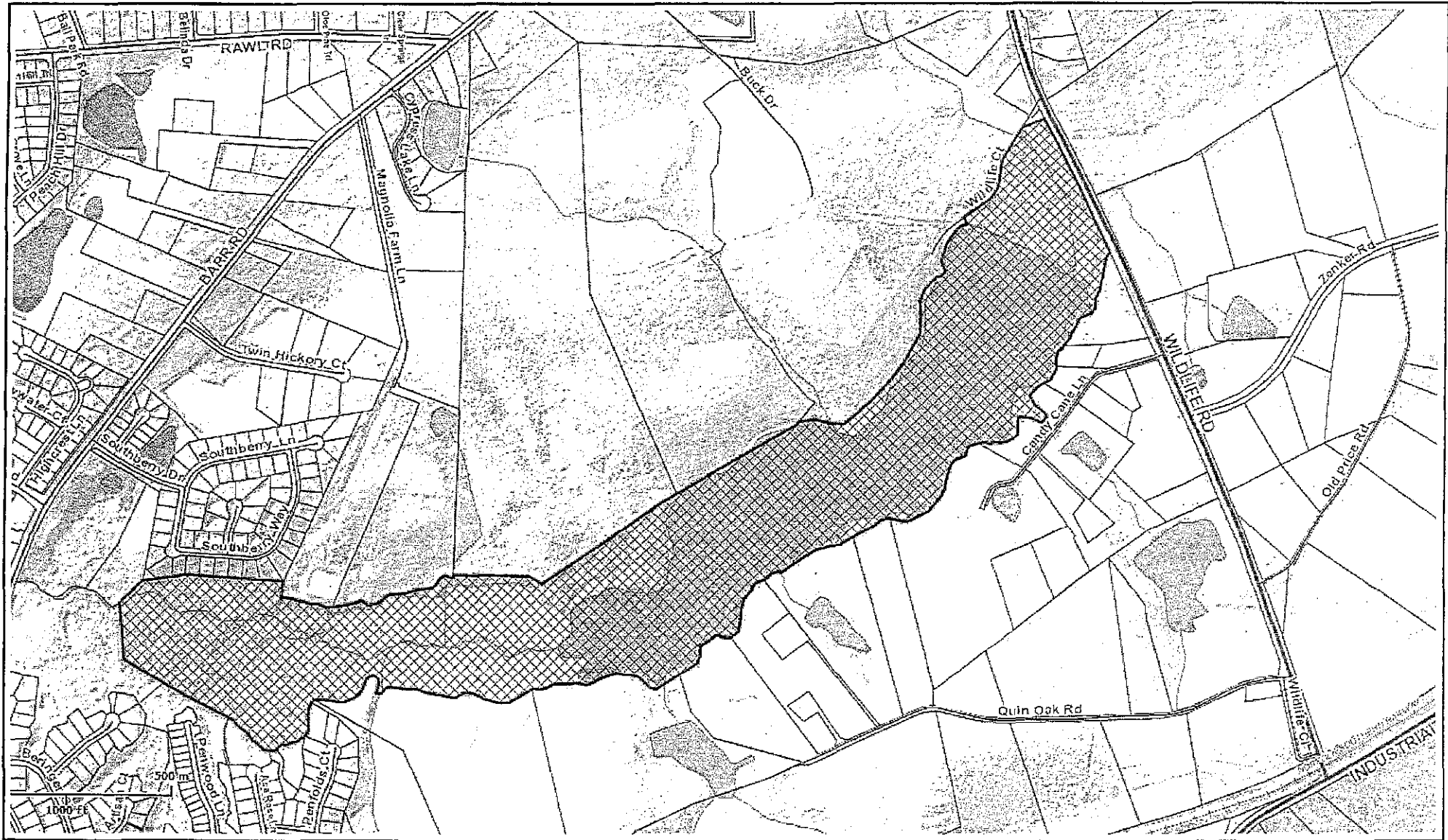

Barr Lake

Printed: Oct 24, 2014

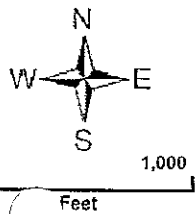

The information on this web site is provided and hosted by Lexington County, South Carolina. Lexington County makes no warranty, representation or guaranty as to the content, sequence, accuracy, timeliness or completeness of any of the database information provided herein. The reader should not rely on the data provided herein for any reason. Lexington County explicitly disclaims any representations and warranties, including, without limitation, the implied warranties of merchantability and fitness for a particular purpose.

