

## **ORDINANCE NO. 3196.3**

**AN ORDINANCE ZONING A PARCEL OF PROPERTY LOCATED AT 3030 W 27<sup>TH</sup> COURT, (PARCEL ID: 26793-000-000), PANAMA CITY, FLORIDA, HAVING APPROXIMATELY 0.909 ACRES, RESIDENTIAL-1, R-1, PROVIDING FOR SEVERABILITY AND PROVIDING FOR AN EFFECTIVE DATE.**

**WHEREAS**, the owners of the parcel of property in the City have requested that the parcels as hereinafter described be zoned Residential-1, R-1; and

**WHEREAS**, following a public hearing of this ordinance pursuant to the statutes provided and the presentation of competent and substantial evidence and a finding that the requested zoning is consistent with the Comprehensive Plan of the City and serves a public purpose, and that enactment of this ordinance would be proper;

**NOW, THEREFORE, BE IT ENACTED BY THE PEOPLE OF THE CITY OF PANAMA CITY, FLORIDA:**

**Section 1:** The following described parcel of real property within the municipal limits of the City of Panama City, Florida, is zoned Residential-1, R-1, to-wit:

Commencing at the Southeast Corner of The Northwest Quarter of Section 25, Township 3 South, Range 15 West, Bay County, Florida; thence North along the East line of said Quarter Section a distance of 363 feet; thence West a distance of 683 feet to the Point of Beginning of the parcel described; thence West 150 feet to an iron stake; thence North 34 degrees 40 minutes West 288.95 feet to high water mark on Pretty Bayou; thence along high water mark of said bayou Easterly 295 feet, more or less, to iron stake; thence South 10 degrees 16 minutes East 219.46 feet to the Point of Beginning.

Address: 3030 W 27<sup>th</sup> Court

Parcel ID #: 26793-000-000

For Map of Property See "Exhibit" A

**Section 2:** The Official Zoning Map is amended to reflect the zoning of the above referenced property.

**Section 3:** All ordinances or parts of ordinances in conflict herewith are hereby repealed to the extent of such conflict.

**Section 4:** This Ordinance shall take effect upon the effective date of the corresponding comprehensive plan map amendment, to reflect the designated zoning adopted in this Ordinance of the above referenced parcel.

**PASSED, APPROVED, AND ADOPTED** at the regular meeting of the Mayor and City Commission of the City of Panama City, Florida this 27<sup>th</sup>, of February 2024.

**CITY OF PANAMA CITY, FLORIDA**  
A Municipal Corporation,

By:   
Michael Rohan Sr., Mayor

ATTEST:

  
Jan Smith, City Clerk-Treasurer

APPROVED AS TO FORM AND CORRECTNESS:

  
Nevin J. Zimmerman, City Attorney  
Burke Blue P.A.

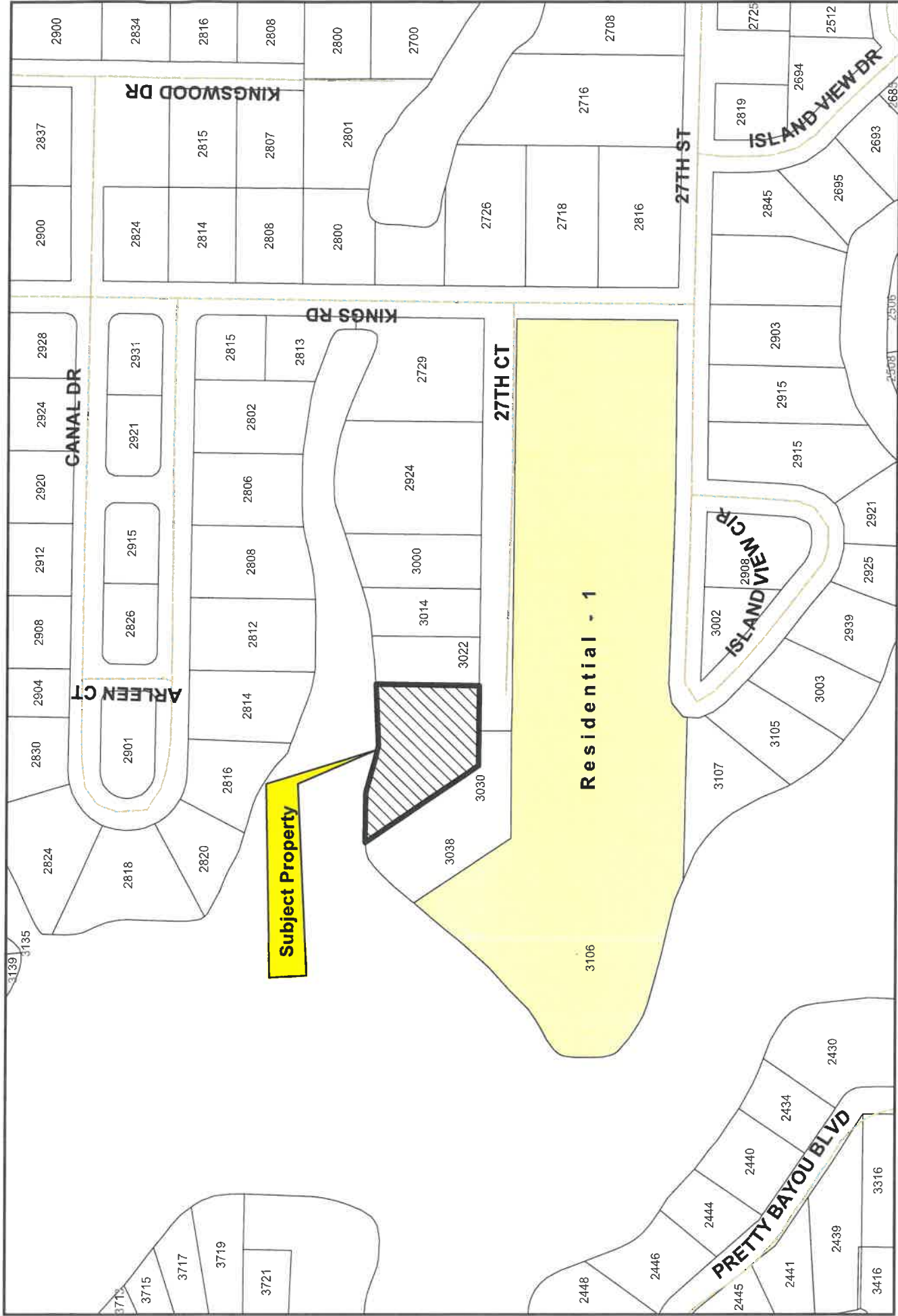

# Exhibit A Zoning Map City of Panama City



1 inch = 232 feet