

ORDINANCE NO. 3086.2

**AN ORDINANCE ZONING A PARCEL OF
PROPERTY LOCATED AT 2151 E 11TH
STREET PANAMA CITY, FLORIDA,
HAVING APPROXIMATELY 29.69 ACRES,
URBAN RESIDENTIAL-2, UR-2,
PROVIDING FOR SEVERABILITY AND
PROVIDING FOR AN EFFECTIVE DATE.**

WHEREAS, the owners of the parcel of property in the City have requested that the parcel as hereinafter described be zoned Urban Residential-2, UR-2; and

WHEREAS, following a public hearing of this ordinance pursuant to the statutes provided and the presentation of competent and substantial evidence and a finding that the requested zoning is consistent with the Comprehensive Plan of the City and serves a public purpose, and that enactment of this ordinance would be proper;

**NOW, THEREFORE, BE IT ENACTED BY THE PEOPLE OF THE CITY
OF PANAMA CITY, FLORIDA:**

Section 1: The following described parcel of real property within the municipal limits of the City of Panama City, Florida, is zoned Urban Residential-2, UR-2, to-wit:

<. To be provided >

PARCEL IDENTIFICATION NUMBER: 15805-000-000

For Map of Property see "Exhibit A."

Section 2: The Official Zoning Map is amended to reflect the zoning of the above referenced property.

Section 3: All ordinances or parts of ordinances in conflict herewith are hereby repealed to the extent of such conflict.

Section 4: This Ordinance shall take effect upon the effective date of the corresponding comprehensive plan map amendment, to reflect the designated zoning adopted in this Ordinance of the above referenced parcel.

PASSED, APPROVED, AND ADOPTED at the regular meeting of the
Mayor and City Commission of the City of Panama City, Florida this 23rd of
August 2022.

CITY OF PANAMA CITY, FLORIDA
A Municipal Corporation,

By

Greg Brudnicki, Mayor

ATTEST:

Jan Smith, City Clerk-Treasurer

APPROVED AS TO FORM AND CORRECTNESS:

Nevin J. Zimmerman, City Attorney
Burke Blue P.A.

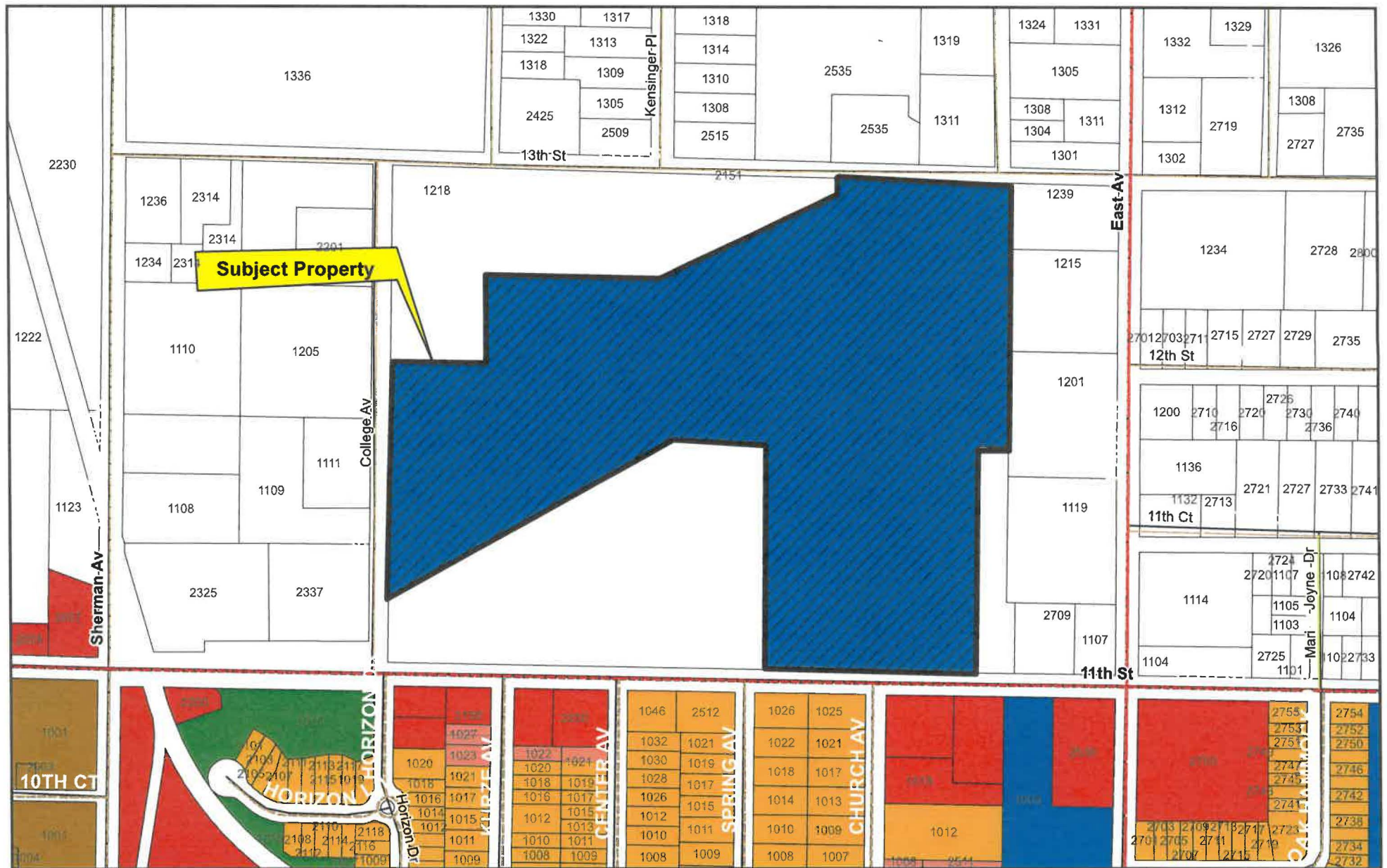

Exhibit A

Zoning Map City of Panama City

Legend

Zoning Districts

- Downtown District
- General Commercial - 1
- General Commercial - 2
- Heavy Industry
- Light Industry

- Mixed Use - 1
- Mixed Use - 2
- Mixed Use - 3
- Planned Unit Development (PUD)
- Preservation
- Public/Institutional

- Recreation
- Residential - 1
- Residential - 2
- Silviculture
- Urban Residential 1
- Urban Residential 2

- Urban Residential 3
- Shoreline
- Water
- NOT ZONED
- Parcels



N



1 inch = 336 feet