

ORDINANCE NO. 4186

AN ORDINANCE OF THE CITY COUNCIL OF THE CITY OF POMONA, CALIFORNIA, AMENDING SECTIONS 74-1 AND 74-31 OF ARTICLE I, CHAPTER 74 OF THE POMONA CITY CODE BY ADOPTING THE 2013 EDITIONS OF THE CALIFORNIA CODES AND RELATED MODEL CODES WITH APPENDICES AND AMENDMENTS THERETO

WHEREAS, the California Building Standards Commission reviews proposed standards and amendments to the California Building Standards Code and adopts new editions and supplements to the Building Standards;

WHEREAS, the State of California has adopted the 2013 California Building standards Codes, which are required by state law to be utilized by each city throughout the state; and

WHEREAS, the City of Pomona desires to incorporate the California Building Standards code into the Pomona City Code by formally adopting, by reference, the published 2013 California Building Standards Code and the following amendments thereto.

NOW, THEREFORE, BE IT ORDAINED, by the City Council of the City of Pomona as follows:

SECTION 1.

Section 74-1, "Administration," of Article I, "In General" of Chapter 74 of the Pomona City Code is hereby amended to read as follows:

Sec. 74-1. Administration.

- (a) Except as otherwise provided in this chapter, the governing rules, regulations and conditions of administrative procedure for the Building Codes adopted in article II of this chapter shall be those set forth in Chapter 1 of the California Building Code, 24W 2013 Edition and the California Administrative Code, 20W 2013 Edition.
- (b) Each model code, and any appendices thereto, adopted by reference in article II of this chapter shall be an official record of the city maintained in the office of the city clerk, and shall be made available for public inspection.

Section 74-31, "Construction codes adopted," of Division 1, "Generally," of Article II, "Construction Standards" of Chapter 74 of the Pomona City Code is hereby amended to read as follows:

Sec. 74-31 Construction Codes Adopted.

- (a) For the purpose of prescribing regulations for erecting, construction, enlargement, alteration, repair, improving, removal, conversion, demolition, occupancy, equipment use,

height, and area of buildings and structures, the following construction codes subject to the modifications set forth in this Chapter, are hereby adopted: the California Building Code, 2013 Edition, based on the 2012 International Building Code as published by the International Code Council, including Part 8 and appendix A of said Part, and including Part 10 and appendix A1 of said Part; the California Administrative Code, 2013 Edition; the California Residential Code, 2013 Edition, based on the 2012 International Residential Code as published by the International Code Council; the California Green Building Standards Code, 2013 Edition; the California Plumbing Code, 2013 Edition, based on the 2012 Uniform Plumbing Code as published by the International Association of Plumbing and Mechanical Officials; the California Mechanical Code, 2013 Edition, based on the 2012 Uniform Mechanical Code as published by the International Association of Plumbing and Mechanical Officials; the California Electrical Code, 2013 Edition, based on the 2011 National Electrical Code as published by the National Fire Protection Association; the California Fire Code, 2013 Edition, as amended by the County of Los Angeles, otherwise known as the 2014 Los Angeles County Fire Code, based on the 2012 International Fire Code as published by the International Code Council; the International Property Maintenance Code, 2006 Edition, as published by the International Code Council; and, the Uniform Code For The Abatement of Dangerous Buildings, 1997 Edition, as published by the International Code Council. For the purpose of prescribing regulations for grading and excavations, Appendix J of the 2013 California Building Code and the Los Angeles County Grading permit fee schedule is hereby adopted. The provisions of these Construction Codes as amended by this chapter shall constitute the Building Regulations of the City of Pomona. Where the California Code of Regulations and State Building Standards Code of Regulations differ from any sections of the Construction Codes, State regulations shall prevail over the Construction Codes.

One(1)copy of all the above codes and standards therefore are on file in the office of the building official pursuant to Health and Safety Code Section 18942 (d)(1)and are made available for public inspection.

Notwithstanding the provisions of the above-referenced construction codes, all fees for services provided pursuant to the construction codes shall not take effect until a resolution for such fees is adopted by the City Council pursuant to California Government Code Sections 66016 and 66020."

(b) Amendments to the 2013 California Building Code.

a) Section 907.5.2.2 is amended to add items 5 and 6 as follows.

[F] 907.5.2.2 Emergency voice/alarm communication system. Emergency voice/alarm communication system required by this code shall be designed and installed in accordance with NFPA 72. The operation of any automatic fire detector, sprinkler water flow device or manual fire alarm box shall automatically sound an alert tone followed by voice instructions giving approved information and directions for a general or staged evacuation in accordance with the building's fire safety and evacuation plans required by Section 404. In high-rise buildings and Group I-2 occupancies having floors located more than 75 feet above the lowest level fire department vehicle access, the system shall

operate on a minimum of the alarming floor, the floor above and the floor below. Speakers shall be provided throughout the building by paging zones. At a minimum, paging zones shall be provided as follows:

1. Elevator groups.
2. Exit stairways.
3. Each floor.
4. Areas of refuge as defined in Section 1002.1.
5. Dwelling Units in apartment houses.
6. Hotel guest rooms or suites.

Exception: In Group 1-1 and R-2.1 occupancies, the alarm shall sound in a constantly attended area and a general occupant notification shall be broadcast over the overhead page.

Table 1505.1 is amended, by the deletion of Table 1505.1 and the addition of a new Table 1505.1 thereto, to read as follows:

^a
**TABLE 1505.1 MINIMUM ROOF
COVERING CLASSIFICATIONS TYPES
OF CONSTRUCTION**

IA	IB	IIA	IIB	IIIA	IIIB	IV	VA	VB
B	B	B	B	B	B	B	B	B

For SI: 1 foot = 304.8 mm, 1 square foot = 0.0929 m².

- a) Unless otherwise required in accordance with Chapter 7A.
- b) Section 1505.1.3 is amended, by the deletion of the entire section and the addition of a new section thereto, to read as follows:

1505.1.3 Roof coverings within all other areas. The entire roof covering of every existing structure where more than 50 percent of the total roof area is replaced within any one-year period, the entire roof covering of every new structure, and any roof covering applied in the alteration, repair or replacement of the roof of every existing structure, shall be a fire-retardant roof covering that is at least Class B.
- c) Section 1505.5 is amended, by the deletion of the entire section.
- d) Section 1505.7 is amended, by the deletion of the entire section.
- e) Section 1613.6.1 of the 2010 Edition of the California Building Code is amended to read as follows:

1613.6.1 Assumption of flexible diaphragm. Add the following text at the end of Section 12.3.1.1 of ASCE 7:

Diaphragms constructed of wood structural panels or untopped steel decking shall also be permitted to be idealized as flexible, provided all of the following conditions are met:

1. Toppings of concrete or similar materials are not placed over wood structural panel diaphragms except for nonstructural toppings no greater than 1 ½ inches (38 mm) thick.
2. Each line of vertical elements of the seismic-force-resisting system complies with the allowable story drift of Table 12.12-1.
3. Vertical elements of the seismic-force-resisting system are light-framed walls sheathed with wood structural panels rated for shear resistance or steel sheets.
4. Portions of wood structural panel diaphragms that cantilever beyond the vertical elements of the ~~lateral~~ seismic-force-resisting system are designed in accordance with Section 4.2.5.2 of AF&PA SDPWS.

- f) Section 1613.8 is added to Chapter 16 of the 2013 Edition of the California Building Code to read as follows:

1613.8 ASCE 7, Table 12.8-2. Modify ASCE 7 Table 12.8-2 by adding the following:

Structure Type	C _t	x
Eccentrically braced steel frames <u>and buckling-restrained braced frames</u>	0.03 (0.0731) ^a	0.75

- g) Section 1613.9 is added to Chapter 16 of the 2013 Edition of the California Building Code to read as follows:

1613.9 ASCE 7, 12.2.3.1, Exception 3. Modify ASCE 7 Section 12.2.3.1 Exception 3 to read as follows:

3. Detached one and two family dwellings up to two stories in height of light frame construction.

- h) Section 1613.10 is added to Chapter 16 of the 2013 Edition of the California Building Code to read as follows:

12.10.2.2.3 Wood Diaphragms. In wood diaphragms, the continuous ties shall be in addition to the diaphragm sheathing. Anchorage shall not be accomplished by use of toe nails or nails subject to withdrawal nor shall wood ledgers or framing be used in cross-grain bending or cross-grain tension. The diaphragm sheathing shall not be considered effective as providing ties or struts required by this section.

For structures assigned to Seismic Design Category D, E or F, wood diaphragms supporting concrete or masonry walls shall comply with the following:

1. The spacing of continuous ties shall not exceed 40 feet. Added chords of diaphragms may be used to form subdiaphragms to transmit the anchorage forces to the main continuous crossties.
 2. The maximum diaphragm shear used to determine the depth of the subdiaphragm shall not exceed 75% of the maximum diaphragm shear.
- i) Section 1613.11 is added to Chapter 16 of the 2013 Edition of the California Building Code to read as follows:

1613.11 Seismic Design Provisions for Hillside Buildings.

1613.11.1 Purpose. The purpose of this section is to establish minimum regulations for the design and construction of new buildings and additions to existing buildings when constructing such buildings on or into slopes steeper than one unit vertical in three units horizontal (33.3%). These regulations establish minimum standards for seismic force resistance to reduce the risk of injury or loss of life in the event of earthquakes.

1613.11.2 Scope. The provisions of this section shall apply to the design of the lateral-force-resisting system for hillside buildings at and below the base level diaphragm. The design of the lateral-force-resisting system above the base level diaphragm shall be in accordance with the provisions for seismic and wind design as required elsewhere in this division.

Exception: Non-habitable accessory buildings and decks not supporting or supported from the main building are exempt from these regulations.

1613.11.3 Definitions. For the purposes of this section certain terms are defined as follows:

BASE LEVEL DIAPHRAGM is the floor at, or closest to, the top of the highest level of the foundation.

DIAPHRAGM ANCHORS are assemblies that connect a diaphragm to the adjacent foundation at the uphill diaphragm edge.

DOWNHILL DIRECTION is the descending direction of the slope approximately perpendicular to the slope contours.

FOUNDATION is concrete or masonry which supports a building, including footings, stem walls, retaining walls, and grade beams.

FOUNDATION EXTENDING IN THE DOWNHILL DIRECTION is a foundation running downhill and approximately perpendicular to the uphill foundation.

HILLSIDE BUILDING is any building or portion thereof constructed on or into a slope steeper than one unit vertical in three units horizontal (33.3%). If only a portion of the building is supported on or into the slope, these regulations apply to the entire building.

PRIMARY ANCHORS are diaphragm anchors designed for and providing a direct connection as described in Sections 1613.12.5 and 1613.12.7.3 between the diaphragm and the uphill foundation.

SECONDARY ANCHORS are diaphragm anchors designed for and providing a redundant diaphragm to foundation connection, as described in Sections 1613.12.6 and 1613.12.7.4.

UPHILL DIAPHRAGM EDGE is the edge of the diaphragm adjacent and closest to the highest ground level at the perimeter of the diaphragm.

UPHILL FOUNDATION is the foundation parallel and closest to the uphill diaphragm edge.

1613.11.4 Analysis and Design.

1613.11.4.1 General. Every hillside building within the scope of this section shall be analyzed, designed, and constructed in accordance with the provisions of this division. When the code-prescribed wind design produces greater effects, the wind design shall govern, but detailing requirements and limitations prescribed in this and referenced sections shall be followed.

1613.11.4.2 Base Level Diaphragm-Downhill Direction. The following provisions shall apply to the seismic analysis and design of the connections for the base level diaphragm in the downhill direction.

1613.11.4.2.1 Base for Lateral Force Design Defined. For seismic forces acting in the downhill direction, the base of the building shall be the floor at or closest to the top of the highest level of the foundation.

1613.11.4.2.2 Base Shear. In developing the base shear for seismic design, the response modification coefficient (R) shall not exceed 5 for bearing wall and building frame systems. The total base shear shall include the forces tributary to the base level diaphragm including forces from the base level diaphragm.

1613.11.5 Base Shear Resistance-Primary Anchors.

1613.11.5.1 General. The base shear in the downhill direction shall be resisted through primary anchors from diaphragm struts provided in the base level diaphragm to the foundation.

1613.11.5.2 Location of Primary Anchors. A primary anchor and diaphragm strut shall be provided in line with each foundation extending in the downhill direction. Primary anchors and diaphragm struts shall also be provided where interior vertical lateral-force-resisting elements occur above and in contact with the base level diaphragm. The spacing of primary anchors and diaphragm struts or collectors shall in no case exceed 30 feet (9144 mm).

1613.11.5.3 Design of Primary Anchors and Diaphragm Struts. Primary anchors and diaphragm struts shall be designed in accordance with the requirements of Section 1613.11.8.

1613.11.5.4 Limitations. The following lateral-force-resisting elements shall not be designed to resist seismic forces below the base level diaphragm in the downhill direction:

1. Wood structural panel wall sheathing,
2. Cement plaster and lath,
3. Gypsum wallboard, and
4. Tension only braced frames.

Braced frames designed in accordance with the requirements of Section 2205.2.2 may be used to transfer forces from the primary anchors and diaphragm struts to the foundation provided lateral forces do not induce flexural stresses in any member of the frame or in the diaphragm struts. Deflections of frames shall account for the variation in slope of diagonal members when the frame is not rectangular.

1613.11.6. Base Shear Resistance-Secondary Anchors.

1613.11.6.1 General. In addition to the primary anchors required by Section 1613.12.5, the base shear in the downhill direction shall be resisted through secondary anchors in the uphill foundation connected to diaphragm struts in the base level diaphragm.

Exception: Secondary anchors are not required where foundations extending in the downhill direction spaced at not more than 30 feet (9144 mm) on center extend up to and are directly connected to the base level diaphragm for at least 70% of the diaphragm depth.

1613.11.6.2 Secondary Anchor Capacity and Spacing. Secondary anchors at the base level diaphragm shall be designed for a minimum force equal to the base shear, including forces tributary to the base level diaphragm, but not less than 600 pounds per lineal foot (8.76 kN/m). The secondary anchors shall be uniformly distributed along the uphill diaphragm edge and shall be spaced a maximum of four feet (1219 mm) on center.

1613.11.6.3 Design. Secondary anchors and diaphragm struts shall be designed in accordance with Section 1613.12.8.

1613.11.7 Diaphragms Below the Base Level-Downhill Direction. The following provisions shall apply to the lateral analysis and design of the connections for all diaphragms below the base level diaphragm in the downhill direction.

1613.11.7.1 Diaphragm Defined. Every floor level below the base level diaphragm shall be designed as a diaphragm.

1613.11.7.2 Design Force. Each diaphragm below the base level diaphragm shall be designed for all tributary loads at that level using a minimum seismic force factor not less than the base shear coefficient.

1613.11.7.3 Design Force Resistance-Primary Anchors. The design force described in Section 1613.11.7.2 shall be resisted through primary anchors from diaphragm struts provided in each diaphragm to the foundation. Primary anchors shall be provided and designed in accordance with the requirements and limitations of Section 1613.11.5.

1613.11.7.4 Design Force Resistance-Secondary Anchors.

1613.11.7.4.1 General. In addition to the primary anchors required in Section 1613.11.7.3, the design force in the downhill direction shall be resisted through secondary anchors in the uphill foundation connected to diaphragm struts in each diaphragm below the base level.

Exception: Secondary anchors are not required where foundations extending in the downhill direction, spaced at not more than 30 feet (9144 mm) on center, extend up to and are directly connected to each diaphragm below the base level for at least 70% of the diaphragm depth.

1613.11.7.4.2 Secondary Anchor Capacity. Secondary anchors at each diaphragm below the base level diaphragm shall be designed for a minimum force equal to the design force but not less than 300 pounds per lineal foot (4.38 kN/m). The secondary anchors shall be uniformly distributed along the uphill diaphragm edge and shall be spaced a maximum of four feet (1219 mm) on center.

1613.11.7.4.3 Design. Secondary anchors and diaphragm struts shall be designed in accordance with Section 1613.11.8.

1613.11.8 Primary and Secondary Anchorage and Diaphragm Strut Design. Primary and secondary anchors and diaphragm struts shall be designed in accordance with the following provisions:

1. Fasteners. All bolted fasteners used to develop connections to wood members shall be provided with square plate washers at all bolt heads and nuts. Washers shall be minimum

0.229 inch by 3 inches by 3 inches (5.82 mm by 76 mm by 76 mm) in size. Nuts shall be tightened to finger tight plus one half (1/2) wrench turn prior to covering the framing.

2. Fastening. The diaphragm to foundation anchorage shall not be accomplished by the use of toe nailing, nails subject to withdrawal, or wood in cross-grain bending or cross-grain tension.

3. Size of Wood Members. Wood diaphragm struts collectors, and other wood members connected to primary anchors shall not be less than three-inch (76 mm) nominal width. The effects of eccentricity on wood members shall be evaluated as required per Item 9.

4. Design. Primary and secondary anchorage, including diaphragm struts, splices, and collectors shall be designed for 125% of the tributary force.

5. Allowable Stress Increase. The one-third allowable stress increase permitted under Section 1605.3.2 shall not be taken when the working (allowable) stress design method is used.

6. Steel Element of Structural Wall anchorage System. The strength design forces for steel elements of the structural wall anchorage system, with the exception of anchor bolts and reinforcing steel, shall be increased by 1.4 times the forces otherwise required.

7. Primary Anchors. The load path for primary anchors and diaphragm struts shall be fully developed into the diaphragm and into the foundation. The foundation must be shown to be adequate to resist the concentrated loads from the primary anchors.

8. Secondary Anchors. The load path for secondary anchors and diaphragm struts shall be fully developed in the diaphragm but need not be developed beyond the connection to the foundation.

9. Symmetry. All lateral force foundation anchorage and diaphragm strut connections shall be symmetrical. Eccentric connections may be permitted when demonstrated by calculation or tests that all components of force have been provided for in the structural analysis or tests.

10. Wood Ledgers. Wood ledgers shall not be used to resist cross-grain bending or cross-grain tension.

1613.11.9 Lateral-Force-Resisting Elements Normal to the Downhill Direction.

1613.11.9.1 General. In the direction normal to the downhill direction, lateral-force-resisting elements shall be designed in accordance with the requirements of this section.

1613.11.9.2 Base Shear. In developing the base shear for seismic design, the response modification coefficient (R) shall not exceed 5 for bearing wall and building frame systems.

1613.11.9.3 Vertical Distribution of Seismic Forces. For seismic forces acting normal to the downhill direction the distribution of seismic forces over the height of the building using Section 12.8.3 of ASCE 7 shall be determined using the height measured from the top of the lowest level of the building foundation.

1613.11.9.4 Drift Limitations. The story drift below the base level diaphragm shall not exceed 0.007 times the story height at strength design force level. The total drift from the base level diaphragm to the top of the foundation shall not exceed 3/4 inch (19 mm). Where the story height or the height from the base level diaphragm to the top of the foundation varies because of a stepped footing or story offset, the height shall be measured from the average height of the top of the foundation. The story drift shall not be reduced by the effect of horizontal diaphragm stiffness.

1613.11.9.5 Distribution of Lateral Forces.

1613.11.9.5.1 General. The design lateral force shall be distributed to lateral-force-resisting elements of varying heights in accordance with the stiffness of each individual element.

1613.11.9.5.2 Wood Structural Panel Sheathed Walls. The stiffness of a stepped wood structural panel shear wall may be determined by dividing the wall into adjacent rectangular elements, subject to the same top of wall deflection. Deflections of shear walls may be estimated by AF&PA SDPWS Section 4.3.2. Sheathing and fastening requirements for the stiffest section shall be used for the entire wall. Each section of wall shall be anchored for shear and uplift at each step. The minimum horizontal length of a step shall be eight feet (2438 mm) and the maximum vertical height of a step shall be two feet, eight inches (813 mm).

1613.11.9.5.3 Reinforced Concrete or Masonry Shear Walls. Reinforced concrete or masonry shear walls shall have forces distributed in proportion to the rigidity of each section of the wall.

1613.11.9.6 Limitations. The following lateral force-resisting-elements shall not be designed to resist lateral forces below the base level diaphragm in the direction normal to the downhill direction:

1. Cement plaster and lath,
2. Gypsum wallboard, and
3. Tension-only braced frames.

Braced frames designed in accordance with the requirements of Section 2205.2.2 of this Code may be designed as lateral-force-resisting elements in the direction normal to the downhill direction, provided lateral forces do not induce flexural stresses in any member of the frame. Deflections of frames shall account for the variation in slope of diagonal members when the frame is not rectangular.

1613.11.10 Specific Design Provisions.

1613.11.10.1 Footings and Grade Beams. All footings and grade beams shall comply with the following:

1. Grade beams shall extend at least 12 inches (305 mm) below the lowest adjacent grade and provide a minimum 24-inch (610 mm) distance horizontally from the bottom outside face of the grade beam to the face of the descending slope.
2. Continuous footings shall be reinforced with at least two No. 4 reinforcing bars at the top and two No. 4 reinforcing bars at the bottom.
3. All main footing and grade beam reinforcement steel shall be bent into the intersecting footing and fully developed around each corner and intersection.
4. All concrete stem walls shall extend from the foundation and reinforced as required for concrete or masonry walls.

1613.11.10.2 Protection Against Decay and Termites. All wood to earth separation shall comply with the following:

1. Where a footing or grade beam extends across a descending slope, the stem wall, grade beam, or footing shall extend up to a minimum 18 inches (457 mm) above the highest adjacent grade.

Exception: At paved garage and doorway entrances to the building, the stem wall need only extend to the finished concrete slab, provided the wood framing is protected with a moisture proof barrier.

2. Wood ledgers supporting a vertical load of more than 100 pounds per lineal foot (1.46 kN/m) and located within 48 inches (1219 mm) of adjacent grade are prohibited. Galvanized steel ledgers and anchor bolts, with or without wood nailers, or treated or decay resistant sill plates supported on a concrete or masonry seat, may be used.

1613.11.10.3 Sill Plates. All sill plates and anchorage shall comply with the following:

1. All wood framed walls, including nonbearing walls, when resting on a footing, foundation, or grade beam stem wall, shall be supported on wood sill plates bearing on a level surface.
2. Power-driven fasteners shall not be used to anchor sill plates except at interior nonbearing walls not designed as shear walls.

1613.11.10.4 Column Base Plate Anchorage. The base of isolated wood posts (not framed into a stud wall) supporting a vertical load of 4,000 pounds (17.8 kN) or more and the base plate for a steel column shall comply with the following:

1. When the post or column is supported on a pedestal extending above the top of a footing or grade beam, the pedestal shall be designed and reinforced as required for concrete or masonry columns. The pedestal shall be reinforced with a minimum of four No. 4 bars extending to the bottom of the footing or grade beam. The top of exterior pedestals shall be sloped for positive drainage.

2. The base plate anchor bolts or the embedded portion of the post base, and the vertical reinforcing bars for the pedestal, shall be confined with two No. 4 or three No. 3 ties within the top five inches (127 mm) of the concrete or masonry pedestal. The base plate anchor bolts shall be embedded a minimum of 20 bolt diameters into the concrete or masonry pedestal. The base plate anchor bolts and post bases shall be galvanized and each anchor bolt shall have at least two galvanized nuts above the base plate.

1613.11.10.5 Steel Beam to Column Supports. All steel beam to column supports shall be positively braced in each direction. Steel beams shall have stiffener plates installed on each side of the beam web at the column. The stiffener plates shall be welded to each beam flange and the beam web. Each brace connection or structural member shall consist of at least two 5/8 inch (15.9 mm) diameter machine bolts.

- j) Section 1613.12 is added to Chapter 16 of the 2010 Edition of the California Building Code to read as follows:

1613.12 Suspended Ceilings. Minimum design and installation standards for suspended ceilings shall be determined in accordance with the requirements of Section 2506.2.1 of this Code and this subsection.

1613.12.1 Scope. This part contains special requirements for suspended ceilings and lighting systems. Provisions of Section 13.5.6 of ASCE 7 shall apply except as modified herein.

1613.12.2 General. The suspended ceilings and lighting systems shall be limited to 6 feet (1828 mm) below the structural deck unless the lateral bracing is designed by a licensed engineer or architect.

1613.12.3 Design and Installation Requirements.

1613.12.3.1 Bracing at Discontinuity. Positive bracing to the structure shall be provided at changes in the ceiling plane elevation or at discontinuities in the ceiling grid system.

1613.12.3.2 Support for Appendages. Cable trays, electrical conduits and piping shall be independently supported and independently braced from the structure.

1613.12.3.3 Sprinkler Heads. All sprinkler heads (drops) except fire-resistance-rated floor/ceiling or roof/ceiling assemblies, shall be designed to allow for free movement of the sprinkler pipes with oversize rings, sleeves or adaptors through the ceiling tile, in accordance with Section 13.5.6.2.2 (e) of ASCE 7.

Sprinkler heads penetrating fire-resistance-rated floor/ceiling or roof/ceiling assemblies shall comply with Section 713 of this Code.

1613.12.3.4 Perimeter Members. A minimum wall angle size of at least a two-inch (51 mm) horizontal leg shall be used at perimeter walls and interior full height partitions. The first ceiling tile shall maintain 3/4 inch (19 mm) clear from the finish wall surface. An equivalent alternative detail that will provide sufficient movement due to anticipated lateral building displacement may be used in lieu of the long leg angle subject to the approval of the Superintendent of Building.

1613.12.4 Special Requirements for Means of Egress. Suspended ceiling assemblies located along means of egress serving an occupant load of 30 or more shall comply with the following provisions.

1613.12.4.1 General. Ceiling suspension systems shall be connected and braced with vertical hangers attached directly to the structural deck along the means of egress serving an occupant load of 30 or more and at lobbies accessory to Group A Occupancies. Spacing of vertical hangers shall not exceed 2 feet (610 mm) on center along the entire length of the suspended ceiling assembly located along the means of egress or at the lobby.

1613.12.4.2 Assembly Device. All lay-in panels shall be secured to the suspension ceiling assembly with two hold-down clips minimum for each tile within a 4-foot (1219 mm) radius of the exit lights and exit signs.

1613.12.4.3 Emergency Systems. Independent supports and braces shall be provided for light fixtures required for exit illumination. Power supply for exit illumination shall comply with the requirements of Section 1006.3 of this Code.

1613.12.4.4 Supports for Appendage. Separate support from the structural deck shall be provided for all appendages such as light fixtures, air diffusers, exit signs, and similar elements.

- k) Section 1704.8 of the 2013 Edition of the California Building Code is amended to read as follows:

1704.8 Driven deep foundations and connection grade beams. Special inspections shall be performed during installation and testing of driven deep foundation elements as required by Table 1704.8. Special inspections shall be performed for connection grade beams in accordance with Section 1704.4 for structures assigned to Seismic Design Category D, E or F. The approved geotechnical report, and the construction documents prepared by the registered design professionals, shall be used to determine compliance.

- l) Section 1704.9 of the 2013 Edition of the California Building Code is amended to read as follows:

1704.9 Cast-in-place deep foundations and connection grade beams. Special inspections shall be performed during installation and testing of cast-in-place deep foundation elements as required by Table 1704.9. Special inspections shall be performed for connection grade beams in accordance with Section 1704.4 for structures assigned to Seismic Design Category D, E or F. The approved geotechnical report, and the construction documents prepared by the registered design professionals, shall be used to determine compliance.

- m) Section 1705.3 of the 2013 Edition of the California Building Code is amended to read as follows:

1705.3 Concrete Construction. The special inspections and verifications for concrete construction shall be as required by this section and Table 1704.4.

Exceptions: Special inspection shall not be required for:

1. Isolated spread concrete footings of buildings three stories or less above grade plane that are fully supported on earth or rock, where the structural design of the footing is based on a specified compressive strength, f'_c , no greater than 2,500 pounds per square inch (psi) (17.2 Mpa).

2. Continuous concrete footings supporting walls of buildings three stories or less in height that are fully supported on earth or rock where:

2.1. The footings support walls of light-frame construction;

2.2. The footings are designed in accordance with Table 1805.4.2; or

2.3. The structural design of the footing is based on a specified compressive strength, f'_c , no greater than 2,500 pounds per square inch (psi) (17.2 Mpa), regardless of the compressive strength specified in the construction documents or used in the footing construction.

3. Nonstructural concrete slabs supported directly on the ground, including prestressed slabs on grade, where the effective prestress in the concrete is less than 150 psi (1.03 Mpa).

~~4. Concrete foundation walls constructed in accordance with Table 1807.1.6.2.~~

~~54.~~ Concrete patios, driveways and sidewalks, on grade.

- n) Section 1704.5 of the 2013 Edition of the California Building Code is amended to read as follows:

1704.5 Structural Observations. Where required by the provisions of Section 1704.5.1 or 1704.5.2 the owner shall employ a ~~registered design professional~~ structural observer to perform structural observations as defined in Section 1702. The structural observer shall be one of the following individuals:

1. The registered design professional responsible for the structural design, or
2. A registered design professional designated by the registered design professional responsible for the structural design.

Prior to the commencement of observations, the structural observer shall submit to the building official a written statement identifying the frequency and extent of structural observations.

~~At the conclusion of the work included in the permit, the structural observer shall submit to the building official a written statement that the site visits have been made and identify any reported deficiencies that, to the best of the structural observer's knowledge, have not been resolved.~~

The owner or owner's representative shall coordinate and call a preconstruction meeting between the structural observer, contractors, affected subcontractors and special inspectors. The structural observer shall preside over the meeting. The purpose of the meeting shall be to identify the major structural elements and connections that affect the vertical and lateral load resisting systems of the structure and to review scheduling of the required observations. A record of the meeting shall be included in the report submitted to the building official.

Observed deficiencies shall be reported in writing to the owner or owner's representative, special inspector, contractor and the building official. Upon the form prescribed by the building official, the structural observer shall submit to the building official a written statement at each significant construction stage stating that the site visits have been made and identifying any reported deficiencies which, to the best of the structural observer's knowledge, have not been resolved. A final report by the structural observer which states that all observed deficiencies have been resolved is required before acceptance of the work by the building official.

- o) Section 1704.5.1 of the 2013 Edition of the California Building Code is amended to read as follows:

1704.5.1 Structural observations for seismic resistance. Structural observations shall be provided for those structures assigned to Seismic Design Category D, E or F, as determined in Section 1613, where one or more of the following conditions exist:

1. The structure is classified as Occupancy Category III or IV in accordance with Table 1604.5.

2. The height of the structure is greater than 75 feet (22860 mm) above the base.
3. The structure is ~~assigned to Seismic Design Category E,~~ is classified as Occupancy Category I or II in accordance with Table 1604.5, and ~~is greater than two stories one stories above grade plane~~ a lateral design is required for the structure or portion thereof.

Exception: One-story wood framed Group R-3 and Group U Occupancies less than 2,000 square feet in area, provided the adjacent grade is not steeper than 1 unit vertical in 10 units horizontal (10% sloped), assigned to Seismic Design Category D.

4. When so designated by the registered design professional responsible for the structural design.
 5. When such observation is specifically required by the building official.
- p) Section 1807.1.4 of the 2013 Edition of the California Building Code is amended to read as follows:

1807.1.4 Permanent wood foundation systems. Permanent wood foundation systems shall be designed and installed in accordance with AF&PA PWF. Lumber and plywood shall be treated in accordance with AWP A U1 (Commodity Specification A, Use Category 4B and Section 5.2) and shall be identified in accordance with Section 2303.1.8.1. Permanent wood foundation systems shall not be used for structures assigned to Seismic Design Category D, E or F.

- q) Section 1807.1.6 of the 2013 Edition of the California Building Code is amended to read as follows:

1807.1.6 Prescriptive design of concrete and masonry foundation walls. Concrete and masonry foundation walls that are laterally supported at the top and bottom shall be permitted to be designed and constructed in accordance with this section. Prescriptive design of foundation walls shall not be used for structures assigned to Seismic Design Category D, E or F.

- r) Section 1809.3 of the 2013 Edition of the California Building Code is amended to read as follows:

1809.3 Stepped footings. The top surface of footings shall be level. The bottom surface of footings shall be permitted to have a slope not exceeding one unit vertical in 10 units horizontal (10-percent slope). Footings shall be stepped where it is necessary to change the elevation of the top surface of the footing or where the surface of the ground slopes more than one unit vertical in 10 units horizontal (10-percent slope).

For structures assigned to Seismic Design Category D, E or F, the stepping requirement shall also apply to the top surface of grade beams supporting walls. Footings shall be reinforced with four 1/2-inch diameter (12.7 mm) deformed reinforcing bars. Two bars shall be placed at the top and bottom of the footings as shown in Figure 1809.3.

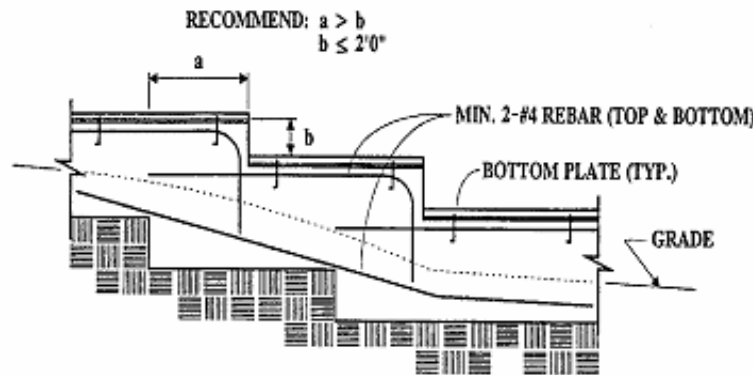

STEPPED FOUNDATIONS

**FIGURE 1809.3
STEPPED FOOTING**

- s) Section 1809.7 and Table 1809.7 of the 2013 Edition of the California Building Code is amended to read as follows:

1809.7 Prescriptive footings for light-frame construction. Where a specific design is not provided, concrete or masonry-unit footings supporting walls of light-frame construction shall be permitted to be designed in accordance with Table 1809.7. Prescriptive footings in Table 1809.7 shall not exceed one story above grade plane for structures assigned to Seismic Design Category D, E or F.

**TABLE 1809.7
PRESCRIPTIVE FOOTINGS SUPPORTING WALLS OF
LIGHT-FRAME CONSTRUCTION^{a, b, c, d, e}**

NUMBER OF FLOORS SUPPORTED BY THE FOOTING ^f	WIDTH OF FOOTING (inches)	THICKNESS OF FOOTING (inches)
1	12	6
2	15	6
3	18	8 ^g

For SI: 1 inch = 25.4 mm, 1 foot = 304.8 mm

- Depth of footings shall be in accordance with Section 1809.4.
- The ground under the floor shall be permitted to be excavated to the elevation of the top of the footing.

- c. ~~Interior stud bearing walls shall be permitted to be supported by isolated footings. The footing width and length shall be twice the width shown in this table, and footings shall be spaced not more than 6 feet on center. Not Adopted.~~
 - d. See Section 1908 for additional requirements for concrete footings of structures assigned to Seismic Design Category C, D, E or F.
 - e. For thickness of foundation walls, see Section 1807.1.6.
 - f. Footings shall be permitted to support a roof addition to the stipulated number of floors. Footings supporting roof only shall be as required for supporting one floor.
 - g. ~~Plain concrete footings for Group R-3 occupancies shall be permitted to be 6 inches thick.~~
- t) Section 1809.12 of the 2013 Edition of the California Building Code is amended to read as follows:

1809.12 Timber footings. Timber footings shall be permitted for buildings of Type V construction and as otherwise approved by the building official. Such footings shall be treated in accordance with AWP A U1 (Commodity Specification A, Use Category 4B). Treated timbers are not required where placed entirely below permanent water level, or where used as capping for wood piles that project above the water level over submerged or marsh lands. The compressive stresses perpendicular to grain in untreated timber footing supported upon treated piles shall not exceed 70 percent of the allowable stresses for the species and grade of timber as specified in the AF&PA NDS. Timber footings shall not be used in structures assigned to Seismic Design Category D, E or F.

- u) Section 1810.3.2.4 and of the 2013 Edition of the California Building Code is amended to read as follows:

1810.3.2.4 Timber. Timber deep foundation elements shall be designed as piles or poles in accordance with AF&PA NDS. Round timber elements shall conform to ASTM D 25. Sawn timber elements shall conform to DOC PS-20. Timber shall not be used in structures assigned to Seismic Design Category D, E or F.

- v) Section 1905.1 is amended to read as shown below and Sections 1905.1.11 through 1905.1.14 is added to Chapter 19 of the 2013 Edition of the California Building Code is amended to read as follows:

1905.1 General. The text of ACI 318 shall be modified as indicated in Sections 1908.1.1 through ~~1908.1.10~~1908.1.14.

1905.1.11 ACI 318, Section 21.6.4.1. Modify ACI 318, Section 21.6.4.1, to read as follows:

Where the calculated point of contra flexure is not within the middle half of the member clear height, provide transverse reinforcement as specified in ACI 318 Sections 21.6.4.1, Items (a) through (c), over the full height of the member.

1905.1.12 ACI 318, Section 21.6.4. Modify ACI 318, Section 21.6.4, by adding Section 21.6.4.8 to read as follows:

21.6.4.8 – At any section where the design strength, ϕP_n , of the column is less than the sum of the shears V_e computed in accordance with ACI 318 Sections 21.5.4.1 and 21.6.5.1 for all the beams framing into the column above the level under consideration, transverse reinforcement as specified in ACI 318 Sections 21.6.4.1 through 21.6.4.3 shall be provided. For beams framing into opposite sides of the column, the moment components may be assumed to be of opposite sign. For the determination of the design strength, ϕP_n , of the column, these moments may be assumed to result from the deformation of the frame in any one principal axis.

1905.1.13 ACI 318, Section 21.9.4. Modify ACI 318, Section 21.9.4, by adding Section 21.9.4.6 to read as follows:

21.9.4.6 – Walls and portions of walls with $P_u > 0.35P_o$ shall not be considered to contribute to the calculated strength of the structure for resisting earthquake-induced forces. Such walls shall conform to the requirements of ACI 318 Section 21.13.

1905.1.14 ACI 318, Section 21.11.6. Modify ACI 318, Section 21.11.6, by adding the following:

Collector and boundary elements in topping slabs placed over precast floor and roof elements shall not be less than 3 inches (76 mm) or $6 d_b$ thick, where d_b is the diameter of the largest reinforcement in the topping slab.

- w) Section 1905.1.2 of the 2013 Edition of the California Building Code is amended to read as follows:

1905.1.2 ACI 318, Section 21.1.1. Modify ACI 318, Sections 21.1.1.3 and 21.1.1.7 as follows:

21.1.1.3 – Structures assigned to Seismic Design Category A shall satisfy requirements of Chapters 1 to 19 and 22; Chapter 21 does not apply. Structures assigned to Seismic Design Category B, C, D, E or F also shall satisfy 21.1.1.4 through 21.1.1.8, as applicable. Except for structural elements of plain concrete complying with Section 1905.1.8 of the International Building Code, structural elements of plain concrete are prohibited in structures assigned to Seismic Design Category C, D, E or F.

21.1.1.7 – Structural systems designated as part of the seismic-force-resisting system shall be restricted to those permitted by ASCE 7. Except for Seismic Design Category A, for which Chapter 21 does not apply, the following provisions shall be satisfied for each structural system designated as part of the seismic-force-resisting system, regardless of the Seismic Design Category:

- (a) Ordinary moment frames shall satisfy 21.2.
- (b) Ordinary reinforced concrete structural walls and ordinary precast structural walls need not satisfy any provisions in Chapter 21.
- (c) Intermediate moment frames shall satisfy 21.3.
- (d) Intermediate precast structural walls shall satisfy 21.4.
- (e) Special moment frames shall satisfy 21.5 through 21.8.
- (f) Special structural walls shall satisfy 21.9.
- (g) Special structural walls constructed using precast concrete shall satisfy 21.10.

All special moment frames and special structural walls shall also satisfy 21.1.3 through 21.1.7. Concrete tilt-up wall panels classified as intermediate precast structural wall system shall satisfy 21.9 in addition to 21.4.2 and 21.4.3 for structures assigned to Seismic Design Category D, E or F.

- x) Section 1905.1.8 of the 2013 Edition of the California Building Code is amended to read as follows:

1905.1.8 ACI 318, Section 22.10. Delete ACI 318, Section 22.10, and replace with the following:

22.10 – Plain concrete in structures assigned to Seismic Design Category C, D, E or F.

22.10.1 – Structures assigned to Seismic Design Category C, D, E or F shall not have elements of structural plain concrete, except as follows:

(a) ~~Structural plain concrete basement, foundation or other walls below the base are permitted in detached one and two family dwellings three stories or less in height constructed with stud bearing walls. In dwellings assigned to Seismic Design Category D or E, the height of the wall shall not exceed 8 feet (2438 mm), the thickness shall not be less than 7½ inches (190 mm), and the wall shall retain no more than 4 feet (1219 mm) of unbalanced fill. Walls shall have reinforcement in accordance with 22.6.6.5. Concrete used for fill with a minimum cement content of two (2) sacks of Portland cement per cubic yard.~~

(b) Isolated footings of plain concrete supporting pedestals or columns are permitted, provided the projection of the footing beyond the face of the supported member does not exceed the footing thickness.

Exception: ~~In detached one and two family dwellings three stories or less in height, the projection of the footing beyond the face of the supported member is permitted to exceed the footing thickness.~~

(c) Plain concrete footings supporting walls are permitted provided the footings have at least two continuous longitudinal reinforcing bars. Bars shall not be smaller than No. 4 and shall have a total area of not less than 0.002 times the

gross cross-sectional area of the footing. ~~For footings that exceed 8 inches (203 mm) in thickness, a~~ minimum of one bar shall be provided at the top and bottom of the footing. Continuity of reinforcement shall be provided at corners and intersections.

Exceptions:

1. ~~—In detached one- and two-family dwellings three stories or less in height and constructed with stud-bearing walls, plain concrete footings without longitudinal reinforcement supporting walls are permitted with at least two continuous longitudinal reinforcing bars not smaller than No. 4 are permitted to have a total area of less than 0.002 times the gross cross-sectional area of the footing.~~

2. ~~—For foundation systems consisting of a plain concrete footing and a plain concrete stemwall, a minimum of one bar shall be provided at the top of the stemwall and at the bottom of the footing.~~

3. ~~—Where a slab on ground is cast monolithically with the footing, one No. 5 bar is permitted to be located at either the top of the slab or bottom of the footing.~~

- y) Section 1906.1 of the 2013 Edition of the California Building Code is amended to read as follows:

1906.1 Scope. The design and construction of structural plain concrete, both cast-in-place and precast, shall comply with the minimum requirements of ACI 318, as modified in Section 1905.

Exception: For Group R-3 occupancies and buildings or other occupancies less than two stories above grade plane of light-frame construction, the required edge thickness of ACI 318 is permitted to be reduced to 6 inches (152 mm), provided that the footing does not extend more than 4 inches (102 mm) on either side of the supported wall. This exception shall not apply to structural elements designed to resist seismic lateral forces for structures assigned to Seismic Design Category D, E or F.

- z) Section 2204.1.1 is added to Chapter 22 of the 2013 Edition of the California Building Code to read as follows:

2204.1.1 Consumables for welding.

2204.1.1.1 Seismic Force Resisting System (SFRS) welds. All welds used in members and connections in the SFRS shall be made with filler metals meeting the requirements specified in AWS D1.8 Clause 6.3. AWS D1.8 Clauses 6.3.5, 6.3.6, 6.3.7 and 6.3.8 shall apply only to demand critical welds.

2204.1.1.2 Demand critical welds. Where welds are designated as demand critical, they shall be made with filler metals meeting the requirements specified in AWS D1.8 Clause 6.3.

- aa) Section 2206.3 is added to Chapter 22 of the 2013 Edition of the California Building Code to read as follows:

2206.3 AISC 341, Part I, Section 13.2 Members. Add Section 13.2f to read as follows:

13.2f. Member Types

The use of rectangular HSS are not permitted for bracing members, unless filled solid with cement grout having a minimum compressive strength of 3,000 psi (20.7 MPa) at 28 days. The effects of composite action in the filled composite brace shall be considered in the sectional properties of the system where it results in the more severe loading condition or detailing.

- bb) Section 2304.11.7 of the 2013 Edition of the California Building Code is amended to read as follows:

2304.11.7 Wood used in retaining walls and cribs. Wood installed in retaining or crib walls shall be preservative treated in accordance with AWP A U1 (Commodity Specifications A or F) for soil and fresh water use. Wood shall not be used in retaining or crib walls for structures assigned to Seismic Design Category D, E or F.

- cc) Section 2305.4 is added to Chapter 23 of the 2013 Edition of the California Building Code to read as follows:

2305.4 Quality of Nails. In Seismic Design Category D, E or F, mechanically driven nails used in wood structural panel shear walls shall meet the same dimensions as that required for hand-driven nails, including diameter, minimum length and minimum head diameter. Clipped head or box nails are not permitted in new construction. The allowable design value for clipped head nails in existing construction may be taken at no more than the nail-head-area ratio of that of the same size hand-driven nails.

- dd) Section 2305.5 is added to Chapter 23 of the 2013 Edition of the California Building Code to read as follows:

2305.5 Hold-down connectors. In Seismic Design Category D, E or F, hold-down connectors shall be designed to resist shear wall overturning moments using approved cyclic load values or 75 percent of the allowable seismic load values that do not consider cyclic loading of the product. Connector bolts into wood framing shall require steel plate washers on the post on the opposite side of the anchorage device. Plate size shall be a minimum of 0.229 inch by 3 inches by 3 inches (5.82 mm by 76 mm by 76 mm) in size. Hold-down connectors shall be tightened to finger tight plus one half (1/2) wrench turn just prior to covering the wall framing.

ee) Tables 2306.2(3) and 2306.2(4) are added to Chapter 23 of the 2013 Edition of the California Building Code and Section 2306.2 of the 2013 Edition of the California Building Code is amended to read as follows:

2306.2 Wood-frame diaphragms. Wood-frame diaphragms shall be designed and constructed in accordance with AF&PA SDPWS. Where panels are fastened to framing members with staples, requirements and limitations of AF&PA SDPWS shall be met and the allowable shear values set forth in Table 2306(1) or 2306(2) shall be permitted. For structures assigned to Seismic Design Category D, E or F, the allowable shear capacities shall be set forth in Table 2306.2.1(3) or 2306.2.1(4). The allowable shear capacities in Table 2306.2.1(1) or 2306.2.1(2) are permitted to be increased 40 percent for wind design.

Wood structural panel diaphragms fastened with staples shall not be used to resist seismic forces in structures assigned to Seismic Design Category D, E or F.

Exception: Staples may be used for wood structural panel diaphragms when the allowable shear values are substantiated by cyclic testing and approved by the building official.

Wood structural panel diaphragms used to resist seismic forces in structures assigned to Seismic Design Category D, E or F shall be applied directly to the framing members.

Exception: Wood structural panel diaphragm is permitted to be fastened over solid lumber planking or laminated decking, provided the panel joints and lumber planking or laminated decking joints do not coincide.

TABLE 2306.2(3)
ALLOWABLE SHEAR (POUNDS PER FOOT) FOR WOOD STRUCTURAL PANEL DIAPHRAGMS WITH
FRAMING OF DOUGLAS FIR-LARCH OR SOUTHERN PINE^a FOR SEISMIC LOADING^f
FOR STRUCTURES ASSIGNED TO SEISMIC DESIGN CATEGORY D, E OR F

PANEL GRADE	COMMON NAIL SIZE	MINIMUM FASTENER PENETRATION IN FRAMING (inches)	MINIMUM NOMINAL PANEL THICKNESS (inch)	MINIMUM NOMINAL WIDTH OF FRAMING MEMBERS AT ADJOINING PANEL EDGES AND BOUNDARIES ^e (inches)	BLOCKED DIAPHRAGMS					UNBLOCKED DIAPHRAGMS	
					Fastener spacing (inches) at diaphragm boundaries (all cases) at continuous panel edges parallel to load (Cases 3,4), and at all panel edges (Cases 5, 6) ^b					Fastener spaced 6" max. at supported edges ^b	
					6	4	2 1/2 ^c	2 ^c		Case 1 (No unblocked edges or continuous joints parallel to load)	All other configurations (Cases 2, 3, 4, 5 and 6)
Structural I Grades	8d (2 1/2" x 0.131")	1 3/8	3/8	2	270	360	530	600	240	240	180
	10d ^d (3" x 0.148")	1 1/2	15/32	3	300	400	600	675	265	200	200
				2	320	425	640	730	285	215	215
				3	360	480	720	820	320	240	240
Sheathing, single floor and other grades covered in DOC PS1 and PS2	6d ^e (2" x 0.113")	1 1/4	3/8	2	185	250	375	420	165	125	125
	8d (2 1/2" x 0.131")	1 3/8		3	210	280	420	475	185	140	140
				2	240	320	480	545	215	160	160
	8d (2 1/2" x 0.131")	1 3/8	7/16	3	270	360	540	610	240	180	180
				2	255	340	505	575	230	170	170
				3	285	380	570	645	255	190	190
	8d (2 1/2" x 0.131")	1 3/8	15/32	2	270	360	530	600	240	180	180
				3	300	400	600	675	265	200	200
	10d ^d (3" x 0.148")	1 1/2		2	290	385	575	655	255	190	190
				3	324	430	650	735	290	215	215
	10d ^d (3" x 0.148")	1 1/2	19/32	2	320	425	640	730	285	215	215
				3	360	480	720	820	320	240	240

TABLE 2306.2(3)–continued
ALLOWABLE SHEAR (POUNDS PER FOOT) FOR WOOD STRUCTURAL
PANEL DIAPHRAGMS WITH FRAMING OF DOUGLAS FIR-LARCH,
OR SOUTHERN PINE^a FOR SEISMIC LOADING^f
FOR STRUCTURES ASSIGNED TO SEISMIC DESIGN CATEGORY D, E OR F

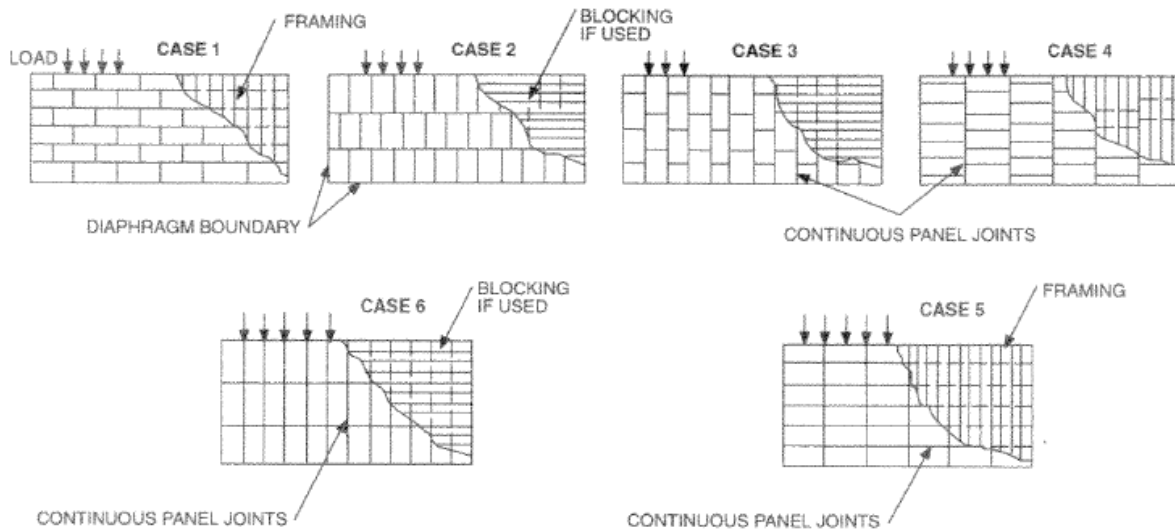

For SI: 1 inch = 25.4 mm, 1 pound per foot = 14.5939 N/m.

For framing of other species: (1) Find specific gravity for species of lumber in AF&PA NDS. (2)

For nails find shear value from table above for nail size for actual grade and multiply value by the following adjustment factor: Specific Gravity Adjustment Factor = $[1 - (0.5 - SG)]$, where SG = Specific Gravity of the framing lumber. This adjustment factor shall not be greater than 1.

Space fasteners maximum 12 inches o.c. along intermediate framing members (6 inches o.c. where supports are spaced 48 inches o.c.).

Framing at adjoining panel edges shall be 3 inches nominal or thicker, and nails at all panel edges shall be staggered where panel edge nailing is specified at 2 ½ inches o.c. or less.

Framing at adjoining panel edges shall be 3 inches nominal or thicker, and nails at all panel edges shall be staggered where both of the following conditions are met: (1) 10d nails having penetration into framing of more than 1 ½ inches and (2) panel edge nailing is specified at 3 inches o.c. or less.

The minimum nominal width of framing members not located at boundaries or adjoining panel edges shall be 2 inches.

For shear loads of normal or permanent load duration as defined by the AF&PA NDS, the values in the table above shall be multiplied by 0.63 or 0.56, respectively.

TABLE 2306.2(4)

**ALLOWABLE SHEAR (POUNDS PER FOOT) FOR WOOD STRUCTURAL PANEL
BLOCKED DIAPHRAGMS UTILIZING MULTIPLE ROWS OF FASTENERS (HIGH
LOAD DIAPHRAGMS) WITH FRAMING OF DOUGLAS FIR-LARCH OR SOUTHERN
PINE^a FOR SEISMIC LOADING^{b,f,g}
FOR STRUCTURES ASSIGNED TO SEISMIC DESIGN CATEGORY D, E OR F**

<u>PANEL GRADE^c</u>	<u>COMMON NAIL SIZE</u>	<u>MINIMUM FASTENER PENETRAT ION IN FRAMING (inches)</u>	<u>MINIMUM NOMINAL PANEL THICKNESS (inch)</u>	<u>MINIMUM NOMINAL WIDTH OF FRAMING MEMBERS AT ADJOINING PANEL EDGES AND BOUNDARIES^e (inches)</u>	<u>LINES OF FASTENER S</u>	<u>BLOCKED DIAPHRAGMS</u>			
						<u>Cases 1 and 2^d</u>			
						<u>Fastener Spacing Per Line at Boundaries (inches)</u>			
						<u>4</u>	<u>2 1/2</u>	<u>Fastener Spacing Per Line at Other Panel Edges (inches)</u>	
						<u>6</u>	<u>4</u>	<u>4</u>	<u>3</u>
<u>Structural I grades</u>	<u>10d common nails</u>	<u>1 1/2</u>	<u>15/32</u>	<u>3</u>	<u>2</u>	<u>605</u>	<u>815</u>	<u>875</u>	<u>1,150</u>
				<u>4</u>	<u>2</u>	<u>700</u>	<u>915</u>	<u>1,005</u>	<u>1,290</u>
				<u>4</u>	<u>3</u>	<u>875</u>	<u>1,220</u>	<u>1,285</u>	<u>1,395</u>
			<u>19/32</u>	<u>3</u>	<u>2</u>	<u>670</u>	<u>880</u>	<u>965</u>	<u>1,255</u>
				<u>4</u>	<u>2</u>	<u>780</u>	<u>990</u>	<u>1,110</u>	<u>1,440</u>
				<u>4</u>	<u>3</u>	<u>965</u>	<u>1,320</u>	<u>1,405</u>	<u>1,790</u>
			<u>23/32</u>	<u>3</u>	<u>2</u>	<u>730</u>	<u>955</u>	<u>1,050</u>	<u>1,365</u>
				<u>4</u>	<u>2</u>	<u>855</u>	<u>1,070</u>	<u>1,210</u>	<u>1,565</u>
				<u>4</u>	<u>3</u>	<u>1,050</u>	<u>1,430</u>	<u>1,525</u>	<u>1,800</u>
<u>Sheathing, single floor and other grades covered in DOC PS1 and PS2</u>	<u>10d common nails</u>	<u>1 1/2</u>	<u>15/32</u>	<u>3</u>	<u>2</u>	<u>525</u>	<u>725</u>	<u>765</u>	<u>1,010</u>
				<u>4</u>	<u>2</u>	<u>605</u>	<u>815</u>	<u>875</u>	<u>1,105</u>
				<u>4</u>	<u>3</u>	<u>765</u>	<u>1,085</u>	<u>1,130</u>	<u>1,195</u>
			<u>19/32</u>	<u>3</u>	<u>2</u>	<u>650</u>	<u>860</u>	<u>935</u>	<u>1,225</u>
				<u>4</u>	<u>2</u>	<u>755</u>	<u>965</u>	<u>1,080</u>	<u>1,370</u>
				<u>4</u>	<u>3</u>	<u>935</u>	<u>1,290</u>	<u>1,365</u>	<u>1,485</u>
			<u>23/32</u>	<u>3</u>	<u>2</u>	<u>710</u>	<u>935</u>	<u>1,020</u>	<u>1,335</u>
				<u>4</u>	<u>2</u>	<u>825</u>	<u>1,050</u>	<u>1,175</u>	<u>1,445</u>
				<u>4</u>	<u>3</u>	<u>1,020</u>	<u>1,400</u>	<u>1,480</u>	<u>1,565</u>

For SI: 1 inch = 25.4 mm, 1 pound per foot = 14.5939 N/m.

For framing of other species: (1) Find specific gravity for species of lumber in AF&PA NDS. (2)

For nails find shear value from table above for nail size for actual grade and multiply value by the following adjustment factor: Specific Gravity Adjustment Factor = $[1 - (0.5 - SG)]$, where SG = Specific Gravity of the framing lumber. This adjustment factor shall not be greater than 1.

Fastening along intermediate framing members: Space fasteners a maximum of 12 inches on center, except 6 inches on center for spans greater than 32 inches.

Panels conforming to PS1 or PS 2.

This table gives shear values for Cases 1 and 2 as shown in Table 2306.2(3). The values shown are applicable to Cases 3, 4, 5 and 6 as shown in Table 2306.2(3), providing fasteners at all continuous panels edges are spaced in accordance with the boundary fastener spacing. The minimum nominal depth of framing members shall be 3 inches nominal. The minimum nominal width of framing members not located at boundaries or adjoining panel edges shall be 2 inches.

High load diaphragms shall be subject to special inspection in accordance with Section 1704.6.1. For shear loads of normal or permanent load duration as defined by the AF&PA NDS, the values in the table above shall be multiplied by 0.63 or 0.56, respectively.

- ff) Table 2306.3(4) is added to Chapter 23 of the 2013 Edition of the California Building Code and Section 2306.3 and Table 2306.3 of the 2013 Edition of the California Building Code are amended to read as follows:

2306.3 Wood-frame shear walls. Wood-frame shear walls shall be designed and constructed in accordance with AF&PA SDPWS. Where panels are fastened to framing members with staples, requirements and limitations of AF&PA SDPWS shall be met and the allowable shear values set forth in Table 2306.3(1), 2306.3(2), 2306.3(3) or 2306.3(4) shall be permitted. The allowable shear values in Tables 2306.3(1), 2306.3(2) and 2306.3(4) are permitted to be increased 40 percent for wind design. Panels complying with ANSI/APA PRP-210 shall be permitted to use design values for Plywood Siding in the AF&PA SDPWS. For structures assigned to Seismic Design Category D, E or F, the allowable shear capacities shall be set forth in Table 2306.3(4).

Wood-frame shear walls used to resist seismic forces in structures assigned to Seismic Design Category D, E or F shall not be less than 4 feet by 8 feet (1219 mm by 2438 mm), except at boundaries and at changes in framing. Wood structural panel thickness for shear walls shall not be less than 3/8 inch thick and studs shall not be spaced at more than 16 inches on center.

The maximum allowable shear value for three-ply plywood resisting seismic forces in structures assigned to Seismic Design Category D, E or F is 200 pounds per foot (2.92 kN/m). Nails shall be placed not less than 1/2 inch (12.7 mm) in from the panel edges and not less than 3/8 inch (9.5mm) from the edge of the connecting members for shear greater than 350 pounds per foot (5.11kN/m). Nails shall be placed not less than 3/8 inch (9.5 mm) from panel edges and not less than 1/4 inch (6.4 mm) from the edge of the connecting members for shears of 350 pounds per foot (5.11kN/m) or less.

Wood-frame shear walls fastened with staples shall not used to resist seismic forces in structures assigned to Seismic Design Category D, E or F.

Exception: Staples may be used for wood-frame shear walls when the allowable shear values are substantiated by cyclic testing and approved by the building official.

Wood-frame shear walls used to resist seismic forces in structures assigned to Seismic Design Category D, E or F shall be applied directly to the framing members.

TABLE 2306.3(4)
ALLOWABLE SHEAR (POUNDS PER FOOT) FOR WOOD STRUCTURAL PANEL
SHEAR WALLS WITH
FRAMING OF DOUGLAS FIR-LARCH OR SOUTHERN PINE^a FOR SEISMIC
LOADING^{b, h, j, k, l}
FOR STRUCTURES ASSIGNED TO SEISMIC DESIGN CATEGORY D, E OR F

PANEL GRADE	MINIMUM NOMINAL PANEL THICKNESS (inch)	MINIMUM FASTENER PENETRATION IN FRAMING (inches)	ALLOWABLE SHEAR VALUE FOR SEISMIC FORCES PANELS APPLIED DIRECTLY TO FRAMING				
			COMMON NAIL SIZE	Fastener spacing at panel edges (inches)			
				6	4	3	2 ^e
Structural I sheathing	3/8	1 3/8	8d (2½"x0.131" common)	200	200	200	200
	7/16	1 3/8	8d (2½"x0.131" common)	255	395	505	670
	15/32	1 3/8	8d (2½"x0.131" common)	280	430	550	730
		1 1/2	10d (3"x0.148" common)	340	510	665 ^f	870
Sheathing, plywood siding ^g except Group 5 Species ANSI/APA PRP 210 siding	3/8 ^c	1 3/8	8d (2½"x0.113")	160	200	200	200

For SI: 1 inch = 25.4 mm, 1 foot = 25.4 mm, 1 pound per foot = 14.5939 N/m.

- a. For framing of other species: (1) Find specific gravity for species of lumber in AF&PA NDS. (2) For nails find shear value from table above for nail size for actual grade and multiply value by the following adjustment factor: Specific Gravity Adjustment Factor = [1-(0.5-SG)], where SG = Specific Gravity of the framing lumber. This adjustment factor shall not be greater than 1.
- b. Panel edges backed with 2-inch nominal or thicker framing. Install panels either horizontally or vertically. Space fasteners maximum 6 inches on center along intermediate framing members for 3/8-inch and 7/16-inch panels installed on studs spaced 24 inches on center. For other conditions and panel thickness, space fasteners maximum 12 inches on center on intermediate supports.
- c. 3/8-inch panel thickness or siding with a span rating of 16 inches on center is the minimum recommended where applied direct to framing as exterior siding. For grooved panel siding, the nominal panel thickness is the thickness of the panel measured at the point of nailing.

- d. Allowable shear values are permitted to be increased to values shown for 15/32-inch sheathing with same nailing provided (a) studs are spaced a maximum of 16 inches on center, or (b) panels are applied with long dimension across studs.
- e. Framing at adjoining panel edges shall be 3 inches nominal or thicker, and nails shall be staggered where nails are spaced 2 inches on center or less.
- f. Framing at adjoining panel edges shall be 3 inches nominal or thicker, and nails shall be staggered where both of the following conditions are met: (1) 10d (3"x0.148") nails having penetration into framing of more than 1-1/2 inches and (2) nails are spaced 3 inches on center or less.
- g. Values apply to all-veneer plywood. Thickness at point of fastening on panel edges governs shear values.
- h. Where panels applied on both faces of a wall and nail spacing is less than 6 inches o.c. on either side, panel joints shall be offset to fall on different framing members. Or framing shall be 3-inch nominal or thicker at adjoining panel edges and nails at all panel edges shall be staggered.
- i. Where shear design values exceed 350 pounds per linear foot, all framing members receiving edge nailing from abutting panels shall not be less than a single 3-inch nominal member, or two 2-inch nominal members fastened together in accordance with Section 2306.1 to transfer the design shear value between framing members. Wood structural panel joint and sill plate nailing shall be staggered at all panel edges. See Section 4.3.6.1 and 4.3.6.4.3 of AF&PA SDPWS for sill plate size and anchorage requirements.
- j. Galvanized nails shall be hot dipped or tumbled.
- k. For shear loads of normal or permanent load duration as defined by the AF&PA NDS, the values in the table above shall be multiplied by 0.63 or 0.56, respectively.
- l. The maximum allowable shear value for three-ply plywood resisting seismic forces is 200 pounds per foot (2.92 kn/m).

gg) Section 2306.4 is added to Chapter 23 of the 2013 Edition of the California Building Code to read as follows:

2306.4 Wood-frame shear walls sheathed with other materials. Shear walls sheathed with portland cement plaster, gypsum lath, gypsum sheathing or gypsum board shall be designed and constructed in accordance with AF&PA SDPWS. Shear walls sheathed with these materials are permitted to resist horizontal forces using the allowable shear capacities set forth in Table 2306.7. Shear walls sheathed with portland cement plaster, gypsum lath, gypsum sheathing or gypsum board shall not be used to resist seismic forces in structures assigned to Seismic Design Category E or F.

Shear walls sheathed with lath, plaster or gypsum board shall not be used below the top level in a multi-level building for structures assigned to Seismic Design Category D.

hh) Section 2308.3.4 of Chapter 23 of the 2013 Edition of the California Building Code is amended to read as follows:

2308.3.4 Braced wall line support. Braced wall lines shall be supported by continuous foundations.

Exception: For structures with a maximum plan dimension not over 50 feet (15240 mm), continuous foundations are required at exterior walls only for structures not assigned to Seismic Design Category D, E or F.

- ii) Section 2308.12.2 of Chapter 23 of the 2013 Edition of the California Building Code is amended to read as follows:

2308.12.2 Concrete or masonry. Concrete or masonry walls and stone or masonry veneer shall not extend above the basement.

Exception: Stone and masonry veneer is permitted to be used in the first story above grade plane in Seismic Design Category D, provided the following criteria are met:

1. Type of brace in accordance with Section 2308.9.3 shall be Method 3 and the allowable shear capacity in accordance with Table 2306.4.1 shall be a minimum of 350 plf (5108 N/m).
2. The bracing of the first story shall be located at each end and at least every 25 feet (7620 mm) o.c. but not less than 45 percent of the braced wall line.
3. Hold-down connectors shall be provided at the ends of braced walls for the first floor to foundation with an allowable design of 2,100 pounds (9341 N).
4. Cripple walls shall not be permitted.
5. Anchored masonry and stone wall veneer shall not exceed 5 inches (127 mm) in thickness, shall conform to the requirements of Chapter 14 and shall not extend more than 5 feet (1524 mm) above the first story finished floor.

- jj) Section 2308.12.4 and Table 2308.12.4 of the 2013 Edition of the California Building Code are amended to read as follows:

2308.12.4 Braced wall line sheathing. Braced wall lines shall be braced by one of the types of sheathing prescribed by Table 2308.12.4 as shown in Figure 2308.9.3. The sum of lengths of braced wall panels at each braced wall line shall conform to the required percentage of wall length required to be braced per braced wall line in Table 2308.12.4. Braced wall panels shall be distributed along the length of the braced wall line and start at not more than 8 feet (2438 mm) from each end of the braced wall line. Panel sheathing joints shall occur over studs or blocking. Sheathing shall be fastened to studs, top and bottom plates and at panel edges occurring over blocking. Wall framing to which sheathing used for bracing is applied shall be nominal 2 inch wide [actual 1½ inch (38 mm)] or larger members and spaced a maximum of 16 inches on center.

Exception: Braced wall panels required by Section 2308.12.4 may be eliminated when all of the following requirements are met:

1. One story detached Group U occupancies not more than 25 feet in depth or length.

2. The roof and three enclosing walls are solid sheathed with 15/32 inch nominal thickness wood structural panels with 8d common nails placed 3/8 inches from panel edges and spaced not more than 6 inches on center along all panel edges and 12 inches on center along intermediate framing members. Wall openings for doors or windows are permitted provided a minimum 4 foot wide wood structural braced panel with minimum height to length ratio of 2 to 1 is provided at each end of the wall line and that the wall line be sheathed for 50% of its length.

Wood structural panel sheathing shall be a minimum of 15/32 inch thick nailed with 8d common placed 3/8 inches from panel edges and spaced not more than 6 inches on center and 12 inches on center along intermediate framing members.

~~Cripple walls having a stud height exceeding 14 inches (356 mm) shall be considered a story for the purpose of this section and shall be braced as required for braced wall lines in accordance with Table 2309.12.4. Where interior braced wall lines occur without a continuous foundation below, the length of parallel exterior cripple wall bracing shall be one and one-half times the lengths required by Table 2308.12.4. Where the cripple wall sheathing type used is Type S-W and this additional length of bracing cannot be provided, the capacity of Type S-W sheathing shall be increased by reducing the spacing of fasteners along the perimeter of each piece of sheathing to 4 inches (102 mm) o.c.~~

Braced wall panel construction types shall not be mixed within a braced wall line.

TABLE 2308.12.4
WALL BRACING IN SEISMIC DESIGN CATEGORIES D AND E
(Minimum Length of Wall Bracing per each 25 Linear Feet of Braced Wall Line ^{a)})

CONDITIO N	SHEATHING TYPE ^b	$S_{DS} < 0.50$	$0.50 \leq S_{DS} < 0.75$	$0.75 \leq S_{DS} \leq 1.00$	$S_{DS} > 1.00$
One Story	G-P ^c	10 feet 8 inches	14 feet 8 inches	18 feet 8 inches	25 feet 0 inches
	S-W ^d	5 feet 4 inches	8 feet 0 inches	9 feet 4 inches	12 feet 0 inches

For SI: 1 inch = 25.4 mm, 1 foot = 304.8 mm.

- a. Minimum length of panel bracing of one face of the wall for S-W sheathing shall be at least 4'-0" long or both faces of the wall for G-P sheathing shall be at least 8'-0" long; h/w ratio shall not exceed 2:1. For S-W panel bracing of the same material on two faces of the wall, the minimum length is permitted to be one-half the tabulated value but the h/w ratio shall not exceed 2:1 and design for uplift is required.
- b. G-P = gypsum board, ~~fiberboard, particleboard, lath and portland cement plaster~~ or gypsum sheathing boards; S-W = wood structural panels ~~and diagonal wood sheathing~~.

- c. Nailing as specified below shall occur at all panel edges at studs, at top and bottom plates and, where occurring, at blocking:
 For 1/2-inch gypsum board, 5d (0.113 inch diameter) cooler nails at 7 inches on center;
 For 5/8-inch gypsum board, No 11 gage (0.120 inch diameter) cooler nails at 7 inches on center;
 For gypsum sheathing board, 1-3/4 inches long by 7/16-inch head, diamond point galvanized nails at 4 inches on center;
 For gypsum lath, No. 13 gage (0.092 inch) by 1-1/8 inches long, 19/64-inch head, plasterboard at 5 inches on center;
 For Portland cement plaster, No. 11 gage (0.120 inch) by 1 1/2 inches long, 7/16-inch head at 6 inches on center;
~~For fiberboard and particleboard, No. 11 gage (0.120 inch) by 1 1/2 inches long, 7/16-inch head, galvanized nails at 3 inches on center.~~
- d. S-W sheathing shall be a minimum of 15/32" thick nailed with 8d common placed 3/8 inches from panel edges and spaced not more than 6 inches on center and 12 inches on center along intermediate framing members.

kk) Section 2304.9.1 and Table 2304.9.1 of the 2013 Edition of the California Building Code are amended to read as follows:

2304.9.1 Fastener requirements. Connections for wood members shall be designed in accordance with the appropriate methodology in Section 2301.2. The number and size of fasteners connecting wood members shall not be less than that set forth in Table 2304.9.1. Staple fasteners in Table 2304.9.1 shall not be used to resist or transfer seismic forces in structures assigned to Seismic Design Category D, E or F.

Exception: Staples may be used to resist or transfer seismic forces when the allowable shear values are substantiated by cyclic testing and approved by the building official.

Add new footnote q to Table 2304.9.1.

- q. Staples shall not be used to resist or transfer seismic forces in structures assigned to Seismic Design Category D, E or F.

ll) Section 2308.12.5 of the 2013 Edition of the California Building Code is amended to read as follows:

2308.12.5 Attachment of sheathing. Fastening of braced wall panel sheathing shall not be less than that prescribed in Table 2308.12.4 or 2304.9.1. Wall sheathing shall not be attached to framing members by adhesives. Staple fasteners in Table 2304.9.1 shall not be used to resist or transfer seismic forces in structures assigned to Seismic Design Category D, E or F.

Exception: Staples may be used to resist or transfer seismic forces when the allowable shear values are substantiated by cyclic testing and approved by the building official.

All braced wall panels shall extend to the roof sheathing and shall be attached to parallel roof rafters or blocking above with framing clips (18 gauge minimum) spaced at maximum 24 inches (6096 mm) on center with four 8d nails per leg (total eight 8d nails per clip). Braced wall panels shall be laterally braced at each top corner and at maximum 24 inches (6096 mm) intervals along the top plate of discontinuous vertical framing.

mm) Section 3109.4.4 of the 2013 Edition of the California Building Code is amended to clarify that pool barriers which are already in the Code are scoped so as to apply on all private swimming pools and is to read as follows:

Amend 3109.4.4.1 by adding the following definition:

PRIVATE POOL, is any constructed pool, permanent or portable, and over 18 inches deep which is intended for non-commercial use as swimming pool by not more than three owner families and their guests.

(c) Amendments to the 2013 California Residential Code.

a) Section R301.1.3.2 of the 2013 Edition of the California Residential Code is amended to read as follows:

R301.1.3.2 Wood frame structures ~~greater than two stories~~. The building official shall require construction documents to be approved and stamped by a California licensed architect or engineer for all dwellings of wood frame construction more than two stories and basement in height located in Seismic Design Category A, B or C. Notwithstanding other sections the law, the law establishing these provisions is found in Business and Professions Code Section 5537 and 6737.1.

The building official shall require construction documents to be approved and stamped by a California licensed architect or engineer for all dwellings of wood frame construction more than one story in height or with a basement located in Seismic Design Category D₀, D₁, D₂ or E.

b) Section R301.1.4 is added to Chapter 3 of the 2013 Edition of the California Residential Code to read as follows:

R301.1.4 Seismic design provisions for buildings constructed on or into slopes steeper than one unit vertical in three units horizontal (33.3 percent slope). The design and construction of new buildings and additions to existing buildings when constructed on or into slopes steeper than one unit vertical in three units horizontal (33.3 percent slope) shall comply with Section 1613.12 of the California Building Code.

- c) Section R301.2.2.2.5 of the 2013 Edition of the California Residential Code is amended to read as follows:

1. When exterior shear wall lines or braced wall panels are not in one plane vertically from the foundation to the uppermost story in which they are required.

Exception: For wood light-frame construction, floors with cantilevers or setbacks not exceeding four times the nominal depth of the wood floor joists are permitted to support braced wall panels that are out of plane with braced wall panels below provided that:

1. Floor joists are nominal 2 inches by 10 inches (51 mm by 254 mm) or larger and spaced not more than 16 inches (406 mm) on center.
2. The ratio of the back span to the cantilever is at least 2 to 1.
3. Floor joists at ends of braced wall panels are doubled.
4. For wood frame construction, a continuous rim joist is connected at ends to all cantilever joists. When spliced, the rim joists shall be spliced using a galvanized metal tie not less than 0.058 inch (1.5 mm) (16 gage) and 1 1/2 inches (38 mm) wide fastened with six 16d nails on each side of the splice or a block of the same size as the rim joist of sufficient length to fit securely between the joist space at which the splice occurs fastened with eight 16d nails on each side of the splice; and
5. Gravity loads carried at the end of cantilevered joists are limited to uniform wall and roof loads and the reactions from headers having a span of 18 feet (2438 mm) or less.

3. When the end of a braced wall panel occurs over an opening in the wall below and ends at a horizontal distance greater than 1 foot (305 mm) from the edge of the opening. This provision is applicable to shear walls and braced wall panels offset in plane and to braced wall panels offset out of plane as permitted by the exception to item 1 above.

Exception: For wood light-frame wall construction, one end of a braced wall panel shall be permitted to extend more than one foot (305 mm) over an opening not more than 8 feet (2438 mm) wide in the wall below provided that the opening includes a header in accordance with the following:

1. The building width, loading condition and framing member species limitations of Table R502.5(1) shall apply; and
2. Not less than one 2x12 or two 2x10 for an opening not more than 4 feet (1219 mm) wide; or
3. Not less than two 2x12 or three 2x10 for an opening not more than 6 feet (1829 mm) wide; or
4. Not less than three 2x12 or four 2x10 for an opening not more than 8 feet (2438 mm) wide; and
5. The entire length of the braced wall panel does not occur over an opening in the wall below.

5. When portions of a floor level are vertically offset.

Exceptions:

- ~~1. Framing supported directly by continuous foundations at the perimeter of the building.~~
- ~~2. For wood light frame construction, floors shall be permitted to be vertically offset when the floor framing is lapped or tied together as required by section R502.6.1.~~

- d) Section R301.2.2.3.5.1 is added to Section 301.2.2.3.5 of the 2013 Edition of the California Residential Code as follows:

R301.2.2.3.5.1 AISI S230, Section B1. Modify AISI S230, Section B1 to read as follows:

Where No. 8 screws are specified, the required number of screws in a steel-to-steel connection shall be permitted to be reduced in accordance with the reduction factors in Table B1-1 when larger screws are used or when ~~one of~~ the sheets of steel being connected is thicker than 33 mils (0.84mm). When applying the reduction factor, the resulting number of screws shall be rounded up.

- e) Section R322.1.4.1 of the 2013 Edition of the California Residential Code is amended to read as follows:

R322.1.4.1 Determination of design flood elevations. If design flood elevations are not specified, the building official is authorized to require the applicant to:

1. Obtain and reasonably use data available from a federal, state or other source; or
2. Determine the design flood elevation in accordance with accepted hydrologic and hydraulic undertaken by a registered ~~design professional~~ civil engineer who shall determine that the technical methods used reflect currently accepted engineering practice. Studies, analyses and computations shall be submitted insufficient detail to allow thorough review and approval.

- f) Section R401.1 of the 2013 Edition of the California Residential Code is amended to read as follows:

R401.1 Application. The provisions of this chapter shall control the design and construction of the foundation and foundation spaces for all buildings. In addition to the provisions of this chapter, the design and construction of foundations in areas prone to flooding as established by Table R301.2(1) shall meet the provisions of Section R322. Wood foundations shall be designed and installed in accordance with AF&PA PWF.

Exception: The provisions of this chapter shall be permitted to be used for wood foundations only in the following situations:

1. In buildings that have no more than two floors and a roof.

2. When interior basement and foundation walls are constructed at intervals not exceeding 50 feet (15 240 mm).

Wood foundations in Seismic Design Category D₀, D₁ or D₂ shall ~~be designed in accordance with accepted engineering practice~~ not be permitted.

Exception: In non-occupied, single-story, detached storage sheds and similar uses other than carport or garage, provided the gross floor area does not exceed 200 square feet, the plate height does not exceed 12 feet in height above the grade plane at any point, and the maximum roof projection does not exceed 24 inches.

- g) Sections R403.1.2, R403.1.3, R403.1.5 of the 2013 Edition of the California Residential Code are amended to read as follows:

R403.1.2 Continuous footing in Seismic Design Categories D₀, D₁ and D₂. The braced wall panels at exterior walls of buildings located in Seismic Design Categories D₀, D₁ and D₂ shall be supported by continuous footings. All required interior braced wall panels in buildings ~~with plan dimensions greater than 50 feet (15240 mm)~~ shall ~~also~~ be supported by continuous footings.

R403.1.3 Seismic reinforcing. Concrete footings located in Seismic Design Categories D₀, D₁ and D₂, as established in Table R301.2(1), shall have minimum reinforcement. Bottom reinforcement shall be located a minimum of 3 inches (76 mm) clear from the bottom of the footing.

In Seismic Design Categories D₀, D₁ and D₂ where construction joint is created between a concrete footing and a stem wall, a minimum of one No. 4 bar shall be installed at not more than 4 feet (1219 mm) on center. The vertical bar shall extend to 3 inches (76 mm) clear of the bottom of the footing, have a standard hook and extend a minimum of 14 inches (357 mm) into the stem wall.

In Seismic Design Categories D₀, D₁ and D₂ where a grouted masonry stem wall is supported on a concrete footing and stem wall, a minimum of one No. 4 bar shall be installed at not more than 4 feet (1219 mm) on center. The vertical bar shall extend to 3 inches (76 mm) clear of the bottom of the footing and have a standard hook.

In Seismic Design Categories D₀, D₁ and D₂ masonry stem walls without solid grout and vertical reinforcing are not permitted.

Exception: In detached one- and two-family dwellings located in Seismic Design Category A, B or C which are three stories or less in height and constructed with stud bearing walls, plain concrete footings without longitudinal reinforcement supporting walls and isolated plain concrete footings supporting columns or pedestals are permitted.

R403.1.5 Slope. The top surface of footings shall be level. The bottom surface of footings shall be permitted to have a slope not exceeding one unit vertical in 10 units horizontal (10-percent slope). Footings shall be stepped where it is necessary to change the elevation of the top surface of the footing or where the surface of the ground slopes more than one unit vertical in 10 units horizontal (10-percent slope).

For structures located in Seismic Design Categories D₀, D₁ or D₂, stepped footings shall be reinforced with four 1/2-inch diameter (12.7 mm) deformed reinforcing bars. Two bars shall be placed at the top and bottom of the footings as shown in Figure R403.1.5.

**FIGURE R403.1.5
STEPPED FOOTING**

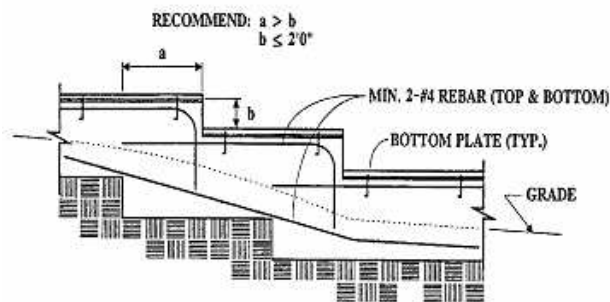

STEPPED FOUNDATIONS

- h) Table R301.2(1) of the 2013 Edition of the California Residential Code is revised to read:

TABLE R301.2(1) CLIMATIC AND GEOGRAPHIC DESIGN CRITERIA

Ground Snow Load	WIND DESIGN		Seismic Design Category ^f	SUBJECT TO DAMAGE FROM			Winter Design Temp ^e	Ice Barrier Under- layment Required ^h	Flood Hazards ^g	Air Freezing Index ⁱ	Mean Annual Temp ^j
	Speed ^d (mph)	Topographic Effects ^k		Weathering ^a	Frost line Depth ^b	Termite ^c					
Zero	85	No	D2 or E	Negligible	12-24"	Very Heavy	43	No	None	0	60

For SI: 1 pound per square foot = 0.0479 kPa, 1 mile per hour = 0.447 m/s.

- a) Weathering may require a higher strength concrete or grade of masonry than necessary to satisfy the structural requirements of this code. The weathering column shall be filled in with the weathering index (i.e., "negligible," "moderate" or "severe") for concrete as determined from the Weathering Probability Map [Figure R301.2(3)]. The grade of masonry units shall be determined from ASTM C 34, C 55, C 62, C 73, C 90, C 129, C 145, C 216 or C 652.

- b) The frost line depth may require deeper footings than indicated in Figure R403.1(1). The jurisdiction shall fill in the frost line depth column with the minimum depth of footing below finish grade.
- c) The jurisdiction shall fill in this part of the table to indicate the need for protection depending on whether there has been a history of local subterranean termite damage.
- d) The jurisdiction shall fill in this part of the table with the wind speed from the basic wind speed map [Figure R301.2(4)]. Wind exposure category shall be determined on a site-specific basis in accordance with Section R301.2.1.4.
- e) Temperatures shall be permitted to reflect local climates or local weather experience as determined by the building official.
- f) The jurisdiction shall fill in this part of the table with the seismic design category determined from Section R301.2.2.1.
- g) The jurisdiction shall fill in this part of the table with (a) the date of the jurisdiction's entry into the National Flood Insurance Program (date of adoption of the first code or ordinance for management of flood hazard areas), (b) the date(s) of the Flood Insurance Study and (c) the panel numbers and dates of all currently effective FIRMs and FBFMs or other flood hazard map adopted by the authority having jurisdiction, as amended.
- h) In accordance with Sections R905.2.7.1, R905.4.3.1, R905.5.3.1, R905.6.3.1, R905.7.3.1 and R905.8.3.1, where there has been a history of local damage from the effects of ice damming, the jurisdiction shall fill in this part of the table with "YES." Otherwise, the jurisdiction shall fill in this part of the table with "NO."
- i) The jurisdiction shall fill in this part of the table with the 100-year return period air freezing index (BF days) from Figure R403.3(2) or from the 100-year (99%) value on the National Climatic Data Center data table "Air Freezing Index-USA Method (Base 32°)" at www.ncdc.noaa.gov/fpsf.html.
- j) The jurisdiction shall fill in this part of the table with the mean annual temperature from the National Climatic Data Center data table "Air Freezing Index-USA Method (Base 32° F)" at www.ncdc.noaa.gov/fpsf.html.
- k) In accordance with Section R301.2.1.5, where there is local historical data documenting structural damage to buildings due to topographic wind speed-up effects, the jurisdiction shall fill in this part of the table with "YES." Otherwise, the jurisdiction shall indicate "NO" in this part of the table.
- i) Section R403.1.3 of the 2013 Edition of the California Residential Code is modified by deleting the exception for masonry stem walls:

In Seismic Design Categories D0, D1 and D2 masonry stem walls without solid grout and vertical reinforcing are not permitted.

~~**Exception:** In detached one and two family dwellings which are three stories or less in height and constructed with stud bearing walls, plain concrete footings without longitudinal reinforcement supporting walls and isolated plain concrete footings supporting columns or pedestals are permitted.~~

- j) Section R404.2 of the 2013 Edition of the California Residential Code is amended to read as follows:

R404.2 Wood foundation walls. Wood foundation walls shall be constructed in accordance with the provisions of Sections R404.2.1 through R404.2.6 and with the details shown in Figures R403.1(2) and R403.2(3). Wood foundation walls shall not be used for structures located in Seismic Design Category D₀, D₁ or D₂.

- k) Section R405.1 of the 2013 Edition of the California Residential Code shall be modified to read as follows:

.....at least one sieve size larger than the tile joint opening or perforation and covered with not less than 6 inches of the same material.

~~**Exception:** A drainage system is not required with the foundation is installed on well drained ground or sand gravel mixture soils according to the Unified Soil Classification System, Group 1 Soils, as detailed in Table R405.1.~~

- l) Section R501.1 of the 2013 Edition of the California Residential Code is amended to read as follows:

- m) **R501.1 Application.** The provision of this chapter shall control the design and construction of the floors for all buildings including the floors of attic spaces used to house mechanical or plumbing fixtures and equipment weighing less than 400 lbs and maximum height of 4 feet above the floor or attic level.

- n) Section R503.2.4 is added to Chapter 5 of the 2013 Edition of the California Residential Code to read as follows:

R503.2.4 Openings in horizontal diaphragms. Openings in horizontal diaphragms with a dimension perpendicular to the joist that is greater than 4 feet (1.2 m) shall be constructed in accordance with Figure R503.2.4.

FIGURE R503.2.4
OPENINGS IN HORIZONTAL DIAPHRAGMS

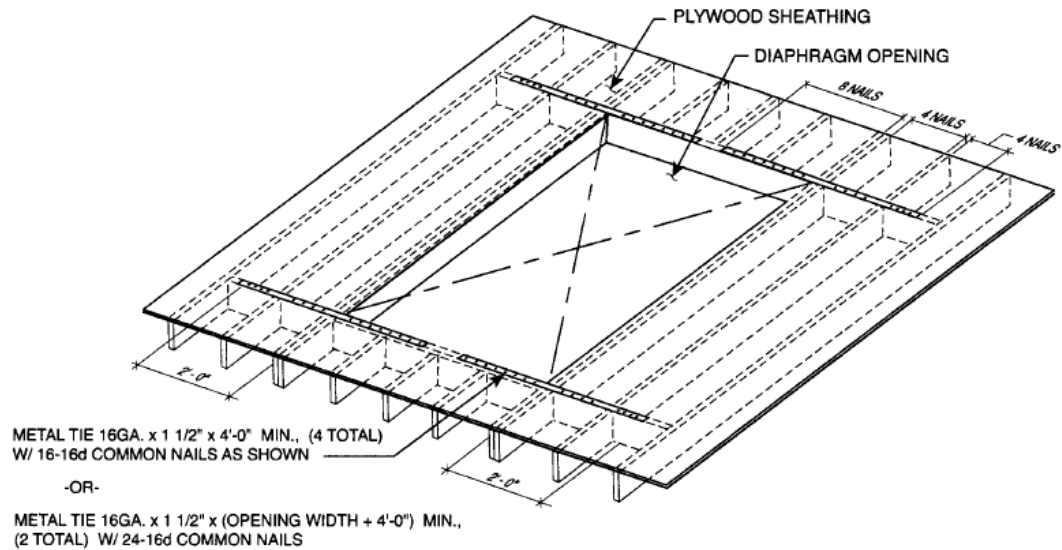

For SI: 1 inch = 25.4 mm, 1 foot = 304.8 mm.

- a. Blockings shall be provided beyond headers.
 - b. Metal ties not less than 0.058 inch [1.47 mm (16 galvanized gage)] by 1.5 inches (38 mm) wide with eight 16d common nails on each side of the header-joist intersection. The metal ties shall have a minimum yield of 33,000 psi (227 MPa).
 - c. Openings in diaphragms shall be further limited in accordance with Section R301.2.2.2.5.
- o) Lines 34 thru 37 of Table R602.3(1) of the 2010 Edition of the California Residential Code are amended to read as follows:

Other wall sheathing ^h				
34	1/2" structural cellulosic fiberboard sheathing	1/2" galvanized roofing nail, 7/16" crown or 1" crown staple 16 ga., 1 1/4" long	3	6
35	25/32" structural cellulosic fiberboard sheathing	1 3/4" galvanized roofing nail, 7/16" crown or 1" crown staple 16 ga., 1 1/2" long	3	6
36	1/2" gypsum sheathing ^d	1 1/2" galvanized roofing nail, staple galvanized, 1 1/2" long, 1 1/4" screws, Type W or S	7	7
37	5/8" gypsum sheathing ^d	1 3/4" galvanized roofing nail, staple galvanized, 1 5/8" long, 1 5/8" screws, Type W or S	7	7

- p) Table R602.3(2) of the 2013 Edition of the California Residential Code is amended to read as follows:



Wood structural panels subfloor, roof and wall sheathing to framing ^f			
up to $\frac{1}{2}$	Staple 15 ga. $\frac{1\frac{3}{4}}{4}$	4	8
	0.097 - 0.099 Nail $2\frac{1}{4}$	3	6
	Staple 16 ga. $\frac{1\frac{3}{4}}{4}$	3	6
$\frac{19}{32}$ and $\frac{5}{8}$	0.113 Nail 2	3	6
	Staple 15 and 16 ga. 2	4	8
	0.097 - 0.099 Nail $2\frac{1}{4}$	4	8
$\frac{23}{32}$ and $\frac{3}{4}$	Staple 14 ga. 2	4	8
	Staple 15 ga. $\frac{1\frac{3}{4}}{4}$	3	6
	0.097 - 0.099 Nail $2\frac{1}{4}$	4	8
	Staple 16 ga. 2	4	8
1	Staple 14 ga. $2\frac{1}{4}$	4	8
	0.113 Nail $2\frac{1}{4}$	3	6
	Staple 16 ga. $2\frac{1}{4}$	4	8

Floor underlayment; plywood-hardboard-particleboard ^f			
Plywood			
$\frac{1}{4}$ and $\frac{5}{16}$	$\frac{1}{4}$ ring or screw shank nail-minimum 12 $\frac{1}{2}$ ga. (0.099") shank diameter	3	6
	Staple 18 ga. $\frac{7}{8}$, $\frac{3}{16}$ crown width	2	5
$\frac{11}{32}$, $\frac{3}{8}$, $\frac{15}{32}$, and $\frac{1}{2}$	$\frac{1}{4}$ ring or screw shank nail-minimum 12 $\frac{1}{2}$ ga. (0.099") shank diameter	6	8 ^e
$\frac{19}{32}$, $\frac{5}{8}$, $\frac{23}{32}$, and $\frac{3}{4}$	$\frac{1}{2}$ ring or screw shank nail-minimum 12 $\frac{1}{2}$ ga. (0.099") shank diameter	6	8
	Staple 16 ga. $\frac{1\frac{1}{2}}{2}$	6	8

- q) Table R602.10.1.2(2) of the 2013 Edition of the California Residential Code is amended to read as follows:

TABLE R602.10.1.2(2)^{a, b, c}
BRACING REQUIREMENTS BASED ON SEISMIC DESIGN CATEGORY
(AS A FUNCTION OF BRACED WALL LINE LENGTH)

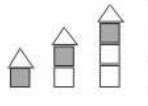
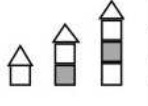
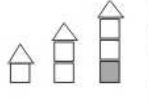
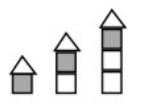



SOIL CLASS D ^a WALL HEIGHT = 10 FT 10 PSF FLOOR DEAD LOAD 15 PSF ROOF/CEILING DEAD LOAD BRACED WALL LINE SPACING ≤ 25 FT			MINIMUM TOTAL LENGTH (feet) OF BRACED WALL PANELS REQUIRED ALONG EACH BRACED WALL LINE			
Seismic Design Category (SDC)	Story Location	Braced Wall Line Length	Method LIB	Methods ^d DWB, SFB, GB, PBS, PCP, HPS	Method WSP	Continuous Sheathing

SDC D ₀ or D ₁		10	NP	3.0 <u>6.0</u>	2.0	1.7
		20	NP	6.0 <u>12.0</u>	4.0	3.4
		30	NP	9.0 <u>18.0</u>	6.0	5.1
		40	NP	12.0 <u>24.0</u>	8.0	6.8
		50	NP	15.0 <u>30.0</u>	10.0	8.5
		10	NP	6.0 <u>NP</u>	4.5	3.8
		20	NP	12.0 <u>NP</u>	9.0	7.7
		30	NP	18.0 <u>NP</u>	13.5	11.5
		40	NP	24.0 <u>NP</u>	18.0	15.3
		50	NP	30.0 <u>NP</u>	22.5	19.1
		10	NP	8.5 <u>NP</u>	6.0	5.1
		20	NP	17.0 <u>NP</u>	12.0	10.2
		30	NP	25.5 <u>NP</u>	18.0	15.3
		40	NP	34.0 <u>NP</u>	24.0	20.4
		50	NP	42.5 <u>NP</u>	30.0	25.5
SDC D ₂		10	NP	4.0 <u>8.0</u>	2.5	
		20	NP	8.0 <u>16.0</u>	5.0	
		30	NP	12.0 <u>24.0</u>	7.5	
		40	NP	16.0 <u>32.0</u>	10.0	
		50	NP	20.0 <u>40.0</u>	12.5	
		10	NP	7.5 <u>NP</u>	5.5	
		20	NP	15.0 <u>NP</u>	11.0	
		30	NP	22.5 <u>NP</u>	16.5	
		40	NP	30.0 <u>NP</u>	22.0	
		50	NP	37.5 <u>NP</u>	27.5	
		10	NP	NP	NP	
		20	NP	NP	NP	
		30	NP	NP	NP	
		40	NP	NP	NP	
		50	NP	NP	NP	

d. Methods GB and PCP braced wall panel h/w ratio shall not exceed 1:1 in SDC D₀, D₁, and D₂. Methods DWB, SFB, PBS, and HPS are not permitted in SDC D₀, D₁, and D₂.

- r) Table R602.10.2 of the 2013 Edition of the California Residential Code is amended to read as follows:

TABLE R602.10.2
INTERMITTENT BRACING METHODS^a

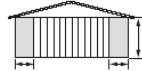
<p><u>8d common (2 1/2" x 0.131) nails at 6" spacing (panel edge) at 12" spacing</u></p>				
WSP	Wood structural panel (see Section R604)	$\frac{3/8"}{8}$ 15/32"		For exterior/interior sheathing— see Table R602.3(3). For interior sheathing— see Table R602.3(4).
SFB	Structural fiberboard sheathing	1/2" or 25/32" for maximum 16" stud spacing		1 1/2" galvanized roofing nails or 8d common (2 1/2" x 0.131) nails at 3" spacing (panel edges) at 6" spacing (intermediate supports)
GB	Gypsum board	1/2"		Nails or screws at 7" spacing at panel edges including top and bottom plates; for all braced wall panel locations for exterior sheathing nail or screw size, see Table R602.3(1); for interior gypsum board nail or screw size, see Table R702.3.5
PBS	Particleboard sheathing (see Section R605)	3/8" or 1/2" for maximum 16" stud spacing		1 1/2" galvanized roofing nails or 8d common (2 1/2" x 0.131) nails at 3" spacing (panel edges) at 6" spacing (intermediate supports)
PCP	Portland cement plaster	See Section R703.6 For maximum 16" stud spacing		1 1/2", 11 gage, 7/16" head nails at 6" spacing or 7/8", 16 gage staples at 6" spacing

(intermediate supports), 3/8"
edge distance to panel edge

a. Methods GB and PCP braced wall panel h/w ratio shall not exceed 1:1 in SDC D₀, D₁, and D₂. Methods LIB, DWB, SFB, PBS, HPS, and PFG are not permitted in SDC D₀, D₁, and D₂.

- s) Figure R602.10.3.2 of the 2013 Edition of the California Residential Code is amended to read as follows:

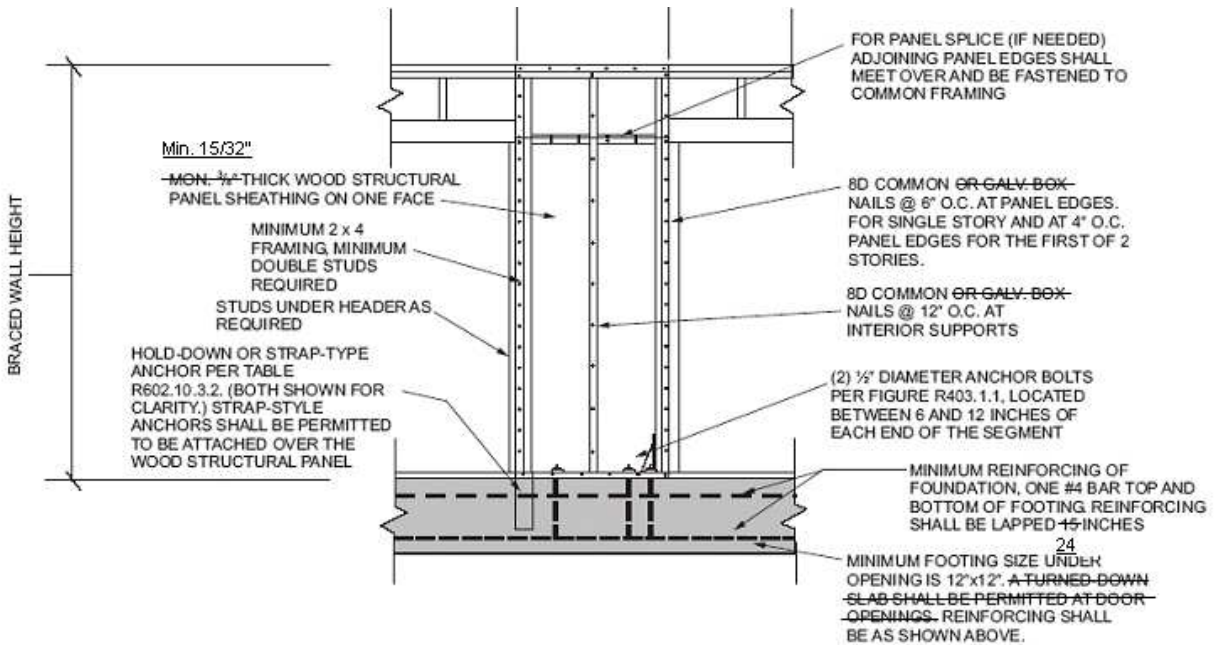

FIGURE R602.10.3.2
ALTERNATE BRACED WALL PANEL

- t) Figure R602.10.3.3 of the 2013 Edition of the California Residential Code is amended to read as follows:

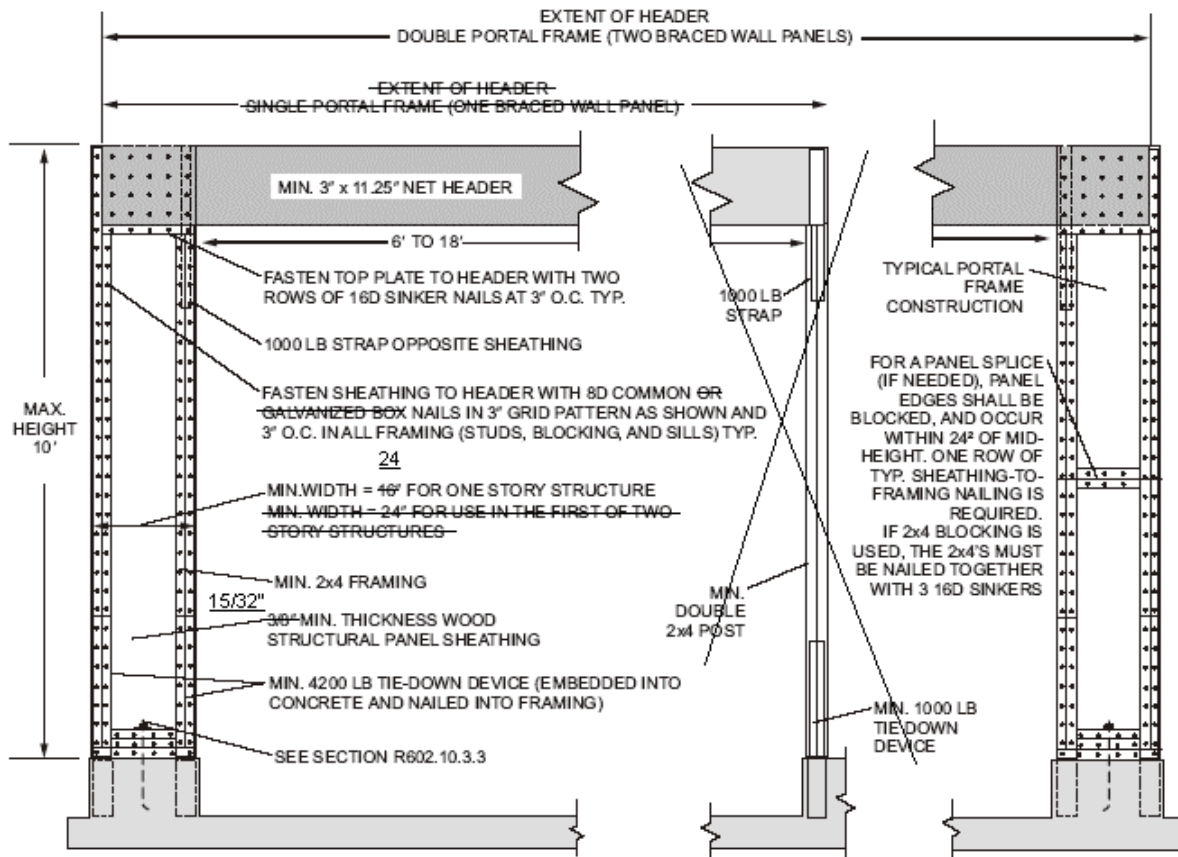
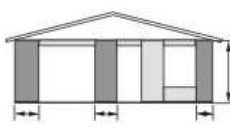
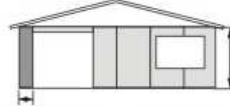
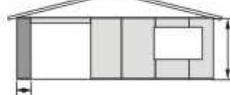

FIGURE R602.10.3.3
METHOD PFH: PORTAL FRAME WITH HOLD-DOWNS AT DETACHED GARAGE DOOR OPENINGS

- u) Item 1 of Section R602.10.3.3 of the 2013 Edition of the California Residential Code is amended to read as follows:
- a) Each panel shall be fabricated in accordance with Figure R602.10.3.3. The wood structural panel sheathing shall extend up over the solid sawn or glued-laminated header and shall be nailed in accordance with Figure R602.10.3.3. A spacer, if used with a built-up header, shall be placed on the side of the built-up beam opposite the wood structural panel sheathing. The header shall extend between the inside faces of the first full-length outer studs of each panel. One anchor bolt not less than 5/8-inch-diameter (16 mm) and installed in accordance with Section R403.1.6 shall be provided in the center of each sill plate. The hold-down devices shall be an embedded-strap type, installed in accordance with the manufacturer's recommendations. The panels shall be supported directly on a foundation that is continuous across the entire length of the braced wall line. The foundation shall be reinforced as shown on Figure R602.10.3.2. This reinforcement shall be lapped not less than 1524 inches (381 610 mm) with the reinforcement required in the continuous foundation located directly under the braced wall line.

- v) Table R602.10.4.1 of the 2013 Edition of the California Residential Code is amended to read as follows:

TABLE R602.10.4.1
CONTINUOUS SHEATHING METHODS

METHOD	MATERIAL	MINIMUM THICKNESS	FIGURE	CONNECTION CRITERIA
CS-WSP	Wood structural panel	$\frac{15}{32}"$ $\frac{3}{8}"$		6d common (2" x 0.113") nails at 6" spacing (panel edges) and at 12" spacing (intermediate supports) or 16 ga. x 1 3/4" staples at 3" spacing (panel edges) and 6" spacing (intermediate supports)
CS-G	Wood structural panel adjacent to garage openings and supporting roof load only ^{a,b}	$\frac{15}{32}"$ $\frac{3}{8}"$		See Method CS-WSP
CS-PF	Continuous portal frame	See Section R602.10.4.1.1		See Section R602.10.4.1.1

- w) Figure R602.10.4.1.1 of the 2013 Edition of the California Residential Code is amended to read as follows:

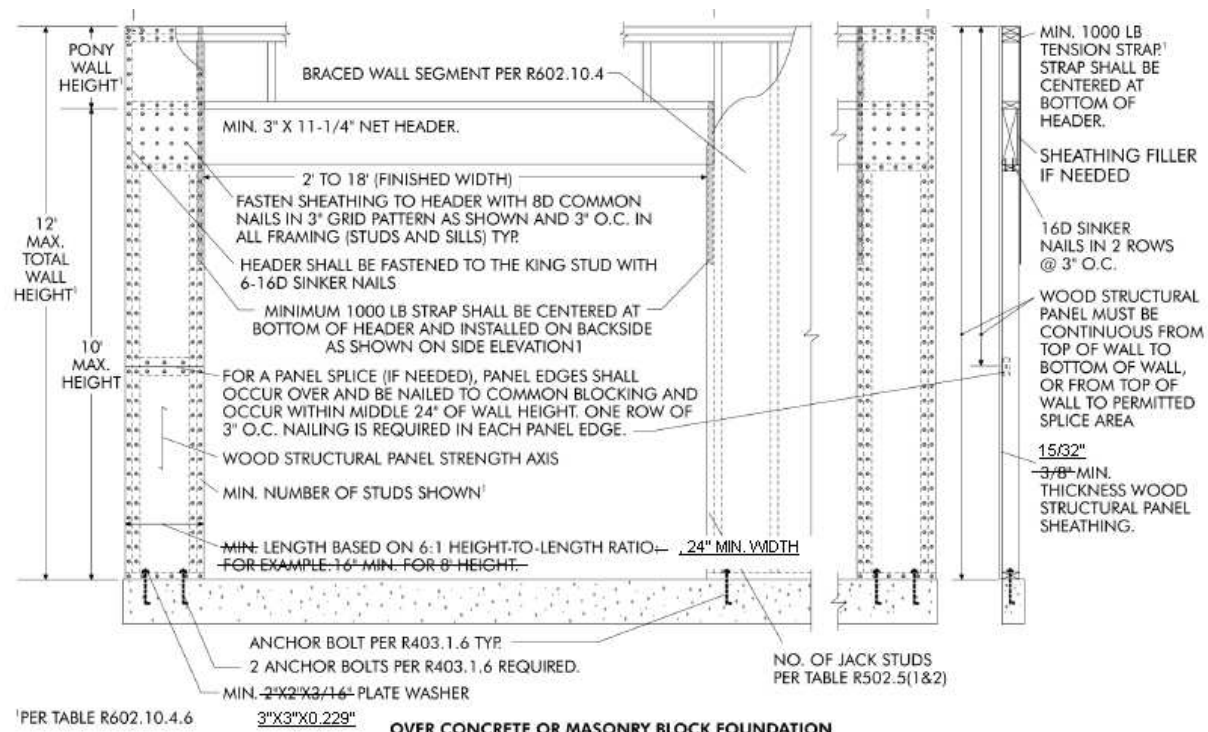

- x) Section R602.10.7.1 of the 2013 Edition of the California Residential Code is deleted in its entirety:

~~**R602.10.7.1 Braced wall panel support for Seismic Design Category D₂.** In one-story buildings located in Seismic Design Category D₂, braced wall panels shall be supported on continuous foundations at intervals not exceeding 50 feet (15 240 mm). In two-story buildings located in Seismic Design Category D₂, all braced wall panels shall be supported on continuous foundations.~~

~~**Exception:** Two-story buildings shall be permitted to have interior braced wall panels supported on continuous foundations at intervals not exceeding 50 feet (15 240 mm) provided that:~~

- ~~1. The height of cripple walls does not exceed 4 feet (1219 mm).~~
- ~~2. First floor braced wall panels are supported on doubled floor joists, continuous blocking or floor beams.~~
- ~~3. The distance between bracing lines does not exceed twice the building width measured parallel to the braced wall line.~~

- y) Section R606.2.4 of the 2013 Edition of the California Residential Code is amended to read as follows:

R606.2.4 Parapet walls. Unreinforced solid masonry parapet walls shall not be less than 8 inches (203 mm) thick and their height shall not exceed four times their thickness. Unreinforced hollow unit masonry parapet walls shall be not less than 8 inches (203 mm) thick, and their height shall not exceed three times their thickness. Masonry parapet walls in areas subject to wind loads of 30 pounds per square foot (1.44 kPa) or located in Seismic Design Category D₀, D₁ or D₂, or on townhouses in Seismic Design Category C shall be reinforced in accordance with Section R606.12.

- z) Section R606.12.2.2.3 of the 2013 Edition of the California Residential Code is amended to read as follows:

R606.12.2.2.3 Reinforcement of requirements for masonry elements. Masonry elements listed in Section R606.12.2.2.2 shall be reinforced in either the horizontal or vertical direction as shown in Figure ~~R606.11(2)~~R606.11(3) and in accordance with the following:

1. Horizontal reinforcement. Horizontal joint reinforcement shall consist of ~~at least two longitudinal W1.7 wires spaced not more than 16 inches (406 mm) for walls greater than 4 inches (102 mm) in width and at least one longitudinal W1.7 wire spaced not more than 16 inches (406 mm) for walls not exceeding 4 inches (102 mm) in width; or~~ at least one No. 4 bar spaced not more than 48 inches (1219 mm). ~~Where two longitudinal wires of joint reinforcement are used, the space between these wires shall be the widest that the mortar joint will accommodate.~~ Horizontal reinforcement shall be provided within 16 inches (406 mm) of the top and bottom of these masonry elements.

2. Vertical reinforcement. Vertical reinforcement shall consist of at least one No. 4 bar spaced not more than 48 inches (1219 mm). Vertical reinforcement shall be within ~~16-8~~ inches (406mm) of the ends of masonry walls
- aa) Exception of Section 602.3.2 of the 2013 Edition of the California Residential Code is amended to read as follows:
- Exception:** In other than Seismic Design Category D₀, D₁ or D₂, a single top plate may be installed in stud walls, provided the plate is adequately tied at joints, corners and intersecting walls by a minimum 3-inch-by-6-inch by a 0.036-inch-thick (76 mm by 152 mm by 0.914 mm) galvanized steel plate that is nailed to each wall or segment of wall by six 8d nails on each side, provided the rafters or joists are centered over the studs with a tolerance of no more than 1 inch (25 mm). The top plate may be omitted over lintels that are adequately tied to adjacent wall sections with steel plates or equivalent as previously described.
- bb) Footnote “i” is added to Table R802.5.1(9) of the 2013 Edition of the California Residential Code to read as follows:
- i. Edge distances, end distances and spacings for nails shall be sufficient to prevent splitting of the wood.
- cc) Section R802.8 of the 2013 Edition of the California Residential Code is amended to read as follows:
- R802.8 Lateral support.** Roof framing members and ceiling joists having a depth-to-thickness ratio exceeding ~~5~~ 2 to 1 based on nominal dimensions shall be provided with lateral support at points of bearing to prevent rotation. For roof rafters with ceiling joists attached per Table R602.3(1), the depth-thickness ratio for the total assembly shall be determined using the combined thickness of the rafter plus the attached ceiling joist.
- dd) Section R802.10.2 of the 2013 Edition of the California Residential Code is amended to read as follows:
- R802.10.2 Design.** Wood trusses shall be designed in accordance with accepted engineering practice. The design and manufacture of metal-plate-connected wood trusses shall comply with ANSI/TPI 1. The truss design drawings shall be prepared by a registered professional ~~where required by the statutes of the jurisdiction in which the project is to be constructed in accordance with Section R106.1.~~
- ee) Section R803.2.4 of the 2013 Edition of the California Residential Code is added to Chapter 8 of the 2013 Edition of the California Residential Code to read as follows:
- R803.2.4 Openings in horizontal diaphragms.** Openings in horizontal diaphragms shall conform with Section R503.2.4.

- ff) Section R902.1 of the 2013 Edition of the California Residential Code is amended by revising it to allow only class A or B roofs as follows:

R902.1 Roofing covering materials. Roofs shall be covered with materials as set forth in Sections R904 and R905. A minimum Class A or B roofing shall be installed in areas designated by this section. Classes A or B roofing required by this section to be listed shall be tested in accordance with UL 790 or ASTM E 108.

Exceptions:

1. Class A roof assemblies include those with coverings of brick, masonry and exposed concrete roof deck.
2. Class A roof assemblies also include ferrous or copper shingles or sheets, metal sheets and shingles, clay or concrete roof tile, or slate installed on noncombustible decks.

- gg) Section R902.1.3 of the 2013 Edition of the California Residential Code is amended by revising it to require a minimum Class B roof as follows:

R902.1.3 Roof coverings within all other areas. The entire roof covering of every existing structure where more than 50 percent of the total roof area is replaced within any one-year period, the entire roof covering of every new structure, and any roof covering applied in the alteration, repair or replacement of the roof of every existing structure, shall be a fire-retardant roof covering that is at least Class B.

- hh) Section R1001.3.1 of the 2013 Edition of the California Residential Code is amended to read as follows:

R1001.3.1 Vertical reinforcing. For chimneys up to 40 inches (1016 mm) wide, four No. 4 continuous vertical bars adequately anchored into the concrete foundation shall be placed between wythes of solid masonry or within the cells of hollow unit masonry and grouted in accordance with Section R609. Grout shall be prevented from bonding with the flue liner so that the flue liner is free to move with thermal expansion. For chimneys more than 40 inches (1016 mm) wide, two additional No. 4 vertical bars adequately anchored into the concrete foundation shall be provided for each additional flue incorporated into the chimney or for each additional 40 inches (1016 mm) in width or fraction thereof.

(d) Amendments to the 2013 California Green Building Standards Code.

- a) Section 101.10 of the 2013 Edition of the California Green Building Standards Code is amended to read as follows:

101.10 Mandatory and voluntary requirements. This code contains both mandatory and voluntary green building measures. Mandatory and voluntary measures are identified in the appropriate application checklist contained in this code. The mandatory measures of Chapter 4 and voluntary measures of Appendix A4 shall

apply to new low-rise residential buildings. The mandatory measures of Chapter 5 and voluntary measures of Appendix A5 shall apply to all buildings which are not low-rise residential buildings.

- b) Section 101.12 is added to the 2013 California Green Building Standards Code to read as follows:

101.12 Fee for Mandatory Measures. A fee of ten percent (10%) of the plan check/permit fee shall be assessed to verify compliance with the mandatory measure of the California Green Building Standards Code.

- c) Section 101.12.1 is added to the 2013 California Green Building Standards Code to read as follows:

101.12.1 Fee for Tier Measures. When Tier 1 or Tier 2 measures need to be verified by the enforcing agency, an additional ten percent (10%) of the plan check/permit fee may be assessed.

- d) Section 202 of the 2013 Edition of the California Green Building Standards Code is amended to read as follows:

LOW-RISE RESIDENTIAL BUILDING. A building that is of Occupancy Group R and is ~~three~~six stories or less, or that is a one- or two-family dwelling or townhouse.

Sustainability. Consideration of present development and construction impacts on the community, the economy, and the environment without compromising the needs of the future.

- e) Section 4.304.1 of the 2013 Edition of the California Green Building Standards Code is amended to read as follows:

Irrigation controllers. Automatic irrigation system controllers for landscaping provided ~~by the builder~~ and installed at the time of final inspection and shall comply with the following:

1. Controllers shall be weather-or soil moisture-based irrigation controllers that automatically adjust irrigation in response to changes in plants' needs as weather conditions change.
2. Weather-based controllers without integral rain sensors or communication systems that account for local rainfall shall have a separate wired or wireless rain sensor which connects or communicates with the controller(s). Soil moisture-based controllers are not required to have rain sensor input.

SECTION 2. This action is exempt from the California Environmental Quality Act (CEQA) pursuant to section 15061(b)(3) of the State Guidelines to Implement CEQA in that there is no possibility that the action could cause a significant effect on the environment.

SECTION 3. If any portion of this Ordinance is found to be unconstitutional or invalid, the City Council hereby declares that it would have enacted the remainder of this Ordinance regardless of the absence of any such invalid part or portion. The City Council of the City of Pomona hereby declares that it would have passed this Ordinance, and each section, subsection, sentence, clause, or phrase hereof, irrespective of the fact that any one or more sections, subsections, sentences, clauses, and phrases be declared unconstitutional.

SECTION 4. The City Clerk shall attest to the passage and adoption of this Ordinance, and shall cause same to be posted as required by law, and this Ordinance shall take effect thirty (30) days after its final adoption.

APPROVED AND ADOPTED THIS 16TH DAY OF JUNE 2014.

ATTEST:

CITY OF POMONA:

Eva M. Buice, MMC, City Clerk

Elliott Rothman, Mayor

APPROVED AS TO FORM:

Arnold Alvarez-Glasman, City Attorney

STATE OF CALIFORNIA)
COUNTY OF LOS ANGELES)
CITY OF POMONA)

I, EVA M. BUICE, CITY CLERK of the City of Pomona do hereby certify that the foregoing Ordinance was introduced at the Regular Meeting of the City Council of the City of Pomona held on the 2nd day of June 2014, and adopted at a Regular Meeting on the 16th day of June 2014 by the following vote:

AYES: Nolte, Robledo, Carrizosa, Lantz, Escobar, Mayor Rothman

NOES: None

ABSENT: Martin

ABSTAIN: None

IN WITNESS WHEREOF, I have hereunto set my hand and affixed the official seal of the City of Pomona, California, this _____ of _____ 2014.

Eva M. Buice, MMC, City Clerk