

AN ORDINANCE TO AMEND THE OFFICIAL ZONING MAP OF THE CITY OF CHAMBLEE AS PROVIDED IN THE CODE OF ORDINANCES OF THE CITY OF CHAMBLEE, GEORGIA, CHAPTER 94, APPENDIX A, "ZONING", ARTICLE IV, "PROVISION FOR OFFICIAL ZONING MAP ESTABLISHMENT OF DISTRICTS" TO PROVIDE FOR DESIGNATION OF BOUNDARIES OF THE INDUSTRIAL TRANSITIONAL (IT) ZONING DISTRICT, PORTRAYAL OF SUCH ZONING DESIGNATION ON THE OFFICIAL ZONING MAP AND ENTRY IN THE MINUTES OF THE AMENDMENT TO THE OFFICIAL ZONING MAP AS PROVIDED IN SECTION 401, ARTICLE IV AND FOR ALL OTHER LAWFUL PURPOSES

PART I

BE IT ORDAINED AND IT IS HEREBY ORDAINED BY THE MAYOR AND CITY COUNCIL OF THE CITY OF CHAMBLEE, GEORGIA that the Official Zoning Map of the City of Chamblee shall be amended to provide for portrayal of the boundaries of the Industrial Transitional Zoning Classification as provided in Appendix A, an exemplification of the boundaries being depicted on the map attached hereto which is designated "Industrial Transitional Zoning District" and that such change be entered on the Official Zoning Map within 30 days after this amendment is approved and adopted by Mayor and City Council. Further, the City clerk is directed to enter upon the minutes of the Council Meeting at which this ordinance is adopted the following:

"On January 15 , 2013 by official action of the Mayor and City Council, the following change was made to the Official Zoning Map: The boundaries of the Industrial Transitional Zoning district shall be as depicted on the map attached to these minutes such that the properties within said boundaries shall be zoned as Industrial Transitional (IT)."

The aforesaid minutes shall be signed by the Mayor and attested by the City Manager and the map attached hereto designated "Industrial Transitional Zoning District" shall amend the Official Zoning Map of the City of Chamblee and the map of the Industrial Transitional Zoning District shall be signed by the Mayor, attested by the City Manager and dated of equal date with the date of adoption of this Ordinance No. 650.

PART II

It is hereby declared to be the intention of the Mayor and City Council that the sections, paragraphs, sentences, clauses and phrases of this ordinance are severable, and, if any phrase, clause, sentence, paragraph or section of this ordinance shall be declared unconstitutional by the valid judgment or decree of any court of competent jurisdiction, such unconstitutionality shall not affect any of the remaining phrases, clauses, sentences, paragraphs and sections of this ordinance.

The foregoing was proposed by Council member Tom Hogan with a motion that the same be adopted. Said motion was seconded by Council member Mark Wedge. Same was then put to a vote and 5 Council members voted in favor of the Ordinance and 0 Council members voted against the Ordinance. Said motion was thereupon declared passed and duly adopted this 15 day January, 2013.



Emmie Niethammer
City Clerk, City of Chamblee, Georgia

Approved this 15 day of January, 2013.

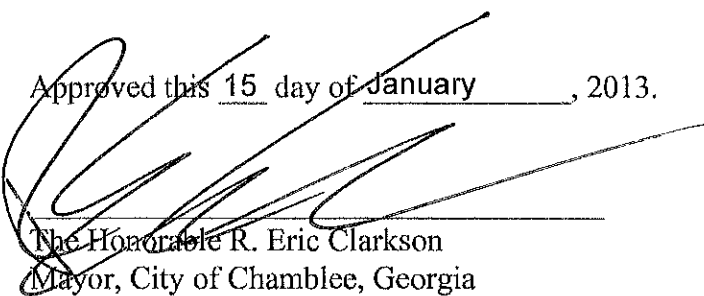

The Honorable R. Eric Clarkson
Mayor, City of Chamblee, Georgia

Approved as to form:

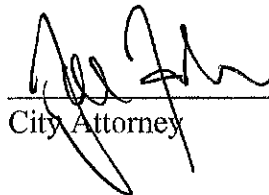

City Attorney

First reading: December 18, 2012

Second reading: January 15, 2013

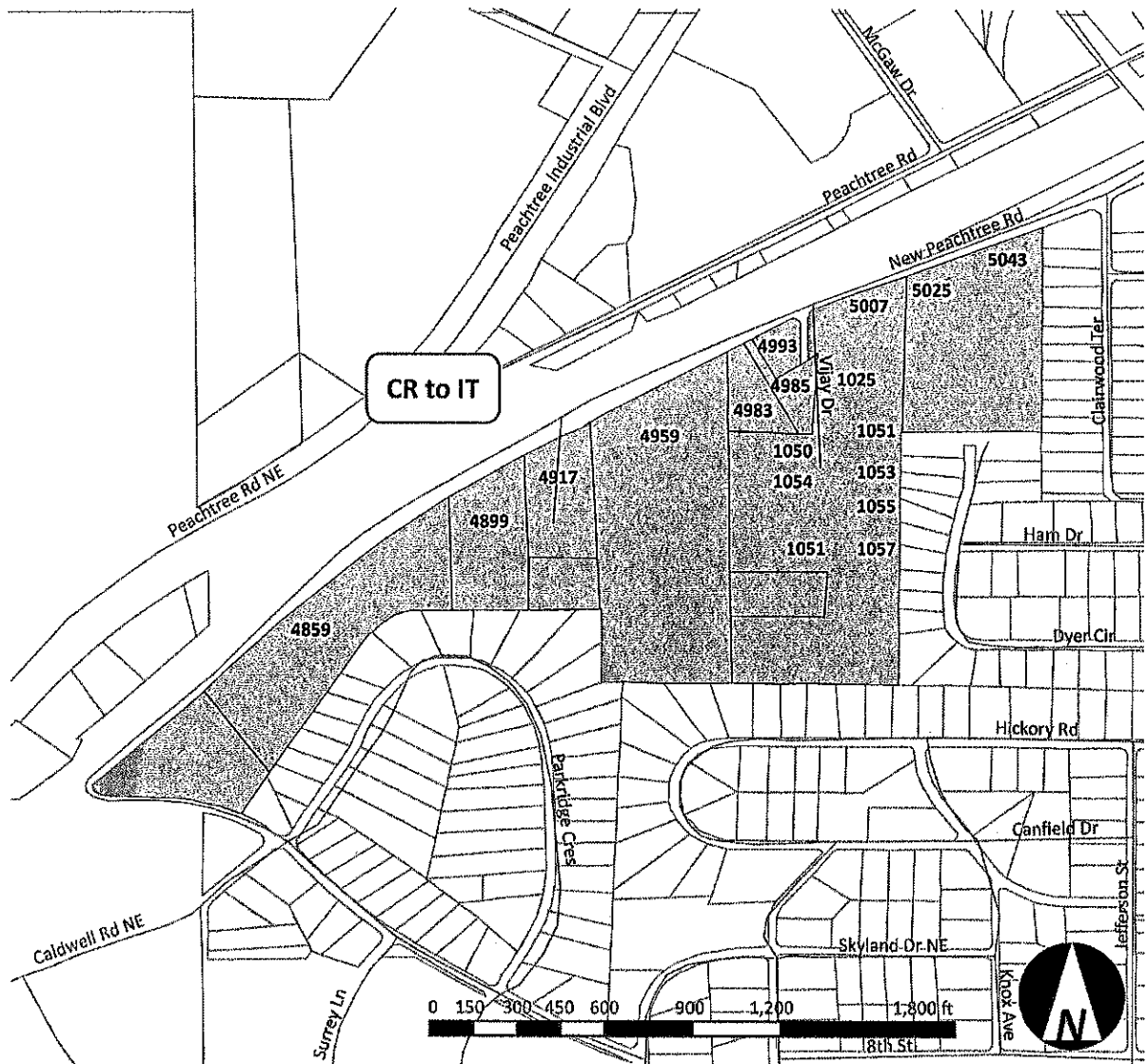

AREA 1

All below referenced parcels are proposed to change to Industrial Transitional (IT) zoning.

Address	PIN	Current Zoning
4859 New Peachtree Road	18 278 03 066	CR
4899 New Peachtree Road	18 278 03 101	CR
4917 New Peachtree Road	18 278 03 124	CR
4917 New Peachtree Road	18 278 03 065	CR
4959 New Peachtree Road	18 278 03 064	CR
4983 New Peachtree Road	18 278 03 063	CR
4985 New Peachtree Road	18 278 03 062	CR
4993 New Peachtree Road	18 278 03 061	CR
5007 New Peachtree Road	18 278 03 060	CR
5025 New Peachtree Road	18 278 03 058	CR
5043 New Peachtree Road	18 278 03 058	CR
1050 Vijay Drive	18 278 03 060	CR
1054 Vijay Drive	18 278 03 060	CR
1025 Vijay Drive	18 278 03 060	CR
1051 Vijay Drive	18 278 03 060	CR
1053 Vijay Drive	18 278 03 060	CR
1055 Vijay Drive	18 278 03 060	CR
1057 Vijay Drive	18 278 03 060	CR
1061 Vijay Drive	18 278 03 060	CR

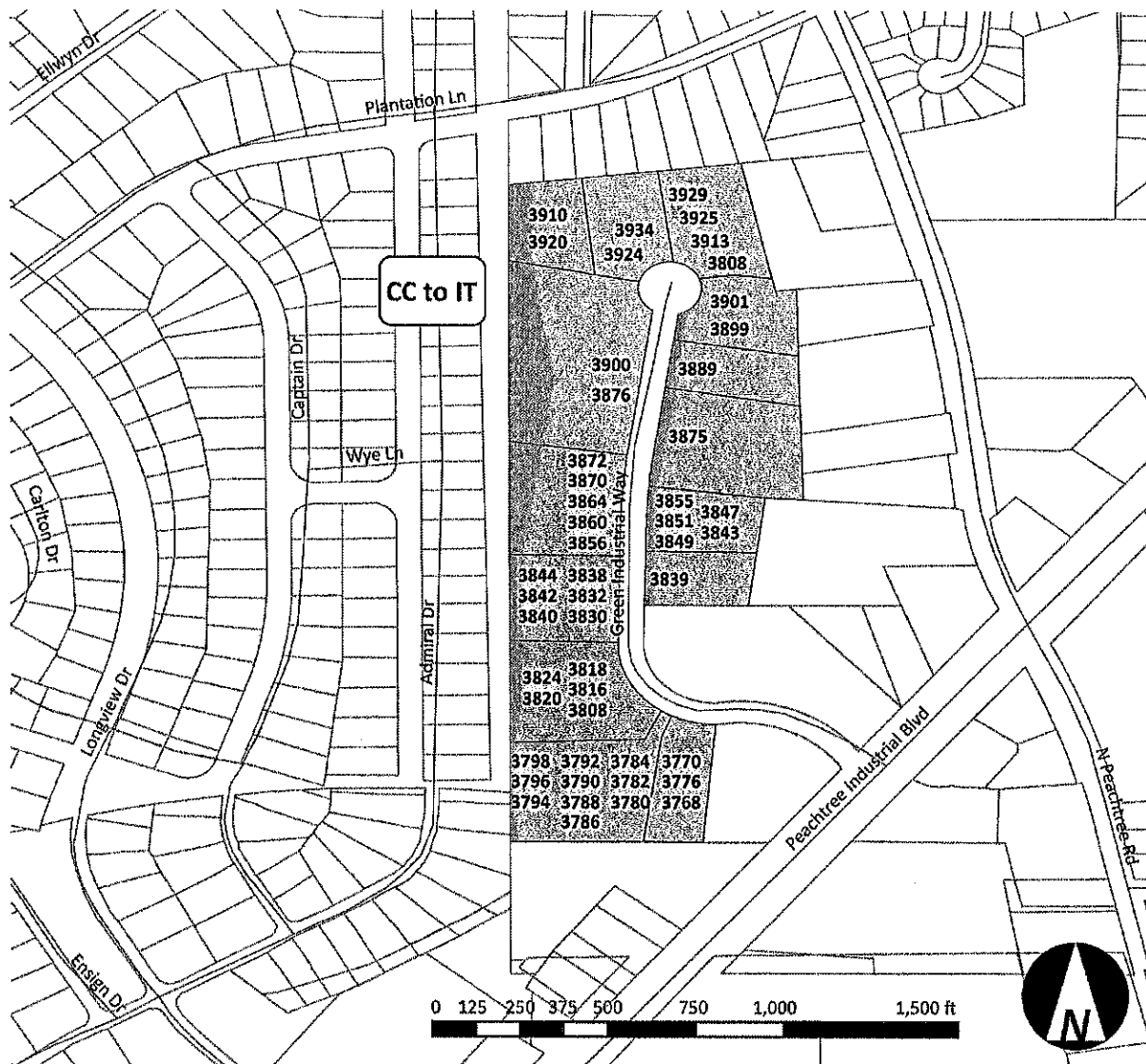

AREA 2

All below referenced parcels are proposed to change to Industrial Transitional (IT) zoning.

Address	PIN	Current Zoning
3855 Green Industrial Way	18 323 03 024	CC
3851 Green Industrial Way	18 323 03 024	CC
3849 Green Industrial Way	18 323 03 024	CC
3847 Green Industrial Way	18 323 03 024	CC
3843 Green Industrial Way	18 323 03 024	CC
3875 Green Industrial Way	18 323 03 025	CC
3901 Green Industrial Way	18 323 03 026	CC
3899 Green Industrial Way	18 323 03 026	CC
3929 Green Industrial Way	18 323 03 027	CC
3925 Green Industrial Way	18 323 03 027	CC
3913 Green Industrial Way	18 323 03 027	CC
3808 Green Industrial Way	18 323 03 027	CC
3924 Green Industrial Way	18 323 03 028	CC
3934 Green Industrial Way	18 323 03 028	CC
3876 Green Industrial Way	18 323 03 029	CC
3900 Green Industrial Way	18 323 03 029	CC
3856 Green Industrial Way	18 323 03 031	CC
3860 Green Industrial Way	18 323 03 031	CC
3864 Green Industrial Way	18 323 03 031	CC
3870 Green Industrial Way	18 323 03 031	CC
3872 Green Industrial Way	18 323 03 031	CC
3830 Green Industrial Way	18 323 03 032	CC
3832 Green Industrial Way	18 323 03 032	CC
3838 Green Industrial Way	18 323 03 032	CC
3840 Green Industrial Way	18 323 03 032	CC
3842 Green Industrial Way	18 323 03 032	CC
3844 Green Industrial Way	18 323 03 032	CC
3780 Green Industrial Way	18 323 03 033	CC
3782 Green Industrial Way	18 323 03 033	CC
3784 Green Industrial Way	18 323 03 033	CC
3786 Green Industrial Way	18 323 03 033	CC
3788 Green Industrial Way	18 323 03 033	CC
3790 Green Industrial Way	18 323 03 033	CC
3792 Green Industrial Way	18 323 03 033	CC
3794 Green Industrial Way	18 323 03 033	CC
3796 Green Industrial Way	18 323 03 033	CC
3798 Green Industrial Way	18 323 03 033	CC
3768 Green Industrial Way	18 323 03 034	CC
3770 Green Industrial Way	18 323 03 034	CC
3776 Green Industrial Way	18 323 03 034	CC
3808 Green Industrial Way	18 323 03 040	CC
3816 Green Industrial Way	18 323 03 040	CC
3818 Green Industrial Way	18 323 03 040	CC
3820 Green Industrial Way	18 323 03 040	CC
3824 Green Industrial Way	18 323 03 040	CC
3910 Green Industrial Way	18 323 03 041	CC
3920 Green Industrial Way	18 323 03 041	CC
3889 Green Industrial Way	18 323 03 048	CC
3839 Green Industrial Way	18 323 03 054	CC

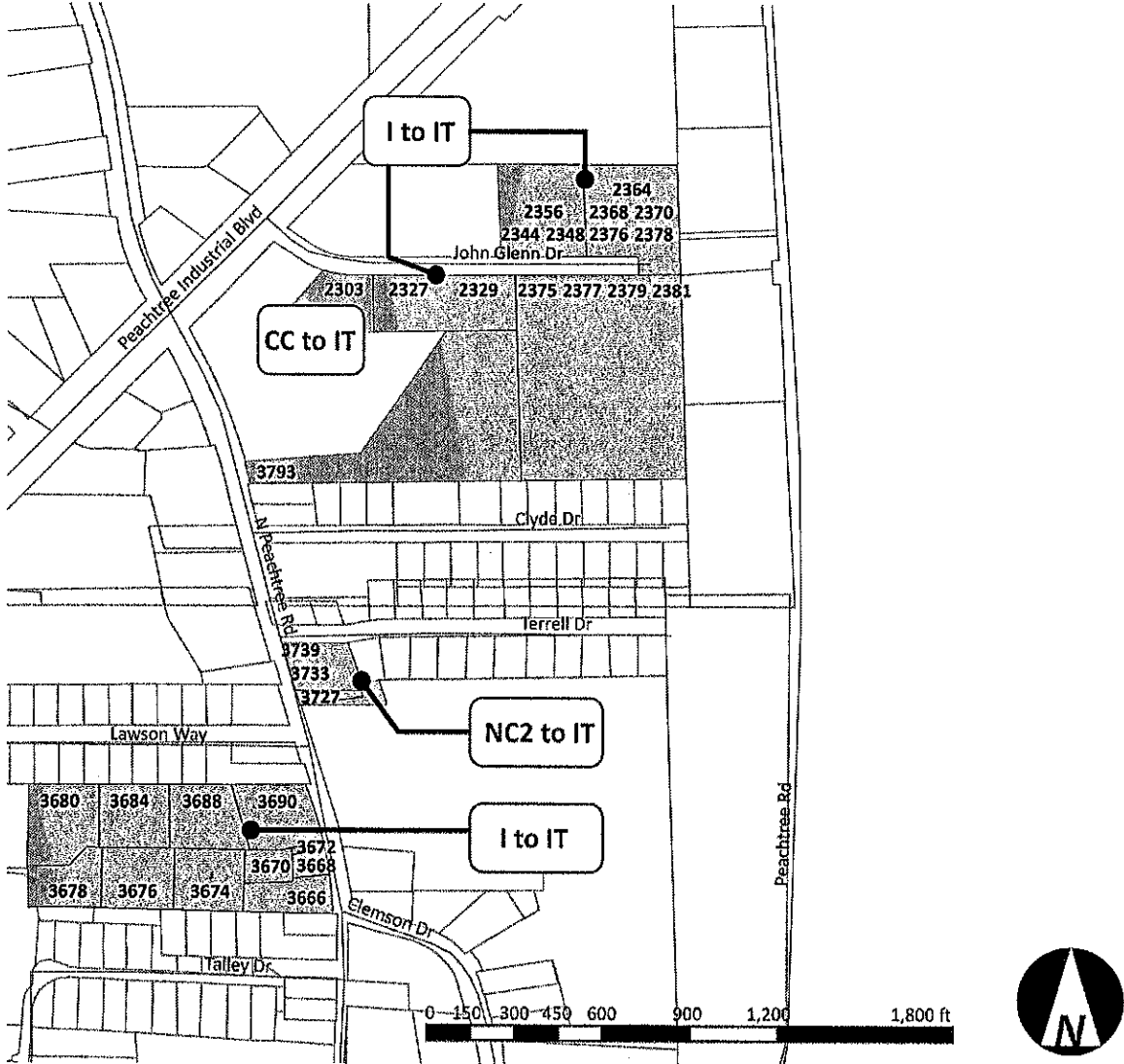

AREA 3

All below referenced parcels are proposed to change to Industrial Transitional (IT) zoning.

Address	PIN	Current Zoning
2375 John Glenn Drive	18 323 05 036	I
2377 John Glenn Drive	18 323 05 036	I
2379 John Glenn Drive	18 323 05 036	I
2381 John Glenn Drive	18 323 05 036	I
2303 John Glenn Drive	18 323 05 037	CC
2344 John Glenn Drive	18 323 05 044	I
2348 John Glenn Drive	18 323 05 044	I
2356 John Glenn Drive	18 323 05 044	I
2364 John Glenn Drive	18 323 05 045	I
2368 John Glenn Drive	18 323 05 045	I
2370 John Glenn Drive	18 323 05 045	I
2376 John Glenn Drive	18 323 05 045	I
2378 John Glenn Drive	18 323 05 045	I
2327 John Glenn Drive	18 323 05 048	I
2329 John Glenn Drive	18 323 05 048	I
3680 North Peachtree Rd	18 309 02 102	I
3684 North Peachtree Rd	18 309 02 100	I
3688 North Peachtree Rd	18 309 02 095	I
3690 North Peachtree Rd	18 309 02 101	I
3678 North Peachtree Rd	18 309 02 032	I
3676 North Peachtree Rd	18 309 02 099	I
3674 North Peachtree Rd	18 309 02 097	I
3670 North Peachtree Rd	18 309 02 103	I
3666 North Peachtree Rd	18 309 02 089	I
3668 North Peachtree Rd	18 309 02 096	I
3672 North Peachtree Rd	18 309 02 098	I
3739 North Peachtree Rd	18 309 07 050	NC-2
3733 North Peachtree Rd	18 309 07 050	NC-2
3727 North Peachtree Rd	18 309 07 051	NC-2
3727 North Peachtree Rd	18 309 07 047	NC-2
3793 North Peachtree Rd	18 323 05 054	CC

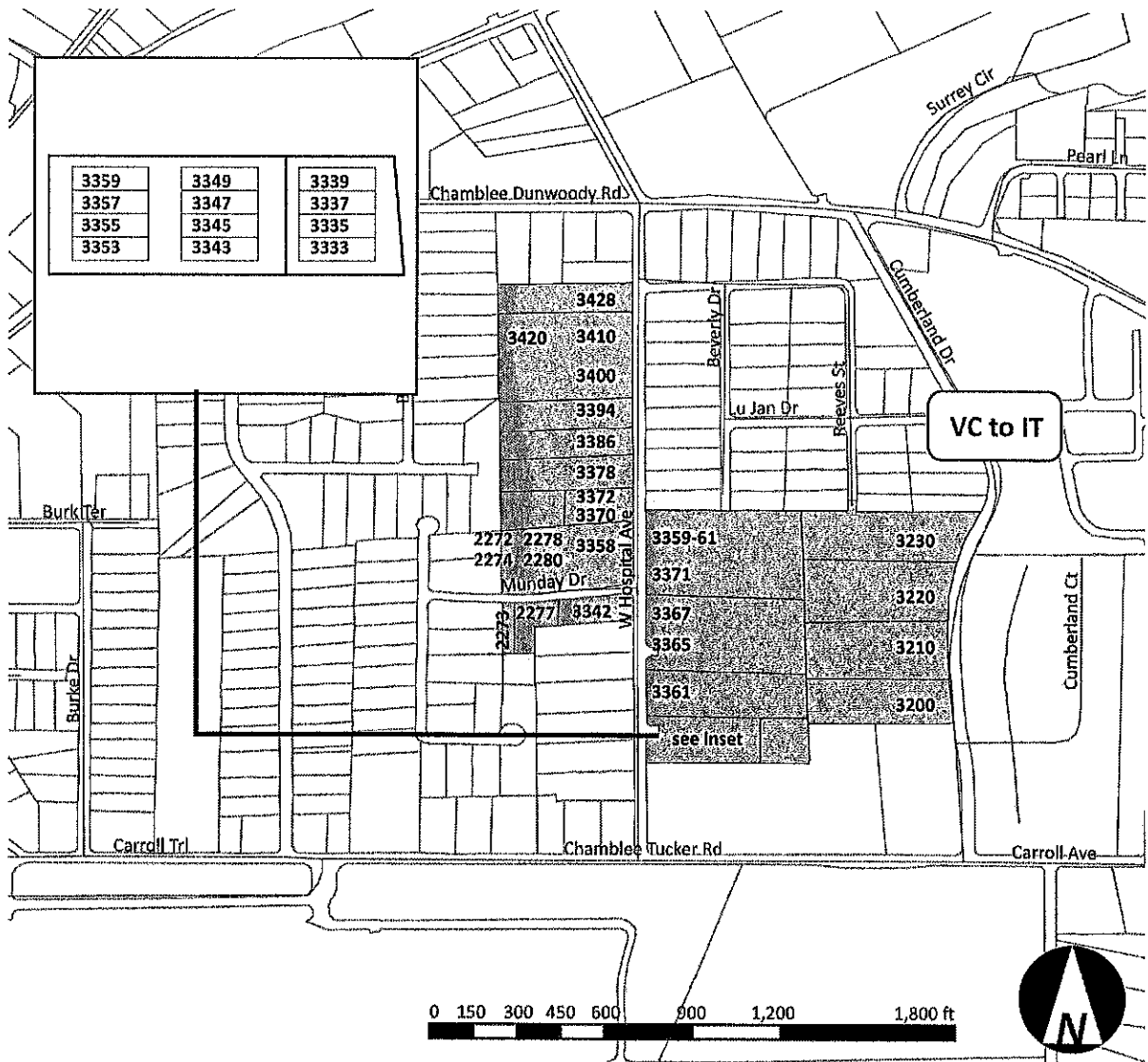

AREA 4

All below referenced parcels are proposed to change to Industrial Transitional (IT) zoning.

Address	PIN	Current Zoning
3428 West Hospital Ave	18 298 04 081	VC
3420 West Hospital Ave	18 298 04 079	VC
3410 West Hospital Ave	18 298 04 079	VC
3400 West Hospital Ave	18 298 04 079	VC
3394 West Hospital Ave	18 298 04 078	VC
3386 West Hospital Ave	18 298 04 077	VC
3378 West Hospital Ave	18 298 04 076	VC
3372 West Hospital Ave	18 298 04 075	VC
3370 West Hospital Ave	18 298 04 099	VC
3358 West Hospital Ave	18 298 04 035	VC
2272 Munday Drive	18 298 04 035	VC
2274 Munday Drive	18 298 04 035	VC
2278 Munday Drive	18 298 04 035	VC
2280 Munday Drive	18 298 04 035	VC
2273 Munday Drive	18 298 04 037	VC
2277 Munday Drive	18 298 04 036	VC
3342 Munday Drive	18 298 04 014	VC
3359-61 West Hospital Ave	18 298 05 032	VC
3371 West Hospital Ave	18 298 05 032	VC
3367 West Hospital Ave	18 298 05 034	VC
3365 West Hospital Ave	18 298 05 034	VC
3361 West Hospital Ave	18 298 05 035	VC
3230 Cumberland Drive	18 298 05 033	VC
3220 Cumberland Drive	18 298 05 031	VC
3210 Cumberland Drive	18 298 05 030	VC
3200 Cumberland Drive	18 298 05 029	VC