

ORDINANCE NO. 2015-2066

AN ORDINANCE RELATING TO VOLUNTARY ANNEXATION; MAKING FINDING; ANNEXING TO AND INCLUDING WITHIN THE BOUNDARIES OF THE CITY OF LAKE CITY, FLORIDA, CERTAIN REAL PROPERTY LOCATED IN SECTION 36, TOWNSHIP 3 SOUTH, RANGE 16 EAST, CONTIGUOUS TO THE NORTH AND WESTERLY BOUNDARY OF THE CITY OF LAKE CITY, REDEFINING THE BOUNDARIES OF THE CITY OF LAKE CITY, FLORIDA; PROVIDING FOR ZONING AND LAND USE CLASSIFICATION OF THE REAL PROPERTY TO BE ANNEXED; PROVIDING THAT EXISTING LICENSED BUSINESSES, TRADES, OR PROFESSIONS OPERATING WITHIN THE REAL PROPERTY TO BE ANNEXED MAY CONTINUE SUCH BUSINESSES, TRADES, OR PROFESSIONS THROUGHOUT THE ENTIRE BOUNDARIES OF THE CITY OF LAKE CITY PROVIDING THAT EFFECTIVE JANUARY 1, 2016, THE REAL PROPERTY TO BE ANNEXED SHALL BE ASSESSED FOR PAYMENT OF MUNICIPAL AD VALOREM TAXES AND BE SUBJECT TO ALL GENERAL AND SPECIAL ASSESSMENTS; AND PROVIDING AN EFFECTIVE DATE; AND DIRECTING THE CITY CLERK, WITHIN SEVEN DAYS OF THE EFFECTIVE DATE OF THIS ORDINANCE, TO FILE CERTIFIED COPIES OF THIS ORDINANCE WITH THE CLERK OF CIRCUIT COURT FOR COLUMBIA COUNTY, THE CHIEF ADMINISTRATIVE OFFICER OF COLUMBIA COUNTY, THE DEPARTMENT OF STATE, TALLAHASSEE, FLORIDA, THE COLUMBIA COUNTY PROPERTY APPRAISER, THE COLUMBIA COUNTY TAX COLLECTOR, AND ALL PUBLIC UTILITIES AUTHORIZED TO CONDUCT BUSINESS WITHIN THE CITY OF LAKE CITY.

WHEREAS, Halle Properties LLC, as owner of certain real property more particularly described herein below, lying north and west of the boundary of the City of Lake City and located in Section 36, Township 3 South, Range 16 East have requested that the same be voluntarily annexed and incorporated into the boundaries of the City of Lake City, Florida.

WHEREAS, Florida Statutes Chapter 171 establishes procedures for voluntary annexation.

NOW, THEREFORE, BE IT ENACTED BY THE PEOPLE OF THE CITY OF LAKE CITY, FLORIDA, AS FOLLOWS:

Section 1. The owners of real property in the unincorporated area of Columbia County described in Schedule "A" and depicted on Schedule "B" as a location map, attached hereto are hereby incorporated into and made part of this ordinance, which real property is contiguous to the existing north and westerly boundary of the City of Lake City, Florida, and is reasonably compact, have petitioned the City to have said real property annexed into the City.

Section 2. The City Council of the City of Lake City, Florida, finds that the petition bears the signatures of all owners of the real property in the area proposed to be annexed.

Section 3. The City Council of the City of Lake City, Florida, finds that the real property described in Section 1 above presently is contiguous to the boundaries of the City of Lake City, Florida, that said real property meets the criteria established by Chapter 171, Florida Statutes, and that said real property should be annexed to the boundaries of the City of Lake City.

Section 4. The real property described in Schedule "A", and depicted on Schedule "B", location map, attached hereto, is hereby annexed to the boundaries of the City of Lake City, Florida, and said real property in every way is a part of the City of Lake City, Florida, beginning on the effective date of this ordinance.

Section 5. The boundaries of the City of Lake City, Florida, created and established by and defined in Ordinances 86-576, as amended by the adoption of

91-693, 92-713, 92-714, 92-717, 93-731, 94-745, 94-750, 94-753, 94-754, 95-765, 95-767, 95-783, 95-784, 96-778B, 96-780B, 96-781B, 96-782B, 96-786, 96-791, 96-793, 96-794, 97-798, 97-802, 97-809, 98-837, 99-849, 99-853, 99-858, 99-861, 99-864, 99-865, 00-896, 00-902, 00-904, 01-912, 01-920, 02-956, 02-968, 02-976, 03-993, 03-994, 04-998, 04-1000, 04-1015, 04-1018, 05-1026, 06-1058, 06-1063, 06-1079, 06-1085, 07-1103, 07-1106, 07-1108, 07-1109, 07-1124, 07-1125, 07-1126, 07-1131, 07-1135, 08-1143, 08-1145, 08-1147, 08-1148, 08-1151, 08-1157, 08-1152, 09-1179, 15-2051, and 15-2064 be and they are hereby redefined to include the real property described in Section 1 hereof.

Section 6. Upon annexation, the real property described in Section 1 hereof shall continue to be zoned Commercial Intensive, the land use classification established by the Columbia County Zoning Ordinance and Comprehensive Land Use Plan until otherwise changed or amended by appropriate ordinance of the City of Lake City, Florida.

Section 7. Effective January 1, 2016 the real property described in Schedule "A" and hereby annexed to the boundaries of the City of Lake City Florida shall be assessed for payment of municipal ad valorem taxes, and shall be subject to all general and special assessments.

Section 8. All persons who have been lawfully engage in any occupation, business, trade, or profession, within the area described in Section 1 above, upon the effective date of this ordinance under a valid license or permit issued by Columbia County, Florida, and

all other necessary state or federal regulatory agencies, may continue such occupation, business, trade or profession within the entire boundaries of the City of Lake City, as herein defined, upon securing a valid occupational license from the City of Lake City, which shall be issued upon payment of the appropriate fee, without the necessity of taking or passing any additional examination or test which otherwise is required relating to the qualification of such occupations, businesses, trades, or professions.

Section 9. The City Clerk is hereby directed to file and record, within seven days of the effective date of this ordinance a certified copy of this ordinance with the following:

- a) the Clerk of Circuit Court of Columbia County;
- b) Chief Administrative Officer of Columbia County;
- c) Department of State, Tallahassee, Florida;
- d) The Property Appraiser, Columbia County;
- e) the Tax Collector, Columbia County;
- f) all Public Utilities authorized to conduct business within the City of Lake City.

Section 10. This ordinance shall be effective 11/2/2015.

PASSED upon first reading this 19th day of October 2015.

NOTICE PUBLISHED on the 23rd day of October, 2015

PASSED AND ADOPTED, upon second and final reading, in regular session with a quorum present and voting, by the City Council this 2nd day of November, 2015.

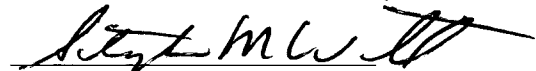
Stephen M. Witt
Mayor

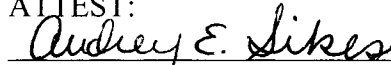
ATTEST:

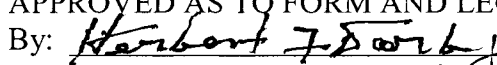
Audrey E. Sikes
City Clerk

APPROVED AS TO FORM AND LEGALITY:
By: 
HERBERT F. DARBY, City Attorney

Schedule "A"

FOR A POINT OF REFERENCE COMMENCE AT THE NORTHEAST CORNER OF THE SOUTHEAST ¼ OF THE SOUTHEAST ¼ OF SECTION 36, TOWNSHIP 3 SOUTH, RANGE 16 EAST, COLUMBIA COUNTY, FLORIDA, AND RUN THENCE SOUTH 00°55'37" EAST, ALONG THE EAST LINE OF SAID SOUTHEAST ¼ OF THE SOUTHEAST ¼, 21.10 FEET TO THE NORTH RIGHT-OF-WAY OF U.S. HIGHWAY 90 (STATE ROAD NO. 10) AND TO A POINT ON A CURVE, THENCE RUN WESTERLY ALONG SAID NORTH RIGHT-OF-WAY, ALONG THE ARC OF SAID CURVE TO THE NORTH, HAVING A RADIUS OF 4,533.66 FEET, A DELTA OF 02°28'29", A CHORD BEARING AND DISTANCE OF SOUTH 62°45'32" WEST, 195.80 FEET, AN ARC LENGTH OF 195.82 FEET TO A POINT OF TANGENCY; THENCE SOUTH 63°59'46" WEST, ALONG SAID RIGHT-OF-WAY, 821.11 FEET TO THE POINT OF BEGINNING.

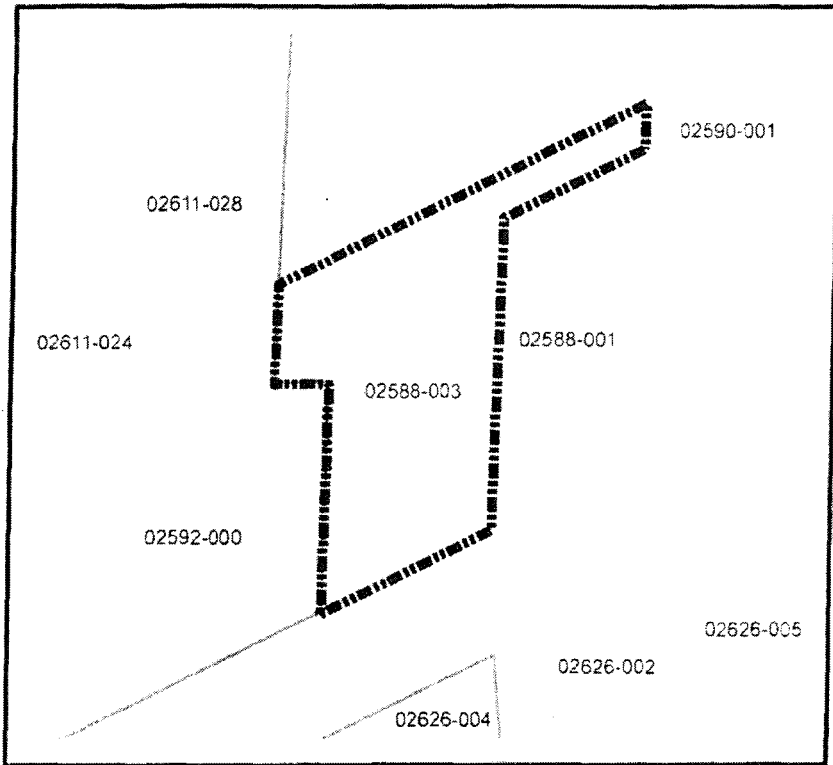
FROM THE POINT OF BEGINNING ON THE NORTH RIGHT-OF-WAY LINE OF THE SOUTHWESTERLY CORNER OF LANDS DESCRIBED AND RECORDED IN OFFICIAL RECORDS BOOK 1093, PAGE 744 OF THE PUBLIC RECORDS OF SAID COUNTY; THENCE RUN THE FOLLOWING THREE (3) COURSES AND DISTANCES ALONG THE WESTERLY LINE OF SAID OFFICIAL RECORDS BOOK 1093, PAGE 744: COURSE NO. 1, NORTH 02°29'07" EAST, 207.35 FEET; COURSE NO. 2, NORTH 89°59'41" WEST, 50.02 FEET; COURSE NO. 3, NORTH 02°29'07" EAST, 90.21 FEET TO THE NORTHWESTERLY CORNER THEREOF; THENCE NORTH 64°09'30" EAST, ALONG THE NORTHERLY LINE OF SAID OFFICIAL RECORDS BOOK 1093, PAGE 744, A DISTANCE OF 368.77 FEET TO THE NORTHEASTERLY CORNER THEREOF; THENCE SOUTH 02°29'07" WEST ALONG THE EASTERLY LINE OF SAID OFFICIAL RECORDS 1093, PAGE 744, 40.90 FEET; THENCE 64°09'30" WEST, PARALLEL TO AND 36.00 FEET SOUTHERLY OF SAID NORTHERLY LINE, WHEN MEASURED AT RIGHT ANGLES THERETO, 139.79 FEET TO A POINT; THENCE SOUTH 02°29'07" WEST, PARALLEL TO AND 123.05 FEET WESTERLY OF SAID EASTERLY LINE OF OFFICIAL RECORDS 1093, PAGE 744, WHEN MEASURED AT RIGHT ANGLES THERETO, A DISTANCE OF 280.88 FEET TO A, THENCE RUN SOUTH 63°59'46" WEST ALONG THE NORTH RIGHT OF WAY LINE A DISTANCE OF 172.48 TO THE POINT OF BEGINNING. PARCEL # 36-3S-36-02588-003 CONTAINING +/-1.35 AC.



Ordinance 2015-2066

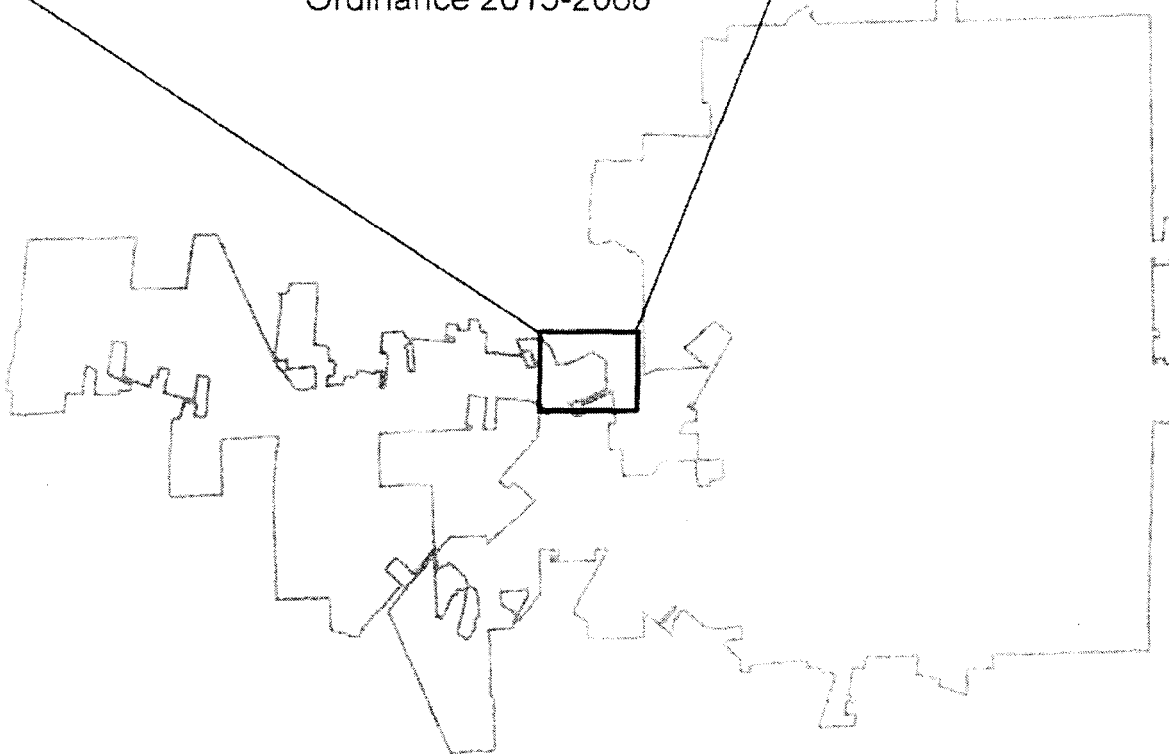

Dated this 13 day of October, 2015

[Signature]