

BE IT REMEMBERED THAT THERE WAS BEGUN AND HELD A REGULAR MEETING OF THE MAYOR AND BOARD OF ALDERMEN OF THE CITY OF PETAL, MISSISSIPPI ON MAY 5, 2020 AT 6:00 P.M. IN THE BOARDROOM OF SAID CITY.

THOSE PRESENT	MAYOR HAL MARX
ATTORNEY	ROCKY EATON
ALDERMEN	BRAD AMACKER DAVID CLAYTON TONY DUCKER CLINT MOORE STEVE STRINGER
OTHERS	RYAN JENSEN

MAYOR MARX DECLARED A QUORUM PRESENT AND DECLARED THE CITY COUNCIL IN SESSION.

THE INVOCATION WAS OFFERED BY TONY DUCKER

THE PLEDGE OF ALLEGIANCE WAS RECITED.

MAYOR MARX ANNOUNCED THAT IN COOPERATION WITH THE SAFER AT HOME ORDER IN RESPONSE TO COVID 19, AND ABIDING BY THE OPEN MEETINGS ACT THE MEETING IS BEING STREAMED VIA FACEBOOK LIVE SO THAT THE PUBLIC CAN WATCH.

WHEREAS, MAYOR MARX PRESENTED THE AGENDA WITH THE FOLLOWING AMENDMENTS

GENERAL BUSINESS

Request to approve the docket of claims for the month of April 2020.

Request to donate .05 acres of property at Dawson Cut Off to Forrest County for E Hardy St Bridge Replacement Project.

THEREUPON, ALDERMAN STRINGER MADE A MOTION TO ADOPT THE FOREGOING AGENDA AS AMENDED. ALDERMAN AMACKER SECONDED THE MOTION.

THOSE PRESENT AND VOTING "AYE"

ALDERMAN BRAD AMACKER
ALDERMAN DAVID CLAYTON
ALDERMAN TONY DUCKER
ALDERMAN CLINT MOORE
ALDERMAN STEVE STRINGER

THOSE PRESENT AND VOTING "NAY"

NONE

WHEREAS, MAYOR MARX PRESENTED THE MINUTES FROM THE REGULAR MEETING OF APRIL 21, 2020.

THEREUPON, ALDERMAN CLAYTON MADE A MOTION TO APPROVE THE MINUTES OF THE REGULAR MEETING OF APRIL 21, 2020 AS WRITTEN. ALDERMAN STRINGER SECONDED THE MOTION.

THOSE PRESENT AND VOTING "AYE"

ALDERMAN BRAD AMACKER
ALDERMAN DAVID CLAYTON
ALDERMAN TONY DUCKER
ALDERMAN CLINT MOORE
ALDERMAN STEVE STRINGER

THOSE PRESENT AND VOTING "NAY"

NONE

WHEREAS, MAYOR MARX PRESENTED A REQUEST TO CONTINUE THE PROCLAMATION OF EMERGENCY

THEREUPON, ALDERMAN STRINGER MADE A MOTION TO CONTINUE THE PROCLAMATION OF EMERGENCY UNTIL FURTHER NOTICE. ALDERMAN CLAYTON SECONDED THE MOTION.

THOSE PRESENT AND VOTING "AYE"

ALDERMAN BRAD AMACKER
ALDERMAN DAVID CLAYTON
ALDERMAN TONY DUCKER
ALDERMAN CLINT MOORE
ALDERMAN STEVE STRINGER

THOSE PRESENT AND VOTING "NAY"

NONE

WHEREAS, MAYOR MARX PRESENTED THE FOLLOWING RESOLUTION CALLING FOR A SPECIAL ELECTION.

EXHIBIT "A"

RESOLUTION

THEREUPON, ALDERMAN MOORE MADE A MOTION TO ADOPT THE FOREGOING RESOLUTION CALLING A SPECIAL ELECTION. ALDERMAN STRINGER SECONDED THE MOTION.

THOSE PRESENT AND VOTING "AYE"

ALDERMAN BRAD AMACKER
ALDERMAN DAVID CLAYTON
ALDERMAN TONY DUCKER
ALDERMAN CLINT MOORE
ALDERMAN STEVE STRINGER

THOSE PRESENT AND VOTING "NAY"

NONE

WHEREAS, MAYOR MARX PRESENTED A REQUEST TO REFUND CASH BOND TO CHRISTOPHER LEVI WATKINS

THEREUPON, ALDERMAN AMACKER MADE A MOTION TO AUTHORIZE THE REFUND OF A CASH BOND TO CHRISTOPHER LEVI WATKINS PER JUDGE REED'S ORDER. ALDERMAN STRINGER SECONDED THE MOTION.

THOSE PRESENT AND VOTING "AYE"

ALDERMAN BRAD AMACKER
ALDERMAN DAVID CLAYTON
ALDERMAN TONY DUCKER
ALDERMAN CLINT MOORE
ALDERMAN STEVE STRINGER

THOSE PRESENT AND VOTING "NAY"

NONE

WHEREAS, MAYOR MARX PRESENTED THE RESIGNATION OF MARK ARMSTRONG IN THE STREET DEPT

THEREUPON, ALDERMAN STRINGER MADE A MOTION TO ACCEPT THE RESIGNATION OF MARK ARMSTRONG IN THE STREET DEPT EFFECTIVE MAY 5, 2020. ALDERMAN MOORE SECONDED THE MOTION.

THOSE PRESENT AND VOTING "AYE"

ALDERMAN BRAD AMACKER
ALDERMAN DAVID CLAYTON
ALDERMAN TONY DUCKER
ALDERMAN CLINT MOORE
ALDERMAN STEVE STRINGER

THOSE PRESENT AND VOTING "NAY"

NONE

WHEREAS, MAYOR MARX PRESENTED THE FOLLOWING PROOFS OF PUBLICATION

- AD FOR BIDS – 2020 OVERLAY

THEREUPON, ALDERMAN STRINGER MADE A MOTION TO ACCEPT THE PROOFS OF PUBLICATION FOR FILING. ALDERMAN AMACKER SECONDED THE MOTION.

THOSE PRESENT AND VOTING "AYE"

ALDERMAN BRAD AMACKER
ALDERMAN DAVID CLAYTON
ALDERMAN TONY DUCKER
ALDERMAN CLINT MOORE
ALDERMAN STEVE STRINGER

THOSE PRESENT AND VOTING "NAY"

NONE

WHEREAS, MAYOR MARX PRESENTED THE REVENUE & EXPENDITURES REPORT FOR THE MONTH OF MARCH 2020.

THEREUPON, ALDERMAN CLAYTON MADE A MOTION TO ACCEPT THE REVENUE & EXPENDITURES REPORT FOR THE MONTH OF MARCH 2020. ALDERMAN DUCKER SECONDED THE MOTION.

THOSE PRESENT AND VOTING "AYE"

ALDERMAN BRAD AMACKER
ALDERMAN DAVID CLAYTON
ALDERMAN TONY DUCKER
ALDERMAN CLINT MOORE
ALDERMAN STEVE STRINGER

THOSE PRESENT AND VOTING "NAY"

NONE

WHEREAS, MAYOR MARX PRESENTED THE FY2019 CONTINUING DISCLOSURE STATEMENT.

EXHIBIT "B"

2019 CONT. DISC. STMT.

THEREUPON, ALDERMAN STRINGER MADE A MOTION TO ACCEPT THE FY2019 CONTINUING DISCLOSURE STATEMENT. ALDERMAN CLAYTON SECONDED THE MOTION.

THOSE PRESENT AND VOTING "AYE"

ALDERMAN BRAD AMACKER
ALDERMAN DAVID CLAYTON
ALDERMAN TONY DUCKER
ALDERMAN CLINT MOORE
ALDERMAN STEVE STRINGER

THOSE PRESENT AND VOTING "NAY"

NONE

WHEREAS, MAYOR MARX PRESENTED A REQUEST TO REMOVE (1) ALTAIR 4X MONITOR FROM WATER DEPT INVENTORY

THEREUPON, ALDERMAN STRINGER MADE A MOTION TO REMOVE (1) ALTAIR 4X MONITOR, ASSET #02671, FROM WATER DEPT INVENTORY. ALDERMAN DUCKER SECONDED THE MOTION.

THOSE PRESENT AND VOTING "AYE"

ALDERMAN BRAD AMACKER
ALDERMAN DAVID CLAYTON
ALDERMAN TONY DUCKER
ALDERMAN CLINT MOORE
ALDERMAN STEVE STRINGER

THOSE PRESENT AND VOTING "NAY"

NONE

WHEREAS, MAYOR MARX PRESENTED A REQUEST TO FURLOUGH MICHAEL MOTT IN THE RECREATION DEPT

THEREUPON, ALDERMAN STRINGER MADE A MOTION TO FURLOUGH MICHAEL MOTT IN THE RECREATION DEPT DUE TO UNKNOWN CONDITIONS SURROUNDING COVID 19. ALDERMAN CLAYTON SECONDED THE MOTION.

THOSE PRESENT AND VOTING "AYE"

ALDERMAN BRAD AMACKER
ALDERMAN DAVID CLAYTON
ALDERMAN TONY DUCKER
ALDERMAN CLINT MOORE
ALDERMAN STEVE STRINGER

THOSE PRESENT AND VOTING "NAY"

NONE

WHEREAS, MAYOR MARX PRESENTED A REQUEST TO FURLOUGH JOYCE TISDALE IN THE SENIOR CENTER

THEREUPON, ALDERMAN MOORE MADE A MOTION TO FURLOUGH JOYCE TISDALE IN THE SENIOR CENTER DUE TO UNKNOWN CONDITIONS SURROUNDING COVID 19. ALDERMAN STRINGER SECONDED THE MOTION.

THOSE PRESENT AND VOTING "AYE"

ALDERMAN BRAD AMACKER
ALDERMAN DAVID CLAYTON
ALDERMAN TONY DUCKER
ALDERMAN CLINT MOORE
ALDERMAN STEVE STRINGER

THOSE PRESENT AND VOTING "NAY"

NONE

WHEREAS, MAYOR MARX PRESENTED THE DOCKET OF CLAIMS FOR THE MONTH OF APRIL 2020.

EXHIBIT "C"

DOCKET

THEREUPON, ALDERMAN CLAYTON MADE A MOTION TO AUTHORIZE THE CITY CLERK TO PAY THE DOCKET OF CLAIMS FOR THE MONTH OF APRIL 2020. ALDERMAN MOORE SECONDED THE MOTION.

THOSE PRESENT AND VOTING "AYE"

ALDERMAN BRAD AMACKER
ALDERMAN DAVID CLAYTON
ALDERMAN TONY DUCKER
ALDERMAN CLINT MOORE
ALDERMAN STEVE STRINGER

THOSE PRESENT AND VOTING "NAY"

NONE

WHEREAS, MAYOR MARX PRESENTED A REQUEST TO DONATE .05 ACRES OF LAND TO FORREST COUNTY FOR EAST HARDY ST BRIDGE REPLACEMENT PROJECT.

EXHIBIT "D"

DEED

THEREUPON, ALDERMAN MOORE MADE A MOTION TO AUTHORIZE THE MAYOR TO EXECUTE THE FOREGOING DEED DONATING PROPERTY TO FORREST COUNTY FOR EAST HARDY ST BRIDGE REPLACEMENT PROJECT. ALDERMAN CLAYTON SECONDED THE MOTION.

THOSE PRESENT AND VOTING "AYE"

ALDERMAN BRAD AMACKER
ALDERMAN DAVID CLAYTON
ALDERMAN TONY DUCKER
ALDERMAN CLINT MOORE
ALDERMAN STEVE STRINGER

THOSE PRESENT AND VOTING "NAY"

NONE

WHEREAS, MAYOR MARX PRESENTED THE FOLLOWING ORDINANCE GRANTING A FRANCHISE AGREEMENT TO MS POWER

EXHIBIT "E"

ORDINANCE 2020 (142)

THEREUPON, ALDERMAN CLAYTON MADE A MOTION TO ADOPT THE FOREGOING ORDINANCE. ALDERMAN AMACKER SECONDED THE MOTION.

THOSE PRESENT AND VOTING "AYE"

ALDERMAN BRAD AMACKER
ALDERMAN DAVID CLAYTON
ALDERMAN TONY DUCKER
ALDERMAN CLINT MOORE
ALDERMAN STEVE STRINGER

THOSE PRESENT AND VOTING "NAY"

NONE

WHEREAS, MAYOR MARX PRESENTED THE FOLLOWING ORDER TRANSFERRING RUSSELL HARPER FROM THE SENIOR CENTER TO THE RECREATION DEPT

ORDER

WHEREAS THE MAYOR AND BOARD OF ALDERMEN
OF THE CITY OF PETAL DEEM IT NECESSARY TO
TRANSFER RUSSELL HARPER

IT IS HEREBY ORDERED THAT RUSSELL HARPER
BE TRANSFERRED TO THE RECREATION DEPT
EFFECTIVE MAY 6, 2020

SO ORDERED THIS THE 5TH DAY OF MAY 2020

THEREUPON, ALDERMAN STRINGER MADE A MOTION TO ADOPT THE FOREGOING ORDER. ALDERMAN AMACKER SECONDED THE MOTION.

THOSE PRESENT AND VOTING "AYE"

ALDERMAN BRAD AMACKER
ALDERMAN DAVID CLAYTON
ALDERMAN TONY DUCKER
ALDERMAN CLINT MOORE
ALDERMAN STEVE STRINGER

THOSE PRESENT AND VOTING "NAY"

NONE

THEREUPON, ALDERMAN MOORE MADE A MOTION TO CLEAR THE ROOM TO DETERMINE THE NEED FOR EXECUTIVE SESSION. ALDERMAN AMACKER SECONDED THE MOTION.

THOSE PRESENT AND VOTING "AYE"

ALDERMAN BRAD AMACKER
ALDERMAN DAVID CLAYTON
ALDERMAN TONY DUCKER
ALDERMAN CLINT MOORE
ALDERMAN STEVE STRINGER

THOSE PRESENT AND VOTING "NAY"

NONE

THEREUPON, ALDERMAN MOORE MADE A MOTION TO ENTER INTO EXECUTIVE SESSION. ALDERMAN AMACKER SECONDED THE MOTION.

THOSE PRESENT AND VOTING "AYE"

ALDERMAN BRAD AMACKER
ALDERMAN DAVID CLAYTON
ALDERMAN TONY DUCKER
ALDERMAN CLINT MOORE
ALDERMAN STEVE STRINGER

THOSE PRESENT AND VOTING "NAY"

NONE

THEREUPON, ALDERMAN MOORE MADE A MOTION TO ADJOURN THE EXECUTIVE SESSION. ALDERMAN AMACKER SECONDED THE MOTION.

THOSE PRESENT AND VOTING "AYE"

ALDERMAN BRAD AMACKER
ALDERMAN DAVID CLAYTON
ALDERMAN TONY DUCKER
ALDERMAN CLINT MOORE
ALDERMAN STEVE STRINGER

THOSE PRESENT AND VOTING "NAY"

NONE

NO OFFICIAL ACTION WAS TAKEN IN EXECUTIVE SESSION.

WHEREAS, MAYOR MARX PRESENTED THE RESIGNATION OF DALTON HIATT IN THE WATER DEPT

THEREUPON, ALDERMAN MOORE MADE A MOTION TO ACCEPT THE RESIGNATION OF DALTON HIATT IN THE WATER DEPT EFFECTIVE MAY 19, 2020. ALDERMAN AMACKER SECONDED THE MOTION.

THOSE PRESENT AND VOTING "AYE"

ALDERMAN BRAD AMACKER
ALDERMAN DAVID CLAYTON
ALDERMAN TONY DUCKER
ALDERMAN CLINT MOORE
ALDERMAN STEVE STRINGER

THOSE PRESENT AND VOTING "NAY"

NONE

THEREUPON, ALDERMAN MOORE MADE A MOTION TO ADJOURN THE REGULAR MEETING OF MAY 5, 2020. ALDERMAN STRINGER SECONDED THE MOTION.

THOSE PRESENT AND VOTING "AYE"

ALDERMAN BRAD AMACKER
ALDERMAN DAVID CLAYTON
ALDERMAN TONY DUCKER
ALDERMAN CLINT MOORE
ALDERMAN STEVE STRINGER

THOSE PRESENT AND VOTING "NAY"

NONE

THERE BEING NO FURTHER BUSINESS, THE REGULAR MEETING OF THE MAYOR AND BOARD OF ALDERMEN OF THE CITY OF PETAL, MISSISSIPPI WAS ADJOURNED.



Melissa Martin
MELISSA MARTIN, CITY CLERK

Idal Marx
MAYOR MARX

RESOLUTION CALLING A SPECIAL ELECTION

A RESOLUTION CALLING A SPECIAL ELECTION TO BE HELD IN THE MUNICIPALITY OF PETAL, MISSISSIPPI ON Tuesday, the 5th day of May, 2020, FOR THE PURPOSE OF SUBMITTING TO THE QUALIFIED ELECTORS OF THE MUNICIPALITY OF PETAL, MISSISSIPPI, THE APPROVAL OR DISAPPROVAL OF THE ACTION OF THE BOARD OF ALDERMEN IN ADOPTING ON THE 5th day of May, 2020, AN ORDINANCE GRANTING NON-EXCLUSIVE ELECTRIC FRANCHISE TO MISSISSIPPI POWER COMPANY, ITS SUCCESSORS, AND ASSIGNS A FRANCHISE IN THE MUNICIPALITY OF PETAL, MISSISSIPPI.

WHEREAS, on the 7th day of April, 2020, at a regular meeting of the Board of Aldermen of Petal, Mississippi, an ordinance was introduced entitled "AN ORDINANCE GRANTING A NON-EXCLUSIVE ELECTRIC FRANCHISE TO MISSISSIPPI POWER COMPANY, ITS SUCCESSORS, AND ASSIGNS, IN THE MUNICIPALITY OF PETAL, MISSISSIPPI," which said ordinance has, pursuant to an order of the body, remained on file for public inspection for two weeks as provided by law, and

WHEREAS, on the 5th day of May, 2020, the said ordinance was passed by said Board of Aldermen in the form in which it was introduced, subject to publication thereof as provided by law and subject to the approval by the majority of the qualified electors voting thereon at a special election as provided for by law, and

WHEREAS, the Board of Aldermen find that it is necessary to call a special election in order to refer the action of the Board of Aldermen in the passage of the said ordinance to the approval or disapproval of the electors of said Municipality of Petal, and

WHEREAS, it is provided by law that whenever any measure or ordinance is to be referred to the qualified electors of the municipality for their approval or disapproval, it shall be the duty of the Board of Aldermen to have such measure or ordinance printed in at least one daily or weekly newspaper published for at least once a week for three weeks next preceding the date of the special election in a newspaper published in such municipality, and

WHEREAS, the Hattiesburg American is a newspaper published in the Municipality of Petal, Mississippi.

NOW, THEREFORE, BE IT RESOLVED by the Board of Aldermen of the Municipality of Petal, County of Forrest, State of Mississippi, as follows:

SECTION 1 That a special election shall be held in all municipal precincts in the Municipality of Petal, Mississippi, on the 1st day of June, 2020, for the purpose of submitting to the qualified electors of the Municipality of Petal, Mississippi, for their approval or disapproval, the action of the Board of Aldermen in adopting an ordinance entitled, "AN ORDINANCE GRANTING A NON-EXCLUSIVE ELECTRIC FRANCHISE TO MISSISSIPPI POWER COMPANY, ITS SUCCESSORS, AND ASSIGNS, IN THE MUNICIPALITY OF PETAL, MISSISSIPPI."

FF3-1

RESOLUTION AND ORDER FOR POSTPONEMENT OF SPECIAL RUN OFF ELECTION

Whereas, an election having occurred for Aldermen At Large in the City of Petal, MS on March 17, 2020 resulted in the need for a Run Off Election

IT IS HEREBY ORDERED THAT pursuant to Mississippi Code Annotated Section 23-35-857, On the 7th day of April, 2020, a special municipal run off election was previously scheduled to be held in the City of Petal, Forrest County, Mississippi for the purpose of electing an Alderman At Large to fill the vacancy left as a result of the resignation of one of the duly elected city officials of the City of Petal, MS

IT IS HEREBY FURTHER ORDERED THAT pursuant to COVID-19 pandemic and resulting Stay at-home orders issued by the Governor of the State of Mississippi, this scheduled Special run off election has been postponed until June 1, 2020

SO RESOLVED, ORDERED AND DIRECTED by the Mayor and Board of Aldermen Of the City of Petal, Mississippi on this 5th day of May, 2020

Mayor, Hattiesburg

City Clerk, Melissa Martin

Said polling places will be open from the hour of seven o'clock a.m. until the hour of seven o'clock p.m. on said day. All qualified electors may vote at said election.

Said special election will be held pursuant to a Resolution of the Board of Aldermen, adopted on the 5th day of May, 2020, calling a special election for the approval or disapproval of a majority of the qualified electors of the Municipality of Petal, Mississippi of the action of the Board of Aldermen in adopting an ordinance entitled, "AN ORDINANCE GRANTING A NON-EXCLUSIVE ELECTRIC FRANCHISE TO MISSISSIPPI POWER COMPANY, ITS SUCCESSORS, AND ASSIGNS, IN THE MUNICIPALITY OF PETAL, MISSISSIPPI."

A copy of said ordinance and proceedings whereby same was adopted is attached hereto as part of this notice.

Done by order of the Board of Aldermen, this 5th day of May, 2020

Melissa Martin
Clerk, Municipality of Petal, Mississippi

SECTION 6 That a certified copy of the Resolution shall be prepared by the Clerk of the Municipality of Petal and shall be delivered to the Election Commissioners of the Municipality of Petal, Mississippi, and shall operate as a warrant and authority to the Election Commissioners in the holding of such special election on the date herein fixed.

SECTION 7 The Election Commissioners shall duly certify to the Board of Aldermen of Petal, Mississippi, the result of the election as required by law.

Passed by the Board of Aldermen on this 5th day of May, 2020

The above Resolution was introduced by Alderman Moore, seconded by Alderman Swinger, and the following vote was taken: Alderman Amacher "AYE", Alderman Clayton "AYE", Alderman Duster "AYE", Alderman Moore "AYE", and Alderman Swinger "AYE".

The Mayor then declared the Resolution adopted on the 5th day of May, 2020

FF3-3

SECTION 2 That the said election shall be held at the usual voting places in all of the precincts and within the hours prescribed by law.

SECTION 3 That the Election Commissioners of the Municipality of Petal, Mississippi, shall cause to be prepared a ballot to be used in said special election in substantially the following form:

PROPOSITION

Do you approve or disapprove the action of the Board of Aldermen of the Municipality of Petal, Mississippi, in adopting an ordinance entitled, "AN ORDINANCE GRANTING A NON-EXCLUSIVE ELECTRIC FRANCHISE TO MISSISSIPPI POWER COMPANY, ITS SUCCESSORS, AND ASSIGNS, IN THE MUNICIPALITY OF PETAL, MISSISSIPPI," whereby an electric franchise was granted to Mississippi Power Company, its successors, and assigns, as per the terms of said ordinance which was adopted by the Board of Aldermen on the 5th day of May, 2020.

FOR APPROVAL OF SAID ORDINANCE ()
AGAINST APPROVAL OF SAID ORDINANCE ()

(Instructions to voters: Place a check (x) mark opposite your choice.)

SECTION 4 That said election shall be held and conducted by the Election Commissioners of the Municipality of Petal in all respects in accordance with law, and as far as practicable, as other elections are held in said Municipality of Petal and returns thereof made as provided by law.

SECTION 5 That the Clerk of said Municipality of Petal, Mississippi, shall give not less than twenty-one (21) days' notice of said special election on said electric franchise by posting notice thereof in three public places within the municipality, and by publication in the Hattiesburg American. Said notice shall be in substantially the following form:

NOTICE OF SPECIAL ELECTION OF ELECTRIC FRANCHISE MUNICIPALITY OF PETAL, MISSISSIPPI

Notice is hereby given to the qualified electors of the Municipality of Petal, Mississippi, that a special election shall be held in the Municipality of Petal, on the 1st day of June, 2020, on the following proposition:

PROPOSITION

Do you approve or disapprove the action of the Board of Aldermen of the Municipality of Petal, Mississippi, in adopting an ordinance entitled, "AN ORDINANCE GRANTING A NON-EXCLUSIVE ELECTRIC FRANCHISE TO MISSISSIPPI POWER COMPANY, ITS SUCCESSORS, AND ASSIGNS, IN THE MUNICIPALITY OF PETAL, MISSISSIPPI," whereby an electric franchise was granted to Mississippi Power Company, its successors, and assigns, as per the terms of said ordinance which was adopted by the Board of Aldermen on the 5th day of May, 2020.

Said election will be held at the usual voting places in all precincts of the Municipality of Petal.

FF3-2

STATE OF MISSISSIPPI
COUNTY OF FORREST
MUNICIPALITY OF PETAL

I, Melissa Martin, Clerk of the Municipality of Petal, Mississippi, hereby certify that the foregoing resolution was passed by the Board of Aldermen on the 5th day of May, 2020, as same appears on the Minutes of the Board of Aldermen of Petal, Mississippi, Minute Book ___ of pages ___

Given under my hand and official seal, this ___ day of _____, 2020

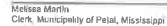
Melissa Martin
Clerk, Municipality of Petal, Mississippi

FF3-4

APPENDIX A
ECONOMIC AND DEMOGRAPHIC INFORMATION
FISCAL YEAR 2019
THE CITY OF PETAL, MISSISSIPPI

General Description

The City of Petal (the "City") is located in the northern section of Forrest County, Mississippi, which is located in the southeast portion of the State of Mississippi (the "State"). The City, incorporated April 5, 1974, is located on the Leaf River adjacent to the corporate limits of the City of Hattiesburg, Mississippi. The City lies approximately 91 miles south of Jackson, the capital of the State, 120 miles northeast of New Orleans, Louisiana, and 100 miles northwest of Mobile, Alabama.

Population

The population of the City has been recorded as follows:

Year	2009	2010	2018 Estimate
2009	7,583	7,370	10,434
2018 Estimate			10,674

SOURCE: Census data at website: www.census.gov; February 2020.

Government¹

The City operates under the Mayor-Board of Aldermen form of government. The governing body of the City consists of five Board members, all of whom are elected from separate wards. The Mayor, who is elected at large, and members of the Board of Aldermen are elected for concurrent four year terms. The current Mayor and members of the Board of Aldermen whose terms expire July, 2021, are:

Name	Occupation	Position Held Since
Hal Marx	Mayor	2009
William King	Retired	2013
David Clayton	Business Owner	2005
Shawn Slinger	Business Owner	2001
Clint Moore	Business Owner	2014
Brad Amacker	Teacher	2013
Tony Ducker	Small Business Owner (Insurance sales)	2013
Craig Bullock	Small Business Owner (screen printing)	2013

Transportation

Access to the City is available by several means. Interstate Highway 59, U.S. Highways 11, 49 and 98 and State Highway 42 serve the immediate area. A number of County highways provide access to many outlying areas in the County.

¹ As of March 2020.

Banking Institutions

Institution	2019 Total Assets
BancorpSouth Bank ²	\$ 19,662,064,000
First Southern Bank ³	195,772,000
Grand Bank for Savings, a Federal Savings Bank ⁴	85,956,000
Homebank Whitney Bank ⁵	30,519,420,000
Regions Bank ⁶	1,171,341,000,000
Truistmark National Bank ⁷	13,582,728,000
Magnolia State Bank ⁸	336,434,000

SOURCE: Obtained from FDIC's website: <https://www.fdic.gov>, unless otherwise noted; Assets are stated as of September 30, 2019; February 2020.

Educational Facilities

The Petal School District (the "District") serves the entire City and consists of one primary school, two elementary schools, one middle school and one high school, and employs approximately 372 people.

Enrollment figures for the District for the current scholastic year and the four preceding years are as follows:

Scholastic Year	Enrollment
2019-20	4,169
2018-19	4,137
2017-18	4,069
2016-17	4,112
2015-16	4,091

SOURCE: Petal School District and Office of the Superintendent, and Office of Research and Statistics, Mississippi Department of Education's website: www.msde.ms.gov; February 2020.

² Main office located in Toledo, Mississippi.
³ Main office located in Columbus, Mississippi.
⁴ Main office located in Hattiesburg, Mississippi.
⁵ Main office located in Gulfport, Mississippi.
⁶ Main office is located in Birmingham, Alabama.
⁷ Main office located in Jackson, Mississippi.
⁸ Main office located in Bay Springs, Mississippi.

Rail service is provided to the City by the Illinois Central Gulf Railroad and the Norfolk Southern Railway. Numerous motor freight carriers are authorized to serve the City, as it is in the City of Hattiesburg, Mississippi commercial delivery zone. The nearest commercial airport is New Orleans International Airport, 100 miles southwest of the City. Commuter air service is available to residents of the City at Pine Belt Regional Airport, seven miles from the City, and Hattiesburg Airport, three miles from the City. The nearest port is the Port of Gulfport, which has a channel depth of 30 feet and is located 73 miles distant in Harrison County.

Per Capita Income

Year	County	Mississippi	United States	County as % of U.S.
2018	\$28,800	\$37,834	\$34,488	71%
2017	27,201	36,375	31,885	73%
2016	26,793	36,612	49,870	76%
2015	26,294	35,022	48,978	74%
2014	25,092	34,545	47,058	76%

SOURCE: Bureau of Economic Analysis, *Regional Economic Accounts - Per Capita Personal Income*, (data last updated November 14, 2019), February 2020.

Major Employers

The following is a listing of the City's major employers, their products or services and their approximate number of employees:

Employer	Employees	Product/Service
Petal School District	533	Education
Wal-Mart	261	Retail
Service Master Co.	174	Cleaning & Maintenance Services
Lowe's Home Improvement	160	Retail
Fahrline Logistics	95	Transportation/Trucking
Pierce Construction & Maintenance	80	Manufacturing
Child's Grill & Bar	73	Restaurants
Corner Market	38	Grocery/Retail
The State Environmental LLC	20	Environmental Services
Diversified CPC International Inc.	20	Manufacturing

SOURCE: Petal Area Chamber of Commerce, March 2020.

TAX INFORMATION

Assessed Valuations¹

Assessment Year	Real Property	Personal Property ²	Public Utility Property	Total
2019	\$70,417,146	\$23,593,852	\$2,697,027	\$107,008,025
2018	66,408,840	24,500,222	2,667,082	108,536,000
2017	63,476,315	26,374,453	2,548,243	107,099,011
2016	62,330,056	27,076,598	2,115,990	101,482,644
2015	57,777,314	33,422,394	2,097,217	93,207,925

SOURCE: Office of the City Clerk; March 2020.

Assessed valuations are based upon the following assessment ratios:

Real and personal property (excluding single-family owner-occupied residential real property and motor vehicles, respectively), 15 percent of true value;

Single-family owner-occupied residential real property, 10 percent of true value; and

Motor vehicles and public utility property, 30 percent of true value.

The 1986 Session of the Mississippi Legislature adopted House Concurrent Resolution No. 41 (the "Resolution"), pursuant to which there was proposed an amendment to the Mississippi Constitution of 1890 (the "Amendment"). The Amendment provided, *inter alia*, that the assessment ratio of any one class of property shall not be more than three times the assessment ratio on any other class of property.

The Amendment set forth five classes of property and the assessment ratios which would be applicable thereto upon the adoption of the Amendment. The assessment ratios set forth in the Amendment are identical to those established by Section 21-33-9, Mississippi Code of 1972, as it existed prior to the Amendment, except that the assessment ratio for single-family owner-occupied residential real property under the Amendment is set at 10 percent of true value as opposed to 15 percent of true value under previously existing law.

Procedure for Property Assessments

The Tax Assessor of Forrest County assesses all real and personal property subject to taxation in the County, including property in the City, except motor vehicles and public utility property, both of which are required by law to be assessed by the Mississippi Department of Revenue, formerly the State Tax Commission (the "Department of Revenue").

Section 21-33-9, Mississippi Code of 1972, as amended, provides that the governing authorities of a municipality which is located within a county having completed a county-wide reappraisal approved by the Department of Revenue and which has been furnished a new copy of that part of the county assessment roll containing the property located within a municipality as provided in Section 21-33-16G, Mississippi Code of 1972,

¹ The total assessed valuation is approved in September preceding the Fiscal Year of the City and represents the value of real property, personal property and public utility property for the year indicated on which taxes are assessed for the following Fiscal Year's budget. For example, the taxes for the assessed valuation figures for 2019 will be collected starting in January 2020 for the 2019-20 Fiscal Year budget of the City.
² Includes motor vehicles and public utility property.

Retail Sales

State Fiscal Year Ended June 30	Amount
2019	\$212,970,348
2018	201,655,194
2017	194,183,041
2016	187,953,614
2015	184,052,956

SOURCE: Annual Report for each year shown, Mississippi Department of Revenue's website: www.dor.ms.gov; February 2020.

Unemployment Statistics of the County

Year	Jan.	Feb.	Mar.	Apr.	May	Jun.	Jul.	Aug.	Sep.	Oct.	Nov.	Dec.	Annual Average
2012	8.0	7.5	7.3	6.8	8.0	8.5	8.2	7.8	7.1	6.8	6.3	6.4	7.4
2015	6.8	6.3	5.9	5.8	6.6	7.3	7.0	6.2	6.0	5.8	5.6	6.0	6.3
2016	6.1	5.7	5.5	5.3	6.0	6.9	6.4	5.8	5.6	5.3	5.0	5.2	5.7
2017	5.5	4.9	4.7	4.3	5.2	6.0	5.7	4.9	4.4	4.1	4.0	4.1	4.8
2018	4.7	4.5	4.4	4.2	4.7	5.4	5.1	4.3	4.0	4.0	3.8	4.2	4.4
2019	4.7	4.4	4.3	4.4	4.7	5.7	5.9	5.4	5.2	4.7	4.9	4.6	4.9

SOURCE: Mississippi Department of Employment Security, Labor Market Data at website: www.mdes.ms.gov; February 2020.

as amended, shall adopt such assessment rolls for its assessment purposes. The City is utilizing the assessment rolls of the County.

The City may not correct or revise such assessment rolls except for the purpose of conforming the municipal assessment roll to corrections or revisions made to the County assessment roll. All objections to the municipal assessment roll may be heard by the Board of Supervisors of the County at the time and in the manner that objections to the County assessment roll are heard. The Board of Supervisors shall notify, in writing, the Governing Body and the Tax Assessor of the City of any corrections or revisions made by it to the part of the County assessment roll adopted as the municipal assessment roll.

Tax Levy per \$1,000 Valuation¹

	2016-17	2017-18	2018-19	2019-20
General Purpose	23.16	23.18	23.18	23.17
Library Fund	0.31	0.33	0.34	0.35
2019 Bonds	1.00	2.04	2.10	0.00
S2-S G.O. Bonds	0.00	0.00	0.00	2.10
S2-S G.O. Bonds	1.54	3.76	3.78	3.78
Solid Waste	0.00	0.00	0.00	0.00
Total	46.21	46.21	46.21	46.21
Petal Separate School Districts				
SSD DVM	55.00	55.00	55.00	55.00
School Bus	4.92	4.92	2.25	2.16
Special Levy	0.00	0.00	4.48	4.35
School Bus	1.20	1.24	0.84	0.30
Total	61.83	61.26	60.57	62.02
Grand Total	107.83	107.47	106.78	108.23

SOURCE: Office of the City Clerk; March 2020.

¹ Tax levy figures are given in mills.

County Employment Statistics

	2014	2015	2016	2017	2018
RESIDENCE BASED EMPLOYMENT					
I. Civilian Labor Force	32,340	32,480	33,430	33,700	33,770
II. Unemployed	2,290	2,640	1,910	1,620	1,500
III. Employed	29,950	30,820	31,520	32,070	32,270
ESTABLISHMENT BASED EMPLOYMENT					
I. Manufacturing	3,750	3,240	3,420	3,570	3,620
II. Non-manufacturing	30,770	37,570	38,030	38,500	38,650
A. Agriculture, Forestry, Fishing & Hunting	80	70	70	60	60
B. Mining	120	110	40	70	70
C. Utilities	430	490	500	470	480
D. Construction	1,400	1,320	1,370	1,370	1,490
E. Wholesale Trade	1,330	1,320	1,310	1,430	1,570
F. Retail Trade	4,070	4,000	4,010	3,900	3,860
G. Transportation & Warehousing	1,370	1,490	1,800	1,980	1,930
H. Information	760	400	180	310	740
I. Finance & Insurance	1,160	1,110	1,080	1,130	1,100
J. Real Estate, Rental & Leasing	460	460	520	540	520
K. Professional, Scientific & Technical Services	820	780	810	780	790
L. Management of Companies & Enterprises	520	470	770	820	920
M. Administrative Support & Waste Management	2,570	2,800	2,870	3,260	3,140
N. Educational Services	580	610	640	670	680
O. Health Care & Social Assistance	8,110	8,420	8,320	8,480	8,570
P. Arts, Entertainment & Recreation	340	360	360	370	370
Q. Accommodation & Food Service	3,580	3,550	3,670	3,780	4,140
R. Other Services (except Public Administration)	710	690	660	650	690
S. Government	11,760	11,190	11,140	11,440	11,430
Education	4,820	4,810	4,710	4,620	4,780
III Total Nonagricultural Employment	40,070	40,760	41,450	42,330	42,750

SOURCE: Mississippi Department of Employment Security (MDES)'s Annual Annual Labor Employment and Unemployment Statistics Report, Labor Market Information Department at website: www.mdes.ms.gov; Information last revised by MDES on May 5, 2019 (available as of February 2020).

All Valorem Tax Collections

Fiscal Year September 30	Amount Budgeted	Amount Collected	Difference Over/Under
2018	\$3,800,000	\$3,822,365	\$22,365
2019	3,700,000	3,770,794	70,794
2017	3,981,000	4,061,752	80,752
2016	3,120,000	3,211,210	91,210
2015	2,910,000	3,104,993.81	194,993.81

SOURCE: Office of the City Clerk; March 2020.

Procedure for Tax Collections

The Governing Body is required to levy a special tax upon all of the taxable property within the geographical limits of the City each year sufficient to provide for the payment of the principal of and interest on the City's general obligation bonds, including the bonds. If any taxpayer neglects or refuses to pay his taxes on the due date thereof, the unpaid taxes bear interest at the rate of 1 percent per month or fraction thereof from the delinquency date to the date of payment of such taxes. When enforcement officers take action to collect delinquent taxes, other fees, penalties and costs may accrue. Both real property and personal property are subject to public tax sale.

Section 21-33-6, Mississippi Code of 1972, as may be amended from time to time, and related statutes provide that after the fifth day of February and after the fifth day of September in each year, the tax collector for each municipality shall advertise all lands in such municipality on which all the taxes due and amounts have not been paid, as well as all land liable for sale on the first Monday of April or the third Monday of September following, as the case may be.

Reappraisal of Property and Limitation on All Valorem Taxes

Senate Bill No. 2672, General Laws of Mississippi, Regular Session 1980, codified in part as Sections 27-35-49 and 27-35-50, Mississippi Code of 1972 (the "Reappraisal Act"), provides that all real and personal property in the State shall be reappraised at true value and assessed in proportion to true value. To insure that property taxes do not increase dramatically as the counties complete reappraisals, the Reappraisal Act provides for the limit on increase in tax revenues discussed below.

The statute limits all valorem tax levies by the City subsequent to October 1, 1980, to a rate which will result in an increase in total receipts of not greater than ten percent (10%) over the previous year's receipts, excluding revenue from valorem taxes on any newly constructed properties, any existing properties added to the tax rolls or any properties previously exempt which were not assessed in the most preceding year. This limitation does not apply to levies for the payment of the principal of and the interest on general obligation bonds issued by the City or to certain other specified levies. The limitation may be increased only if the proposed increase is approved by a majority of those voting in an election held on such question.

On September 20, 1980, the Mississippi Supreme Court rendered its decision in *State Tax Commission v. Condon*, 387 So.2d 712, affirming the decree of the Chancery Court of the First Judicial District of Hinds County, Mississippi, wherein the Department of Revenue was enjoined from assessing and approving assessment rolls for any county in the State for the year 1983 unless the Department of Revenue equated the assessment rolls of all of the counties. The Mississippi Supreme Court reversed that part of the lower court's decision which enjoined the Department of Revenue from assessing and approving assessment rolls for any county in the State for the year 1983 unless the Department of Revenue equated the assessment rolls of all of the counties. The Mississippi Supreme Court's decision was affirmed by the Supreme Court on November 15, 1980. The Department of Revenue filed a master

EXHIBIT "B"

General Obligation Bonded Debt¹⁰

Issue	Fiscal Year Bonds Scheduled to Retire				
	2016	2017	2018	2019	2015
General Obligation Bonds (2/27/04)	-	-	-	-	315,000
General Obligation Refunding Bonds (2/27/12)	916,000	1,000,000	1,250,000	1,415,000	1,690,000
General Obligation Bonds (6/01/14)	537,000	632,200	793,000	873,000	912,000
General Obligation Refunding Bonds (2/25/15)	2,250,000	2,139,079	2,000,000	1,000,000	3,565,000
General Obligation Water and Sewer Refunding Bonds (4/09/15)	6,510,000	6,510,000	6,510,000	6,510,000	6,510,000
General Obligation Refunding Bonds (2/09/16)	3,100,000	3,040,000	4,530,000	4,840,000	-
Total	13,313,000	13,211,279	15,183,000	13,677,000	12,412,000

¹⁰ Above chart does include the General Obligation Water and Sewer Refunding Bonds, Series 2015 (the "2015 Bonds"), however, the 2015 Bonds are secured by the pledge of the net revenues of the combined water and sewer system and are not subject to the 15% debt limitation of the City.

plan to assist counties in determining use value. On February 7, 1993, the Chancery Court granted an extension until July 1, 1994, of its previous deadline past which the Department of Revenue could not accept and approve tax rolls from counties which had not yet responded. The City has completed response.

Homestead Exemption

The Mississippi Homestead Exemption Law of 1948 reduces the local tax burden on homes qualifying by law and substitutes revenues from other sources of taxation on the State level as a reimbursement to the local taxing units for such tax loss. Provisions of the homestead exemption law determine qualifications, define ownership and limit the amount of property that may come within the exemption. The exemption is not applicable to taxes levied for the payment of the Bonds, except as hereinafter stated.

Those homeowners who qualify for the homestead exemption and who have reached the age of sixty-five (65) years on or before January 1 of the year for which the exemption is claimed, serve-connected, totally disabled American veterans who were honorably discharged from military service and those qualified as disabled under the Federal Social Security Act are exempt from any and all ad valorem taxes on qualifying homesteads not in excess of \$7,500 of assessed value thereof.

The tax loss resulting to local taxing units from properly qualified homestead exemption is reimbursed by the Department of Revenue. Beginning with the 1981 supplemental ad valorem tax roll and for each roll thereafter, no taxing unit shall be reimbursed an amount in excess of one hundred six percent (106%) of the total net reimbursement made to such taxing unit in the next preceding year.

Ten Largest Taxpayers

The ten largest taxpayers in the City of Petal for fiscal year 2019 are as follows:

Taxpayer	Assessed Valuation	Taxes Collected
PETAL GAS STORAGE	\$47,531,130	\$631,537.00
ENTERPRISE PRODUCTS	\$4,863,032	\$222,487.00
WALMART	\$1,884,018	\$85,212.00
GENIE ELECTRIC POWER	\$1,735,445	\$80,195.00
LOWES	\$1,517,230	\$70,111.00
MISSISSIPPI POWER	\$1,011,937	\$46,764.00
TARGA DOWN STREAM	\$1,033,026	\$45,141.00
GEORGIA POWER COMPANY	\$825,973	\$38,166.00
SEQUENT ENERGY	\$793,838	\$36,693.00
CMS GAS TRANSMISSION & STORAGE	\$569,470	\$26,315.24
TOTALS:	\$31,726,694	\$1,284,191.21

SOURCE: Office of the Forest County Tax Assessor/Collector, March 2020

DEBT INFORMATION

Legal Debt Limit Statement

(As of March 1, 2020)

	15% Debt	20% Debt
Authorized Debt Limit (Last Completed Assessment for Taxation - 5/07/10/2015)	\$16,895,331	\$21,420,441
Present Debt Subject to Debt Limit ¹¹	4,366,900	3,692,000
Margin for Further Debt After Issuance of Bonds	\$11,218,441	\$17,728,441

Municipal Debt Limit

The City is subject to a general statutory debt limitation under which no municipality in the State may incur general obligation bonded indebtedness in an amount which will exceed 15 percent of the assessed value of the taxable property within such municipality according to the last completed assessment for taxation.

In computing general obligation bonded indebtedness for purpose of such 15 percent limitation, there may be deducted all bonds or other evidences of indebtedness issued for school, water and sewerage systems, gas and light and power purposes and for the construction of special improvements primarily chargeable to the property benefited, or for the purpose of paying a municipality's proportion of any betterment program, a portion of which is primarily chargeable to the property benefited. However, in no case may a municipality contract any indebtedness payable in whole or in part from proceeds of ad valorem taxes which, when added to all of its outstanding general obligation indebtedness, both bonded and floating, exceeds 20 percent of the assessed value of the taxable property within such municipality.

In arriving at the limitations set forth above, bonds issued for school purposes, bonds payable exclusively from the revenues of any municipally-owned utility, general obligation industrial bonds issued under the provisions of Sections 57-1-1 to 57-1-51, Mississippi Code of 1972, as amended, and special improvement improvement bonds issued under the provisions of Sections 21-41-3 to 21-41-53, Mississippi Code of 1972, as amended, are not included. Also excluded from both limitations are contract obligations subject to annual appropriations.

¹¹ The General Obligation Water and Sewer Refunding Bonds, dated April 9, 2015 ("2015 GO W&S Bonds"), are only subject to the 15% debt limitation of the City to the extent the amount of debt issued is in excess of the difference between the 15% and 20% debt limitation (\$1,420,441 - \$16,895,331) = \$5,355,110), as the net revenues of the combined water and sewer system of the City were pledged to the repayment of the 2015 GO W&S Bonds. A portion of the 2015 GO W&S Bonds in the amount of \$1,344,810 (Principal Balance of \$6,510,000 less \$5,255,110, the difference between the 15% and 20% debt limitation = \$1,354,890) was included in the 15% debt limitation figure only; and the General Obligation Water & Sewer Refunding Bonds dated February 9, 2016 are not subject to the 15% or the 20% debt limitation of the City.

Outstanding General Obligation Bonded Debt

(As of March 1, 2020)

Issue	Date of Issue	Outstanding Principal
General Obligation Refunding Bonds	09/27/12	\$10,000
General Obligation Bonds	06/12/14	\$37,000
General Obligation Refunding Bonds	02/24/15	2,244,000
General Obligation Water & Sewer Refunding Bonds ¹²	04/09/15	6,510,000
General Obligation Water & Sewer Refunding Bonds ¹³	02/09/16	1,180,000
Total		\$13,587,000

Other Outstanding Long Term Debt

(As of March 1, 2020)

Issue	Date of Issue	Outstanding Principal
Capital Leases & SRF Loan	Various	\$1,427,781.30

¹² These Bonds included an additional pledge of the net revenues of the combined water and sewer system and are only subject to the 15% debt limitation of the City to the extent the amount of debt issued is in excess of the difference between the 15% and 20% debt limitation.

¹³ These Bonds are not subject to the 15% or the 20% debt limitation of the City.

Annual Debt Service Requirements for General Obligation Indebtedness¹⁴

FY Ending September 30	General Obligation Debt Service		Total
	Principal	Interest	
2020	\$1,160,028.00	\$444,826.26	\$1,604,854.26
2021	\$1,254,068.00	\$416,431.76	\$1,670,499.76
2022	\$1,337,668.00	\$394,111.76	\$1,731,779.76
2023	\$1,405,668.00	\$374,009.76	\$1,779,677.76
2024	\$1,458,028.00	\$355,402.00	\$1,813,430.00
2025	\$1,499,028.00	\$338,400.00	\$1,837,428.00
2026	\$1,529,028.00	\$322,800.00	\$1,851,828.00
2027	\$1,548,028.00	\$308,400.00	\$1,856,428.00
2028	\$1,556,028.00	\$295,000.00	\$1,851,028.00
2029	\$1,553,028.00	\$282,600.00	\$1,835,628.00
2030	\$1,539,028.00	\$271,200.00	\$1,810,228.00
2031	\$1,514,028.00	\$260,800.00	\$1,774,828.00
2032	\$1,478,028.00	\$251,400.00	\$1,729,428.00
2033	\$1,431,028.00	\$243,000.00	\$1,674,028.00
Total	\$18,827,028.00	\$11,829,000.00	\$30,656,028.00

¹⁴ Above chart does include the General Obligation Water and Sewer Refunding Bonds, Series 2015 (the "2015 Bonds"), however, the 2015 Bonds are secured by the pledge of the net revenues of the combined water and sewer system and are not subject to the 15% debt limitation of the City.

Debt Ratio

FY Ended September 30	General Obligation Debt	General Obligation Debt as a % of Assessed Value
2019	\$13,582,000	12.88%
2018	14,713,000	14.34
2017	15,810,000	15.44
2016	16,873,000	16.43
2015	17,413,000	13.30

Overlapping Indebtedness General Obligation Indebtedness

(As of March 2020)

County	2019 Population Estimate	General Obligation Bonded Debt	General Obligation Bonded Debt per Capita
Forest County	75,036	\$15,325,000	\$204.24

School Districts	Total General Obligation Bonded Debt
Petal School District	\$3,000,000

SOURCE: 2019 Audited Financial Statement of District and EMSA balance stated as of March 2020

¹⁵ Source: Chancery Clerk's office, February 2020.

EXHIBIT A

Event Notice

The City certifies that none of the events noticed have occurred with respect to the Bonds:

- (1) Principal and interest payment delinquencies;
- (2) Non-payment related defaults, if material;
- (3) Unscheduled draws on debt service reserves, if any, reflecting financial difficulties;
- (4) Unscheduled draws on credit enhancements reflecting financial difficulties;
- (5) Substitution of credit or liquidity providers, or their failure to perform;
- (6) Adverse tax opinions, the issuance by the Internal Revenue Service of proposed or final determinations of taxability, Notices of Proposed Issue (IRS Form 5701-TEB) or other material notices or determinations with respect to the tax status of the Bonds, or other material events affecting the tax status of the Bonds;
- (7) Modifications to rights of Bondholders, if material;
- (8) Bond calls, if material, and tender offers;
- (9) Defaultances;
- (10) Release, substitution, or sale of property, if any, securing repayment of the Bonds, if material;
- (11) Rating changes;
- (12) Bankruptcy, insolvency, receivership, or similar event of the Issuer;
- (13) The consummation of a merger, consolidation, or acquisition involving the issuer or the sale of all or substantially all of the assets of the issuer, other than in the ordinary course of business, the entry into a definitive agreement to undertake such an action or the termination of a definitive agreement relating to any such actions, other than pursuant to its terms, if material and/or
- (14) Appointment of a successor or additional trustee or the change of name of a trustee, if material.

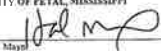
THE CITY OF PETAL, MISSISSIPPI
BY: 
Mayor
Date: 3-4-20

City of Petal
001 General Fund

Governmental Income Statement

Revenue	Budget Rev.1
Taxes	
Intergovernmental	4,235,900
Local	631,500
State	2,630,906
Total Intergovernmental	7,498,306
Charges for Svc - Govt	2,636,256
Charges for Svc - Enterprise	260,000
Total Charges for services	2,896,256
Fees and forfeits	260,000
Misc	25,000
Total Revenue	2,762,000
Expenses	
Debt Service	0
Debt Capital	0
Debt Retirement	8,607,906
General Government	
Alderman Personnel Services	145,247
Alderman Services	64,325
Total Alderman	209,572
Judicial	
Judicial Personnel Services	176,410
Judicial Services	2,500
Judicial Capital Outlay	131,425
Total Judicial	310,335
Executive Personnel Services	127,403
Executive Supplies	0
Executive Services	5,150
Legal Executive	136,952
Election Safety	0
Election Supplies	0

General

for each additional 1,000 gallons used \$4.00

The City of Petal, Mississippi (the "City") owns and operates the System through its Department of Public Works. The water system utilizes four (4) water wells having a capacity of two (2) million gallons per day (MGD). The average daily usage of water is 1.4 MGD with the peak daily usage of water is 1.3 MGD. There is approximately 126 miles of water lines. The sewer system consists of sewer interceptor and transmission lines with the treatment of sewer in the regional sewer plant in Hattiesburg, Mississippi. The City is responsible for collection and transportation of sewer to the regional plant. The average daily usage of sewer is one (1) MGD and peak daily usage of sewer is 1.3 MGD. There is approximately 65 miles of sewer lines.

The City has met all requirements set forth by the Mississippi Department of Natural Resources and the Environmental Protection Agency.

Capital Improvement Program

The City will continue to make normal improvements, extensions and repairs to the System in general conformance with the City's capital improvement plans.

Combined Water and Sewer System Enterprise Fund

The System is maintained as a separate accounting entity and is operated as an "enterprise fund." Such fund is used to account for water and sewer services provided to residents of the City and some residents outside the incorporated area of the City. All activities necessary to provide such services are accounted for in this fund including administration, engineering, pumping and purification, transmission and distribution, financing and debt service and billing collections.

Management of the System

The System is operated by the City's Department of Public Works under administrative control of the Mayor. The Clerk, as the financial officer of the City, maintains the books of accounts and prepares financial statements for the System.

Establishment of Rates

Rates for water and sewer services are established by the Mayor and Board of Aldermen which, if a series of bonds are outstanding, must consider, among other things, the rate covenant contained in the bond resolution. Newly adopted rates become effective as to each user one month after they have been adopted by the Mayor and Board of Aldermen, provided however, that such newly adopted rates may become effective immediately upon the unanimous approval of the Mayor and Board of Aldermen based on a finding of good cause and a statement in the adopting ordinance of the reason why it is necessary that the new rates become effective immediately.

Rate Structure

Billing for water and sewer charges are prepared by the City Clerk's office from data entered by the Department of Public Works. Bills are printed once monthly at the end of each month. The following rate structure for water charges was increased effective September 6, 2017 and for sewer charges effective October 4, 2018.

RATE SCHEDULE
RESIDENTIAL
WATER

0-2,000 gallons	\$11.00
-----------------	---------

SEWER	\$12.00 per month
COMMERCIAL WATER	

0-2,000 gallons	\$13.00
for each additional 1,000 gallons used between 2,000 and 50,000 gallons	\$ 6.00
for each additional 1,000 gallons used between 51,000 and 100,000 gallons	\$ 5.00
for each additional 1,000 gallons used above 100,000 gallons	\$ 4.50

SEWER	
0-4,000 gallons	\$30.00
for each additional 1,000 gallons used between 4,000 and 50,000 gallons	\$ 3.00
for each additional 1,000 gallons used between 51,000 and 100,000 gallons	\$ 2.00
for each additional 1,000 gallons used above 100,000 gallons	\$ 1.50

City of Petal
001 General Fund

Governmental Income Statement

Revenue	Budget Rev.1
Elections Services	
Total Elections	0
Financial	
Financial Personnel Services	198,897
Financial Supplies	20,000
Financial Capital Outlay	538,700
Total Financial	757,597
Legal	
Legal Personnel Services	21,576
Legal Services	2,200
Total Legal	23,776
Data Processing	
Data Processing Supplies	1,000
Data Processing Services	16,000
Total Data Processing	17,000
Police Department	
Police Department Personnel Services	1,917,706
Police Department Supplies	165,977
Police Department Capital Outlay	121,500
Police Dept Debt Service	84,202
Total Police Department	2,290,763
Fire Department	
Fire Department Personnel Services	2,249,542
Fire Department Supplies	62,175
Fire Department Capital Outlay	73,256
Fire Department Debt Service	145,847
Total Fire Department	2,530,820
Building and Inspection	
Building and Inspection Personnel Services	59,627
Building and Inspection Supplies	10,200
Building and Inspection Capital Outlay	103,250

City of Petal
001 General Fund

Governmental Income Statement

Revenue	Budget Rev.1
Total Building and Inspection	219,877
Highways and Streets	
Streets and Highways Personnel Services	516,170
Streets and Highways Supplies	233,250
Streets and Highways Services	563,300
Streets and Highways Capital Outlay	18,000
Streets and Services	18,000
Total Streets and Highways	1,337,866
Culture and Recreation	
Recreation Personnel Services	351,900
Recreation Supplies	10,200
Recreation Capital Outlay	109,300
Recreation Debt Service	48,431
Total Recreation	569,831
Senior/Cultural Center Personnel Services	
Senior/Cultural Center Supplies	72,346
Senior/Cultural Center Capital Outlay	4,500
Senior/Cultural Center Services	23,000
Total Senior/Cultural Center	99,846
Civic Center	
Civic Center Personnel Services	49,184
Civic Center Supplies	10,200
Civic Center Capital Outlay	47,600
Total Civic Center	99,844
Debt Service	0
Debt Capital	0
Debt Retirement	8,607,260
Total Debt Service	8,607,260
Total Governmental Income Statement	\$55

SEWER TREATMENT CHARGE
RESIDENTIAL AND COMMERCIAL

Flat rate \$12.00

The ten largest users of water and sewer per gallon/per month for fiscal year 2019 are listed below:

TEN LARGEST CUSTOMERS	USAGE (1,000 gallons per month)	AMOUNT (per month)
Petal School District	529	\$2,580.00
Forest Gardens Mobile Home Park	340	3,150.00 ¹
Enterprise Products	303	2,460.83
Snap & Sudo Laundry	225	1,109.00
Hulland Care Nursing Home	218	1,075.00
BNC Special Acquisition	210	1,297.30
Crest Brothers Investors	124	767.30
Lowe's Irrigation	117	392.00
Pride Bay Washateria	83	448.00
George St. Laundry	80	447.75
Total:	2,238	\$10,087.62

¹ Forest Gardens Mobile Home Park is a Master Meter and most usage is billed to individual mobile home owners.

City of Petal
102 Fire State Retiree Fund

Governmental Income Statement

Revenue	Budget Rev.1
Intergovernmental	
Local	0
Total Intergovernmental	59,700
Interest	0
Misc	0
Treasury	0
Beq Cash	0
Total Revenue	60,000
Expenses	
Public Safety	118,220
Fire Department	
Fire Department Supplies	110,000
Fire Department Services	1,700
Fire Department Capital Outlay	6,000
Total Fire Department	117,700
Total Public Safety	117,704
Total Expense	117,704
Total Governmental Income Statement	2,016

Statement of Revenues, Expenditures, and Debt Service Coverage

	2011 Actual	2012 Actual	2013 Actual	2014 Actual	2015 Actual	2016 Actual	2017 Actual	2018 Actual	2019 Projected	2020 Projected
REVENUES										
Total Revenues	2,706,331	3,051,608	3,620,861	3,784,430	3,843,201	3,841,008	3,722,258	3,727,450	3,727,450	3,727,450
EXPENDITURES										
Total Expenditures	3,183,554	3,428,221	3,102,291	3,126,133	3,107,031	3,105,621	3,282,877	3,282,877	3,282,877	3,282,877
Total Available for Debt Service	\$511,776	\$623,387	\$1,518,570	\$1,658,301	\$1,736,170	\$1,735,387	\$1,439,381	\$1,444,573	\$1,444,573	\$1,444,573
Total Debt Service	31,023,453	31,023,453	31,023,453	31,023,453	31,023,453	31,023,453	30,966,000	30,966,000	30,966,000	30,966,000
Total Service Coverage	1.64	1.98	1.98	1.98	1.98	1.98	1.48	1.48	1.48	1.48

ASSUMPTIONS:
- Revenues projected to grow at 1% annually beginning in 2016.
- Expenses projected to grow at 1% annually beginning in 2016.

DEBTS:
1. \$541,000,000 General Obligation Water and Sewer Refunding Bonds, Series 2015 of the City of Petal, Mississippi.
2. \$4,885,000 General Obligation Water and Sewer Refunding Bonds, Series 2016 of the City of Petal, Mississippi.

CITY OF PETAL
MINUTE BOOK 37

EXHIBIT "B"

	<u>Budget</u> <u>Rev 1</u>		<u>Budget</u> <u>Rev 1</u>
Governmental Income Statement		Governmental Income Statement	
Revenue		Revenue	
Interest	0	Intergovernmental	
Transfers	692,450	Local	1,500
Total Revenue	692,450	Total Intergovernmental	1,500
Expense		Interest	0
Debt Service	692,450	Misc	0
Total Expense	692,450	Beg Cash	9,000
Total Governmental Income Statement	0	Total Revenue	10,500
		Expense	
		Public safety	
		Police Department	
		Police Department Services	0
		Police Department Capital Outlay	0
		Total Police Department	0
		Total Public safety	0
		Total Expense	0
		Total Governmental Income Statement	10,500

	<u>Budget</u> <u>Rev 1</u>		<u>Budget</u> <u>Rev 1</u>
Governmental Income Statement		Governmental Income Statement	
Revenue		Revenue	
Interest	0	Intergovernmental	
Transfers	249,625	State	190,000
Total Revenue	249,625	Total Intergovernmental	190,000
Expense		Interest	0
Debt Service	249,625	Transfers	0
Total Expense	249,625	Total Revenue	190,000
Total Governmental Income Statement	0	Expense	
		Highways and streets	
		Streets and Highways	
		Streets and Highways Services	0
		Streets and Highways Capital Outlay	190,000
		Total Streets and Highways	190,000
		Total Highways and streets	190,000
		Total Expense	190,000
		Total Governmental Income Statement	0

	<u>Budget</u> <u>Rev 1</u>		<u>Budget</u> <u>Rev 1</u>
Governmental Income Statement		Governmental Income Statement	
Revenue		Revenue	
Interest	200	Intergovernmental	
Transfers	98,000	State	0
Beg Cash	98,559	Total Intergovernmental	0
Total Revenue	196,759	Interest	0
Expense		Misc	0
Highways and streets		Beg Cash	0
Streets and Highways		Total Revenue	0
Streets and Highways Services	0	Expense	
Total Streets and Highways	0	Highways and streets	
Debt Service		Streets and Highways	
Debt Payments	196,759	Streets and Highways Supplies	0
Total Debt Service	196,759	Streets and Highways Services	0
Total Expense	196,759	Streets and Highways Capital Outlay	0
Total Governmental Income Statement	0	Total Streets and Highways	0
		Debt Service	0
		Total Expense	0
		Total Governmental Income Statement	0

	<u>Budget</u> <u>Rev 1</u>		<u>Budget</u> <u>Rev 1</u>
Governmental Income Statement		Governmental Income Statement	
Revenue		Revenue	
Interest	200	Intergovernmental	
Transfers	180,000	State	0
Beg Cash	208,650	Total Intergovernmental	0
Total Revenue	388,850	Interest	10,000
Expense		Transfers	0
Debt Service		Beg Cash	722,000
Debt Payments	358,850	Total Revenue	732,000
Total Debt Service	358,850	Expense	
Total Expense	358,850	Culture and recreation	
Total Governmental Income Statement	0	Recreation	
		Recreation Services	10,000
		Recreation Capital Outlay	722,000
		Total Recreation	732,000
		Total Culture and recreation	732,000
		Total Expense	732,000
		Total Governmental Income Statement	0

MINUTE BOOK 27

EXHIBIT "B" Governmental Income Statement

Revenue	
Intergovernmental	
Total Intergovernmental	
Charges for services	
Charges for Svc - Enterprise	
Total Charges for services	
Interest	
Misc	
Transfers	
Beg Cash	
Total Revenue	
Expense	
Enterprise	
Water	
Water Personal Services	
Water Supplies	
Water Services	
Water Capital Outlay	
Sewer Debt Service	
Total Water	
Debt Service	
Debt Payments	
Total Debt Service	
Total Expense	
Total Governmental Income Statement	

Budget	0
Rev 1	0
	3,782,950
	3,782,950
	15,000
	0
	0
	0
	0
	3,797,950
	691,545
	324,295
	1,430,500
	318,908
	987,726
	3,743,274
	43,411
	3



Revenue	
Charges for services	
Charges for Svc - Govt	
Total Charges for services	
Interest	
Misc	
Transfers	
Beg Cash	
Total Revenue	
Expense	
Enterprise	
Sanitation	
Sanitation Personal Services	
Sanitation Supplies	
Sanitation Services	
Sanitation Capital Outlay	
Total Sanitation	
Total Enterprise	
Total Expense	
Total Governmental Income Statement	

Budget	893,087
Rev 1	893,087
	200
	0
	0
	0
	893,287
	47,121
	0
	844,450
	0
	891,571
	891,571
	1,716

Account	Description	Account No	Amount
400000	GENERAL, OBLIGATION REFUNDING BONDS, SERIES 2015	400000	1.00
400001	GENERAL, OBLIGATION REFUNDING BONDS, SERIES 2015	400001	1.00
400002	GENERAL, OBLIGATION REFUNDING BONDS, SERIES 2015	400002	1.00
400003	GENERAL, OBLIGATION REFUNDING BONDS, SERIES 2015	400003	1.00
400004	GENERAL, OBLIGATION REFUNDING BONDS, SERIES 2015	400004	1.00
400005	GENERAL, OBLIGATION REFUNDING BONDS, SERIES 2015	400005	1.00
400006	GENERAL, OBLIGATION REFUNDING BONDS, SERIES 2015	400006	1.00
400007	GENERAL, OBLIGATION REFUNDING BONDS, SERIES 2015	400007	1.00
400008	GENERAL, OBLIGATION REFUNDING BONDS, SERIES 2015	400008	1.00
400009	GENERAL, OBLIGATION REFUNDING BONDS, SERIES 2015	400009	1.00
400010	GENERAL, OBLIGATION REFUNDING BONDS, SERIES 2015	400010	1.00
400011	GENERAL, OBLIGATION REFUNDING BONDS, SERIES 2015	400011	1.00
400012	GENERAL, OBLIGATION REFUNDING BONDS, SERIES 2015	400012	1.00
400013	GENERAL, OBLIGATION REFUNDING BONDS, SERIES 2015	400013	1.00
400014	GENERAL, OBLIGATION REFUNDING BONDS, SERIES 2015	400014	1.00
400015	GENERAL, OBLIGATION REFUNDING BONDS, SERIES 2015	400015	1.00
400016	GENERAL, OBLIGATION REFUNDING BONDS, SERIES 2015	400016	1.00
400017	GENERAL, OBLIGATION REFUNDING BONDS, SERIES 2015	400017	1.00
400018	GENERAL, OBLIGATION REFUNDING BONDS, SERIES 2015	400018	1.00
400019	GENERAL, OBLIGATION REFUNDING BONDS, SERIES 2015	400019	1.00
400020	GENERAL, OBLIGATION REFUNDING BONDS, SERIES 2015	400020	1.00

Account	Description	Account No	Amount
400021	GENERAL, OBLIGATION REFUNDING BONDS, SERIES 2015	400021	1.00
400022	GENERAL, OBLIGATION REFUNDING BONDS, SERIES 2015	400022	1.00
400023	GENERAL, OBLIGATION REFUNDING BONDS, SERIES 2015	400023	1.00
400024	GENERAL, OBLIGATION REFUNDING BONDS, SERIES 2015	400024	1.00
400025	GENERAL, OBLIGATION REFUNDING BONDS, SERIES 2015	400025	1.00
400026	GENERAL, OBLIGATION REFUNDING BONDS, SERIES 2015	400026	1.00
400027	GENERAL, OBLIGATION REFUNDING BONDS, SERIES 2015	400027	1.00
400028	GENERAL, OBLIGATION REFUNDING BONDS, SERIES 2015	400028	1.00
400029	GENERAL, OBLIGATION REFUNDING BONDS, SERIES 2015	400029	1.00
400030	GENERAL, OBLIGATION REFUNDING BONDS, SERIES 2015	400030	1.00
400031	GENERAL, OBLIGATION REFUNDING BONDS, SERIES 2015	400031	1.00
400032	GENERAL, OBLIGATION REFUNDING BONDS, SERIES 2015	400032	1.00
400033	GENERAL, OBLIGATION REFUNDING BONDS, SERIES 2015	400033	1.00
400034	GENERAL, OBLIGATION REFUNDING BONDS, SERIES 2015	400034	1.00
400035	GENERAL, OBLIGATION REFUNDING BONDS, SERIES 2015	400035	1.00
400036	GENERAL, OBLIGATION REFUNDING BONDS, SERIES 2015	400036	1.00
400037	GENERAL, OBLIGATION REFUNDING BONDS, SERIES 2015	400037	1.00
400038	GENERAL, OBLIGATION REFUNDING BONDS, SERIES 2015	400038	1.00
400039	GENERAL, OBLIGATION REFUNDING BONDS, SERIES 2015	400039	1.00
400040	GENERAL, OBLIGATION REFUNDING BONDS, SERIES 2015	400040	1.00

Account	Description	Account No	Amount
400041	GENERAL, OBLIGATION REFUNDING BONDS, SERIES 2015	400041	1.00
400042	GENERAL, OBLIGATION REFUNDING BONDS, SERIES 2015	400042	1.00
400043	GENERAL, OBLIGATION REFUNDING BONDS, SERIES 2015	400043	1.00
400044	GENERAL, OBLIGATION REFUNDING BONDS, SERIES 2015	400044	1.00
400045	GENERAL, OBLIGATION REFUNDING BONDS, SERIES 2015	400045	1.00
400046	GENERAL, OBLIGATION REFUNDING BONDS, SERIES 2015	400046	1.00
400047	GENERAL, OBLIGATION REFUNDING BONDS, SERIES 2015	400047	1.00
400048	GENERAL, OBLIGATION REFUNDING BONDS, SERIES 2015	400048	1.00
400049	GENERAL, OBLIGATION REFUNDING BONDS, SERIES 2015	400049	1.00
400050	GENERAL, OBLIGATION REFUNDING BONDS, SERIES 2015	400050	1.00
400051	GENERAL, OBLIGATION REFUNDING BONDS, SERIES 2015	400051	1.00
400052	GENERAL, OBLIGATION REFUNDING BONDS, SERIES 2015	400052	1.00
400053	GENERAL, OBLIGATION REFUNDING BONDS, SERIES 2015	400053	1.00
400054	GENERAL, OBLIGATION REFUNDING BONDS, SERIES 2015	400054	1.00
400055	GENERAL, OBLIGATION REFUNDING BONDS, SERIES 2015	400055	1.00
400056	GENERAL, OBLIGATION REFUNDING BONDS, SERIES 2015	400056	1.00
400057	GENERAL, OBLIGATION REFUNDING BONDS, SERIES 2015	400057	1.00
400058	GENERAL, OBLIGATION REFUNDING BONDS, SERIES 2015	400058	1.00
400059	GENERAL, OBLIGATION REFUNDING BONDS, SERIES 2015	400059	1.00
400060	GENERAL, OBLIGATION REFUNDING BONDS, SERIES 2015	400060	1.00

Account	Description	Account No	Amount
400061	GENERAL, OBLIGATION REFUNDING BONDS, SERIES 2015	400061	1.00
400062	GENERAL, OBLIGATION REFUNDING BONDS, SERIES 2015	400062	1.00
400063	GENERAL, OBLIGATION REFUNDING BONDS, SERIES 2015	400063	1.00
400064	GENERAL, OBLIGATION REFUNDING BONDS, SERIES 2015	400064	1.00
400065	GENERAL, OBLIGATION REFUNDING BONDS, SERIES 2015	400065	1.00
400066	GENERAL, OBLIGATION REFUNDING BONDS, SERIES 2015	400066	1.00
400067	GENERAL, OBLIGATION REFUNDING BONDS, SERIES 2015	400067	1.00
400068	GENERAL, OBLIGATION REFUNDING BONDS, SERIES 2015	400068	1.00
400069	GENERAL, OBLIGATION REFUNDING BONDS, SERIES 2015	400069	1.00
400070	GENERAL, OBLIGATION REFUNDING BONDS, SERIES 2015	400070	1.00
400071	GENERAL, OBLIGATION REFUNDING BONDS, SERIES 2015	400071	1.00
400072	GENERAL, OBLIGATION REFUNDING BONDS, SERIES 2015	400072	1.00
400073	GENERAL, OBLIGATION REFUNDING BONDS, SERIES 2015	400073	1.00
400074	GENERAL, OBLIGATION REFUNDING BONDS, SERIES 2015	400074	1.00
400075	GENERAL, OBLIGATION REFUNDING BONDS, SERIES 2015	400075	1.00
400076	GENERAL, OBLIGATION REFUNDING BONDS, SERIES 2015	400076	1.00
400077	GENERAL, OBLIGATION REFUNDING BONDS, SERIES 2015	400077	1.00
400078	GENERAL, OBLIGATION REFUNDING BONDS, SERIES 2015	400078	1.00
400079	GENERAL, OBLIGATION REFUNDING BONDS, SERIES 2015	400079	1.00
400080	GENERAL, OBLIGATION REFUNDING BONDS, SERIES 2015	400080	1.00

NOTICE IS HEREBY PROVIDED that the Audited Financial Statement and/or the Unaudited Financial Statement for Fiscal Year 2019 of the City of Petal, Mississippi are available for filing at this time. The financial statements will be filed upon availability thereof.

Issuer: City of Petal, Mississippi

FY 2019 Audited or Unaudited Financial Statements

EMMA
Electronic Municipal Market Access

Subscription ID: E3101
Subscription Date: 2020-03-19 14:00
Admin: 0110101010

Document Company
New ALIS-42-0410101
Admin: Financial Statements and Operating Data FY 2019 Reported to Mississippi - City of Petal, MS. User: user101010101010

Document
FY 2019 Municipal Statement - City of Petal, MS

Modified Statement
The following are available for this accounting statement:
 General Ledger
 Balance Sheet
 Statement of Financial Position
 Statement of Operations

This City's statement was prepared using the procedures set forth in the following sections:
 General Ledger
 Balance Sheet
 Statement of Financial Position
 Statement of Operations

Run: 5/25/2020 at 2:27 PM

City of Petal
(Wendy & Lynn) Accounts Payable Status Report

Org Name & Lookup	Invoice Date	Invoice Number	A/P Due Date	A/P Description	Original A/P Owed	Balance Due
Lynn Camelfield					4.38	4.38
ACE HARDWARE [00149]	4/08/2020	308847	5/10/2020	KEY FOR BLDG DEPT	209.86	209.86
ACE HARDWARE [00149]	4/15/2020	308060	5/10/2020	PLUMBING SUPPLIES	118.78	118.78
ACE HARDWARE [00149]	4/27/2020	309310	5/10/2020	PLUMBING SUPPLIES	13.56	13.56
ACE HARDWARE [00149]	4/28/2020	309324	5/10/2020	ADAPTER	74.38	74.38
ACE HARDWARE [00149]	4/29/2020	309361	5/10/2020	FIRE ANTI KILLER WD40	158.19	158.19
ACE HARDWARE [00149]	4/30/2020	55182	5/10/2020	ADAPTER, SCREWS TAPE FASTENERS	580.20	580.20
AT&T [08082]	4/10/2020	6015	5/10/2020	MONTHLY EXPENSE	214.36	214.36
AT&T [08082]	4/10/2020	4942	5/10/2020	NCIC	33.23	33.23
AT&T [08082]	4/10/2020	5368	5/10/2020	MONTHLY EXPENSE	637.20	637.20
AT&T NCICT1 LINE [12201]	4/01/2020	3116951043	5/10/2020	MONTHLY EXPENSE	267.40	267.40
AT&T NCICT1 LINE [12201]	4/10/2020	GH16590	5/10/2020	NCIC	124.66	124.66
AWARE GPS [12016]	4/15/2020	2452762	5/10/2020	MONTHLY SERVICE	305.83	305.83
B CLEAN LLC [11450]	4/10/2020	59137	5/10/2020	VACUUM OUT KATRINA	1,232.95	1,232.95
BADGER METER, INC [08088]	4/29/2020	800590201	5/10/2020	MONTHLY HOISTING	600.86	600.86
BANCORP SOUTH EQUIPMENT FINANCE [08059]	4/06/2020	678938	5/10/2020	RADIOS MOTOROLA	26,627.93	26,627.93
BARDING GENERATOR [04140]	4/02/2020	173254	5/10/2020	HYDRAULIC PACK AND DRINGS	105.41	105.41
BARDING GENERATOR [04140]	4/02/2020	173255	5/10/2020	DATCON HOUR METER FOR SPRAYER IN UNIT 78	129.50	129.50
BARDING GENERATOR [04140]	4/02/2020	173256	5/10/2020	DATCON HOUR METER FOR SPRAYER	129.50	129.50
BARDING GENERATOR [04140]	4/08/2020	173292	5/10/2020	WATER PUMP UNIT 67	420.12	420.12
BARDING GENERATOR [04140]	4/12/2020	173267	5/10/2020	BATTERY AND CABLE	212.90	212.90
BARDING GENERATOR [04140]	4/22/2020	173376	5/10/2020	A/C COMPRESSOR, ORFICE TUBE	591.26	591.26
BARDING GENERATOR [04140]	4/28/2020	173438	5/10/2020	CABLE LUGS AND LABOR	80.00	80.00
BARDING GENERATOR [04140]	4/29/2020	173446	5/10/2020	GATE OPENERS	78.25	78.25
BARDING GENERATOR [04140]	4/10/2020	20564050	5/10/2020	MONTHLY EXPENSE	28.42	28.42
BARROTTOWN UTILITY ASSOC [08102]	4/10/2020	APRIL2020	5/10/2020	MONTHLY EXPENSE	50.59	50.59
BARROTTOWN UTILITY ASSOC [08102]	3/27/2020	22017	5/10/2020	MAILING OF APRIL BILLS	300.16	300.16
BFCM, INC [18446]	4/10/2020	10258567	5/10/2020	CONTINUING DISCLOSURE STATEMENT FOR 2019	3,000.00	3,000.00

Run: 5/25/2020 at 2:27 PM

CITY OF PETAL
(Wendy & Lynn) Accounts Payable Status Report

Org Name & Lookup	Invoice Date	Invoice Number	A/P Due Date	A/P Description	Original A/P Owed	Balance Due
CANON FINANCIAL SERVICES INC [10738]	4/15/2020	21348061	5/10/2020	MONTHLY EXPENSE	72.00	72.00
CANON SOLUTIONS [08500]	4/01/2020	403242066	5/10/2020	MAINTENANCE	81.59	81.59
CENTERPOINT ENERGY [08170]	4/09/2020	11026052-8	5/09/2020	117 W EIGHTH AVE	91.50	91.50
CENTERPOINT ENERGY [08170]	4/09/2020	1342874-1	5/09/2020	741 S MAIN CIVIC CENTER	53.76	53.76
CENTERPOINT ENERGY [08170]	4/09/2020	3205311-8	5/09/2020	119 W EIGHTH	35.90	35.90
CENTERPOINT ENERGY [08170]	4/09/2020	3205315-9	5/09/2020	121 W EIGHTH	87.14	87.14
CENTERPOINT ENERGY [08170]	4/09/2020	3205318-3	5/09/2020	343 HIGHWAY 11	26.05	26.05
CENTERPOINT ENERGY [08170]	4/09/2020	5106843-5	5/09/2020	1187 HIGHWAY 42	117.82	117.82
CENTERPOINT ENERGY [08170]	4/09/2020	7018623-4	5/09/2020	132 MEADOWBROOK	26.09	26.09
CENTERPOINT ENERGY [08170]	4/09/2020	7019102-8	5/09/2020	281 WILDWOOD TRAIL	33.93	33.93
CENTERPOINT ENERGY [08170]	4/09/2020	702547-7	5/09/2020	DOGWOOD DR	26.09	26.09
CENTERPOINT ENERGY [08170]	4/09/2020	702550-1	5/09/2020	DOGWOOD DR G1	27.95	27.95
CENTERPOINT ENERGY [08170]	4/09/2020	707491-5	5/09/2020	ESTATES DR G1	25.09	25.09
CENTERPOINT ENERGY [08170]	4/09/2020	762305-6	5/09/2020	102 FAIRCHILD	31.44	31.44
CENTERPOINT ENERGY [08170]	4/09/2020	764256-0	5/09/2020	424 MAPLE DR	27.92	27.92
CENTERPOINT ENERGY [08170]	4/09/2020	7654258-6	5/09/2020	75 DOGWOOD LANE	27.92	27.92
CENTERPOINT ENERGY [08170]	4/09/2020	8113563-8	5/09/2020	54 SPRINGFIELD RD	15.02	15.02
CENTERPOINT ENERGY [08170]	4/09/2020	9219817-5	5/09/2020	1950 RUSSETT LANE	27.92	27.92
CENTERPOINT ENERGY [08170]	4/09/2020	9797555-5	5/09/2020	1950 OLD RICHTON RD	27.92	27.92
CINTEAS (1) [08185]	4/10/2020	APRIL2020	5/10/2020	UNIFORM RENTAL	2,976.20	2,976.20
CITY OF HATTIESBURG [08187]	4/25/2020	04252020	5/10/2020	MONTHLY TREATMENT	42,513.00	42,513.00
CLAY C. SCOTT INS. [06190]	4/02/2020	3551	5/10/2020	INSURANCE ON BUS	3,184.00	3,184.00
COAST CHLORINATOR & PUMP [08182]	4/20/2020	71001	5/10/2020	WATER TREATMENT	4,860.00	4,860.00
CONTROL SYSTEMS [06199]	4/17/2020	58326	5/10/2020	DUPLICATE CONTROLLER	801.74	801.74
COVINGTON SALES AND SERVICE [08203]	4/09/2020	86151	5/10/2020	MONITOR	186.28	186.28
COVINGTON SALES AND SERVICE [08203]	4/12/2020	86191	5/10/2020	REEL SWIVEL	1,194.23	1,194.23
4/10/2020	APRIL 2020	5/10/2020	MONTHLY EXPENSE	63.84	63.84	
DELKS TIRE SALES & SERVIC [08220]	4/21/2020	30965-30666	5/10/2020	DISMOUNT AND MOUNT TIRE ON TRACTORS	215.69	215.69
DELKS TIRE SALES & SERVIC [08220]	4/29/2020	31048-31052	5/10/2020	TIRES	136.56	136.56
DIXIE ELECTRIC POWER ASSN [08227]	4/09/2020	2000720003	5/09/2020		55.76	55.76
DIXIE ELECTRIC POWER ASSN [08227]	4/09/2020	2003700003	5/09/2020			

Run: 5/25/2020 at 2:27 PM

City of Petal
(Wendy & Lynn) Accounts Payable Status Report

Org Name & Lookup	Invoice Date	Invoice Number	A/P Due Date	A/P Description	Original A/P Owed	Balance Due
DIXIE ELECTRIC POWER ASSN [08227]	4/09/2020	2005881000	5/09/2020		420.69	420.69
DIXIE ELECTRIC POWER ASSN [08227]	4/09/2020	2005894001	5/09/2020		61.19	61.19
DIXIE ELECTRIC POWER ASSN [08227]	4/09/2020	2008205001	5/09/2020		45.37	45.37
DIXIE ELECTRIC POWER ASSN [08227]	4/09/2020	2008920001	5/09/2020		92.39	92.39
DIXIE ELECTRIC POWER ASSN [08227]	4/09/2020	2008986501	5/09/2020		73.16	73.16
DIXIE ELECTRIC POWER ASSN [08227]	4/09/2020	2010880000	5/09/2020		114.91	114.91
DIXIE ELECTRIC POWER ASSN [08227]	4/09/2020	2012920000	5/09/2020		42.15	42.15
DIXIE ELECTRIC POWER ASSN [08227]	4/09/2020	2012920000	5/09/2020		124.88	124.88
DIXIE ELECTRIC POWER ASSN [08227]	4/09/2020	2014800000	5/09/2020		145.84	145.84
DIXIE ELECTRIC POWER ASSN [08227]	4/09/2020	2015623000	5/09/2020		72.08	72.08
DIXIE ELECTRIC POWER ASSN [08227]	4/09/2020	2018321500	5/09/2020		28.80	28.80
DIXIE ELECTRIC POWER ASSN [08227]	4/09/2020	2018981500	5/09/2020		104.83	104.83
DIXIE ELECTRIC POWER ASSN [08227]	4/09/2020	2111111001	5/09/2020		50.83	50.83
DIXIE ELECTRIC POWER ASSN [08227]	4/09/2020	2111500000	5/09/2020		335.98	335.98
DIXIE ELECTRIC POWER ASSN [08227]	4/09/2020	2111534001	5/09/2020		51.67	51.67
DIXIE ELECTRIC POWER ASSN [08227]	4/09/2020	2111990000	5/09/2020		87.25	87.25
DIXIE ELECTRIC POWER ASSN [08227]	4/09/2020	2112063000	5/09/2020		34.69	34.69
DIXIE ELECTRIC POWER ASSN [08227]	4/09/2020	2112940000	5/09/2020		38.80	38.80
DIXIE ELECTRIC POWER ASSN [08227]	4/09/2020	2113280000	5/09/2020		45.92	45.92
DIXIE ELECTRIC POWER ASSN [08227]	4/09/2020	2114810000	5/09/2020		41.62	41.62
DIXIE ELECTRIC POWER ASSN [08227]	4/09/2020	2114820000	5/09/2020		42.78	42.78
DIXIE ELECTRIC POWER ASSN [08227]	4/09/2020	2116887000	5/09/2020		314.18	314.18
DIXIE ELECTRIC POWER ASSN [08227]	4/09/2020	2117090001	5/09/2020		56.17	56.17
DIXIE ELECTRIC POWER ASSN [08227]	4/09/2020	2117739501	5/09/2020		57.32	57.32
DIXIE ELECTRIC POWER ASSN [08227]	4/09/2020	2117749900	5/09/2020		37.12	37.12
DIXIE ELECTRIC POWER ASSN [08227]	4/09/2020	2117753001	5/09/2020		85.22	85.22
DIXIE ELECTRIC POWER ASSN [08227]	4/09/2020	2118240001	5/09/2020		191.98	191.98
DIXIE ELECTRIC POWER ASSN [08227]	4/09/2020	2118400001	5/09/2020		89.76	89.76
DIXIE ELECTRIC POWER ASSN [08227]	4/09/2020	2121600001	5/09/2020		29.10	29.10
DIXIE ELECTRIC POWER ASSN [08227]	4/09/2020	2121880001	5/09/2020		226.00	226.00
DIXIE ELECTRIC POWER ASSN [08227]	4/09/2020	2121960001	5/09/2020		46.55	46.55
DIXIE ELECTRIC POWER ASSN [08227]	4/09/2020	2122280001	5/09/2020		87.56	87.56
DIXIE ELECTRIC POWER ASSN [08227]	4/09/2020	2123240001	5/09/2020		321.76	321.76

Run: 5/25/2020 at 2:27 PM

City of Petal
(Wendy & Lynn) Accounts Payable Status Report

Org Name & Lookup	Invoice Date	Invoice Number	A/P Due Date	A/P Description	Original A/P Owed	Balance Due
DIXIE ELECTRIC POWER ASSN [08227]	4/09/2020	2124040001	5/09/2020		40.05	40.05
DIXIE ELECTRIC POWER ASSN [08227]	4/09/2020	2126800001	5/09/2020		136.78	136.78
DIXIE ELECTRIC POWER ASSN [08227]	4/09/2020	2128580000	5/09/2020		208.82	208.82
DIXIE ELECTRIC POWER ASSN [08227]	4/09/2020	2130610000	5/09/2020		109.79	109.79
DIXIE ELECTRIC POWER ASSN [08227]	4/09/2020	2130655000	5/09/2020		134.62	134.62
DIXIE ELECTRIC POWER ASSN [08227]	4/09/2020	2131440000	5/09/2020		232.22	232.22
DIXIE ELECTRIC POWER ASSN [08227]	4/09/2020	2131470001	5/09/2020		71.65	71.65
DIXIE ELECTRIC POWER ASSN [08227]	4/09/2020	2141137900	5/09/2020		656.49	656.49
DIXIE ELECTRIC POWER ASSN [08227]	4/09/2020	2141440000	5/09/2020		50.94	50.94
DIXIE ELECTRIC POWER ASSN [08227]	4/09/2020	2141440000	5/09/2020		1,726.45	1,726.45
DIXIE ELECTRIC POWER ASSN [08227]	4/09/2020	2141440000	5/09/2020		1,851.70	1,851.70
DIXIE ELECTRIC POWER ASSN [08227]	4/09/2020	2141441000	5/09/2020		1,331.53	1,331.53
DIXIE ELECTRIC POWER ASSN [08227]	4/09/2020	2141560000	5/09/2020		44.66	44.66
DIXIE ELECTRIC POWER ASSN [08227]	4/09/2020	2145040000	5/09/2020		455.47	455.47
DIXIE ELECTRIC POWER ASSN [08227]	4/09/2020	2145760001	5/09/2020		32.27	32.27
DIXIE ELECTRIC POWER ASSN [08227]	4/09/2020	2147660000	5/09/2020		405.67	405.67
DIXIE ELECTRIC POWER ASSN [08227]	4/09/2020	2147660000	5/09/2020		51.57	51.57
DIXIE ELECTRIC POWER ASSN [08227]	4/09/2020	2148520000	5/09/2020		41.21	41.21
DIXIE ELECTRIC POWER ASSN [08227]	4/09/2020	2149200000	5/09/2020		80.25	80.25
DIXIE ELECTRIC POWER ASSN [08227]	4/01/2020	90909286	5/10/2020	ANALYTICAL FEES	480.00	480.00
DIXIE ELECTRIC POWER ASSN [08227]	4/15/2020	080924	5/10/2020	TIRES	2,337.20	2,337.20
DIXIE ELECTRIC POWER ASSN [08227]	4/10/2020	930-929	5/10/2020	ANNEXATION AND BARNES	5,465.90	5,465.90
DIXIE ELECTRIC POWER ASSN [08227]	4/27/2020	1132837	5/10/2020	BALLOTS FOR RUNOFF	1,554.76	1,554.76
DIXIE ELECTRIC POWER ASSN [08227]						

EXHIBIT "D"

Intersection with the Existing Southern Right of Way Line of said Dawson's Cutoff and the Northwest Corner of said Lot 3, thence run S89°17'20"E along said Existing Southern Right of Way Line and the North Line of said Lot 3 and Lot 4 for 114.51 feet to a 1/2 Inch Rebar representing Intersection with said Proposed Southern Right of Way Line, thence run S00°44'40"W along said Proposed Southern Right of Way Line for 17.54 feet to a 1/2 Inch Rebar representing a Point 35.00 feet Right of Station 12+50.00 of said Project and having a Grid Value of N 665,508.76 feet and E 850,249.66 feet on said East Zone Grid, thence run N89°15'20"W along said Proposed Southern Right of Way Line for 72.65 feet to a Mag Nail in Pavement representing a Point 35.00 feet Right of Station 11+77.35 of said Project, thence run Westerly along an Arc to the Right and along said Proposed Southern Right of Way Line for 41.66 feet to the Point of Beginning, said Arc having a Radius of 385.00 feet, a Chord Bearing of N86°09'20"W and a Chord Distance of 41.64 feet, comprising 0.05 Acres, more or less,

Grantor fully understands that it has the right to receive just compensation for the real property herein described based on an appraisal of same, Grantor hereby waives its right to just compensation and donates the real property herein described to Forrest County, Mississippi, Grantor further understands that it has the right to request that a fair market value appraisal of the real property be made, and it hereby waives that right.

Grantor also hereby waives any claims or demands for damage accrued, accruing, or to accrue to itself, its heirs, assigns, or legal representatives, for or on account of the construction of the proposed highway, change of grade, water damage, and/or any other damage, right, or claim whatsoever.

It is further understood and agreed that this instrument constitutes the entire agreement between the Grantor and Grantee, there being no oral agreements or representations of any kind.

WITNESS MY SIGNATURE on this the 6 day of May, 2020.

CITY OF PETAL, MISSISSIPPI

By: Hal Marx
HAL MARX, MAYOR

STATE OF MISSISSIPPI
COUNTY OF FORREST

Personally appeared before me, the undersigned authority in and for the above said County and State, the within named HAL MARX, who acknowledged that he signed, executed, and delivered the above and foregoing Warranty Deed on the day and year therein mentioned in his capacity as the Mayor of the CITY OF PETAL, MISSISSIPPI, and as its free and voluntary act and deed, having first been duly authorized so to do.

Given under my hand and seal of office this the 6 day of May, 2020.

Melissa Martin
NOTARY

My Commission Expires:



Prepared by and return to:
David B. Miller, MSB No. 99638
Forrest County Board Attorney
P.O. Box 1310 Hattiesburg, MS 39401
Hattiesburg, MS 39403
601-545-6006

INDEXING INSTRUCTIONS:
Pt. of NW 1/4 of NW1/4, Section 11,
Township 4 North, Range 13 West,
AND Pt. of Lot 3, Block 1, of Q. L.
Dawson's Sub. of Village of Harvey,
City of Petal, Forrest County

STATE OF MISSISSIPPI
COUNTY OF FORREST

WARRANTY DEED

For and in consideration of the sum of Ten Dollars (\$10.00), cash in hand paid, and other good and valuable consideration, the receipt and sufficiency of all of which are hereby acknowledged,

CITY OF PETAL, MISSISSIPPI
119 W. 8TH Ave.
Petal, MS 39465

the undersigned Grantor, does hereby grant, bargain, sell, convey, and warrant unto

FORREST COUNTY, MISSISSIPPI
c/o Forrest County Board of Supervisors
Post Office Box 1310
Hattiesburg, MS 39403
601-545-6000

Grantee, the following described property, situated in Forrest County, Mississippi, to-wit:

A part of the Northwest 1/4 of the Northwest 1/4, Section 12, Township 4 North, Range 13 West and a part of Lot 3, Block 1 of Q.L. Dawson's Subdivision of the Village of Harvey as per map or plat thereof on file in the Office of the Chancery Clerk of Forrest County, Mississippi, all in the City of Petal, County of Forrest, State of Mississippi, and being more particularly described using Mississippi State Plane Coordinate System, East Zone Grid, NAD 83(2011), US Survey Feet, with a combined scale factor of 0.99996810 and a convergence angle of (minus) -0°13'23.98" at the Southwest Corner of said Northwest 1/4 of the Northwest 1/4 and commencing at a 1/2 Inch Round Iron Pin representing said Southwest Corner and having a Grid Value of N 665,238.71 feet and E 850,137.34 feet on said East Zone Grid, thence run N00°36'46"W along the West Line of said Northwest 1/4 of the Northwest 1/4 for 71.54 feet to a 1/2 Inch Rebar representing the Southeast Corner of Lot 2 of said Block 1, thence run N00°18'51"W along said West Quarter Section Line for 202.26 feet to 1/2 Inch Rebar representing its Intersection with the Proposed Southern Right of Way Line of Dawson's Cutoff, also known as Ann St and a public roadway, as per Forrest County Project No. ERBR-18(03) and a Point on the West Line of said Lot 3 and the Point of Beginning and having a Grid Value of N 665,512.50 feet and E 850,135.47 feet on said East Zone Grid; thence continue N00°18'51"W along said West Lot Line and said West Quarter Section Line for 15.22 feet to a 1/2 Inch Crimp Top Pin representing its

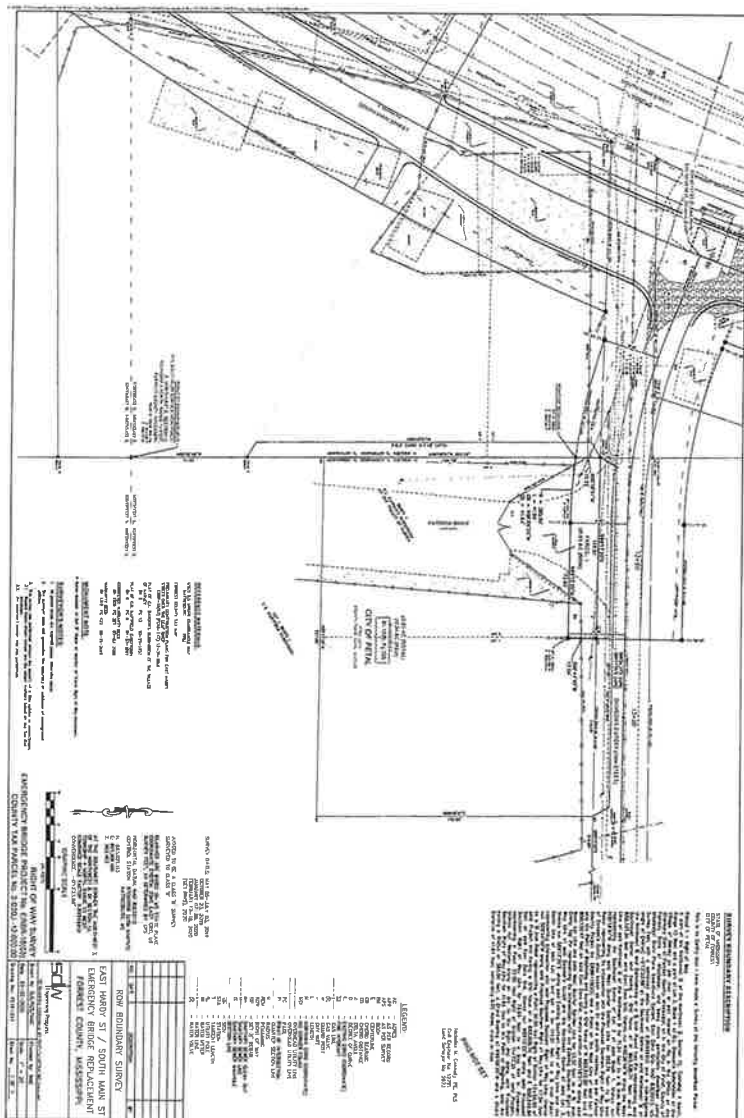

ORDINANCE NO. 2020-142
AN ORDINANCE
GRANTING A NON-EXCLUSIVE ELECTRIC FRANCHISE TO
MISSISSIPPI POWER COMPANY, ITS SUCCESSORS, AND ASSIGNS
IN THE MUNICIPALITY OF PETAL, MISSISSIPPI

BE IT ORDAINED by the Governing Authority of the Municipality of Petal, Mississippi:

SECTION 1. In consideration of the benefits that will accrue to the Municipality of Petal, Mississippi, and the inhabitants thereof (the "Municipality"), and of the payment by Mississippi Power Company (the "Grantor") to the Municipality of a sum of money equal to three percent (3%) per year of the total gross revenue of the Grantor from the retail sales of electric energy, including therefore sales for resale and sales in interchange of energy with others, within the corporate limits of the Municipality, payable quarterly on or before thirty (30) days following the close of each calendar quarter during such period as the Grantor operates in said Municipality, but not to exceed twenty-five (25) years from the Effective Date of this Ordinance (as defined in Section 16), the Municipality does hereby grant to and vest in the Grantor, its successors and assigns as franchised activities, the right, authority, easement, privilege, and franchise to construct, erect, suspend, install, renew, repair, maintain, operate, and conduct in the Municipality as these ends or may hereafter be extended, equipment, facilities, lines, including communication lines, plant or plants, and system or systems for the generation, transmission, or distribution of electric energy ("Primary Use"), including, without limitation, broadband services, internet access and services, telecommunications services, and fiber optic communication services that are for or in support of the Primary Use (collectively, "Franchised Activities"). The use of Authorized Facilities (as defined below for any other purposes whatsoever, including without limitation, broadband services, internet access and services, telecommunications services, and fiber optic communication services that are not for or in support of the Primary Use and/or for or in any person or entity other than the Grantor, regardless of whether for compensation ("Ancillary Use") shall be excluded from the franchise granted by this Ordinance and the calculation and payment of such fees shall be governed solely by separate franchise, agreement, or ordinances of the Municipality applicable to such Ancillary Use, if any. It shall be the obligation of the Grantor and the person or entity providing such services associated with Ancillary Use to or for any person or entity other than the Grantor, regardless of whether for compensation, to notify the Municipality of any such Ancillary Use and to obtain a franchise, agreement, or ordinance in connection with such Ancillary Use. Notwithstanding anything contained herein to the contrary, the use of any facilities constructed, maintained, and operated for or in support of the Primary Use shall not be governed by any other franchise agreement or ordinance.

SECTION 2. To facilitate the Franchised Activities, the Municipality does hereby give and grant to, and vest in, the Grantor, its successors and assigns, the further right, authority, easement, privilege, and franchise to construct, erect, suspend, install, renew, repair, maintain, operate and conduct in the Municipality for such Franchised Activities a system(s) of poles, towers, conduits, cables, fiber, wires, conductors, transforming stations, plants, fittings, and all appurtenances or appurtenances needed to purchase, promote, and carry out the Primary Use (such system and its components collectively referred to herein as "Authorized Facilities") in, over, under, along, upon, and across all streets, avenues, alleys, ways, bridges, and public places in the Municipality as may now exist or may hereafter be laid out or extended, together with the further right, privilege, and franchise to construct, erect, suspend, install, renew, repair, maintain, operate such Authorized Facilities within, into, through, over, under, across, and beyond the Municipality and township, supplying and distributing to the Municipality and to the inhabitants, corporations and other entities (public or private) (collectively with the Municipality, "Inhabitants"), both within and beyond the limits thereof, electric energy for lighting, heating, power, security and convenience, and all other purposes for which electric energy and related facilities may be used now or hereafter, and for the purpose of extending its lines and furnishing electric energy beyond the limits of the Municipality. The Municipality further agrees, for itself and its inhabitants, in consideration for the Supplemental Fees paid by the Grantor, that it will not compete in any manner with the Grantor for the generation, including self-generation or self-supply, transmission, distribution, or sale of electric energy, including but not limited to any attempt, directly or indirectly, to acquire such a system, as such terms are defined in Title 21, Chapter 27, Section 11 of the Mississippi Code of 1972, as amended. Notwithstanding anything contained herein to the contrary, the Grantor's Franchised Activities shall not include any work or project that does not support the Primary Use, should the Grantor desire to construct, maintain, or operate any equipment or facilities that are not Authorized Facilities to support the Primary Use. The Grantor agrees to obtain a separate franchise agreement under any applicable ordinance governing franchises for such facilities and such contemplated activities, and to comply with any governing or applicable ordinance with

FF2-2

WHEREAS, a form of ordinance was presented to the Municipality of Petal, Mississippi on the 7th day of April, 2020, presented to the Municipality of Petal providing for the grant of a franchise to Mississippi Power Company and, pursuant to an order heretofore adopted on the 7th day of April, 2020, said form of ordinance has remained on file with the Clerk of the Municipality of Petal, Mississippi, for a period of not less than two weeks as required by law; and

WHEREAS, the said matter now coming on for consideration, upon motion made by Alderman Clayton and duly seconded by Alderman Amacker, the following ordinance was adopted:

FF2-1

or law of the State of Mississippi. No shall the granting of this franchise be construed or operate to abridge, impair, or deny the validly held rights of any other distributor of electric energy within the Municipality, or portion thereof, by virtue either of a franchise from the Municipality or a certificate of public convenience and necessity issued pursuant to Title 27, Chapter 3, Mississippi Code of 1972, as amended.

SECTION 11. The rights hereby granted shall become effective upon the passage of this Ordinance in accordance with Section 16 hereof and continue for a period of twenty-five (25) years from the Effective Date, unless terminated sooner as provided for in Section 15.

SECTION 12. In any clause, provision or section of this Ordinance that is illegal, or is not embraced within the title hereof, or is not related to the subject expressed in the title, the remaining provisions hereof shall not be thereby affected but shall have full force and operation.

SECTION 13. The Grantor shall pay the Municipality the cost of publishing the Ordinance according to law and also the cost of holding a special election for the approval or disapproval by the qualified electors of the Municipality of this Ordinance.

SECTION 14. This franchise is in lieu of and supersedes a franchise previously granted to Grantor by the Municipality, which upon the Effective Date of this Ordinance shall, by mutual consent of the parties hereto, no longer be in force and effect.

SECTION 15. Grantor and Municipality mutually acknowledge that in the event the Regulatory Authority, or any court of law, tribunal, regulatory agency or other body with authority to alter Grantor's rates for electric service, taxes, fees, limits, or otherwise modifies Grantor's payments provided for under this Ordinance, or otherwise, directly or indirectly, deprives Grantor's recovery through rates of all or any portion of this Ordinance's prescribed fees, Grantor's fees provided for in Section 11 shall, without amendment to this Ordinance, be modified to the amount allowed for recovery by the Regulatory Authority, but the Franchised Activities granted by this Ordinance shall remain unchanged in any manner whatsoever. Further, Grantor retains the right to collect the franchise fees hereunder from the inhabitants of the Municipality in any manner satisfactory to Grantor, provided that Grantor provides advance written notice of the same to the Municipality. In the event of such modification, either party may terminate this Ordinance upon giving the other party thirty (30) days written notice and upon such termination, the Grantor's and Municipality's rights and obligations under this Ordinance shall cease. Notwithstanding the termination of this Ordinance by either party pursuant to this Section 15, the provision of any services contemplated as an Ancillary Use and any fees applicable to such Ancillary Use shall be governed by the Municipality's other ordinances, franchises, and/or agreements applicable to such use.

SECTION 16. This Ordinance shall not become effective until it is duly passed by the Governing Body, published as required by law, and approved by a majority vote of qualified electors of the Municipality voting thereon at a special election duly called and held as required by law ("Effective Date").

The within and foregoing Ordinance, having been introduced in writing at a regular meeting of the aforesaid Governing Body of the Municipality and having thereafter remained on file with the Clerk for public inspection for a period of at least two weeks before the final passage or adoption thereof, was considered by sections at a public meeting of the said Governing Body in the form in which it was introduced and upon motion of Alderman Clayton, duly seconded by Alderman Amacker, that it be adopted, a final yeas and nays vote was taken, which resulted as follows:

Voting Yeas:	
Alderman Brad Amacker	Alderman Steve Springs
Alderman David Clayton	
Alderman Tony Duster	
Alderman Chris Moore	
Voting Nays: NONE	
Assent: Alderman Craig Bullock	

FF2-4

respect to the construction, location, and use of such facilities, infrastructure, and activities, including the payment of any fees by Grantor to the Municipality as provided with such franchise.

SECTION 3. In further consideration for the fees said by Grantor to the Municipality hereunder, the rights provided to Grantor herein shall specifically include the right for Grantor to install, at its election and cost, electric vehicle charging stations ("EV Chargers") in locations designated or approved in advance by the Municipality in writing and permitted by law to accommodate such uses. All EV Chargers installed in such designated or approved locations shall, unless set out otherwise in a separate agreement, constitute Authorized Facilities and shall be maintained by Grantor in a reasonable good condition and repair. All such usage shall be metered and billed by Grantor to users of the EV Chargers at rates set by Grantor, unless such rates are otherwise subject to the jurisdiction of the Mississippi Public Service Commission, its successor, or any other authority with jurisdiction over Grantor's rates for electric energy sales ("Regulatory Authority"). In addition, the Municipality shall have the right, at its election and cost, to require Grantor to install EV Chargers at locations of the Municipality's choosing within the Municipality, the usage of which shall be metered and billed by the Municipality.

SECTION 4. The Authorized Facilities shall be so installed or constructed as not unreasonably to interfere with the proper use of the streets, avenues, alleys, ways, bridges, and public places in the Municipality and shall be maintained at all in a reasonably good condition and repair.

SECTION 5. Whenever the Grantor shall cause any opening or alteration to be made in any of the streets, avenues, alleys, ways, bridges, or public places of the Municipality for the purpose of installing, maintaining, operating, or repairing any Authorized Facilities, the work shall be completed within a reasonable time, and the Grantor shall, upon the completion of such work, restore such portion of the streets, avenues, alleys, ways, bridges, or other public places to as good a condition as it was before the opening or alteration was so made.

SECTION 6. The Grantor shall indemnify and hold the Municipality harmless from any and all liability or damages resulting from the negligence of the Grantor in the construction, maintenance, or operation of its Authorized Facilities.

SECTION 7. The Grantor may, from time to time, discontinue, make, and enforce reasonable rules and regulations as conditions for the sale and distribution by it of electric energy to any person, firm, or corporation, not, however, in conflict with the requirements of the jurisdiction of the Mississippi Public Service Commission under the provisions of Title 27, Chapter 3, Mississippi Code of 1972, as amended.

SECTION 8. In the event the supply of electric energy shall be interrupted or fail by reason of accident or otherwise, beyond the Control of the Grantor, the Grantor shall restore the service within a reasonable time and such interruption shall not constitute a breach of this franchise, nor shall the Grantor be liable for damage by reason of such interruption or failure.

SECTION 9. Wherever in this Ordinance within the Municipality or the Grantor is named or referred to, if it shall be deemed to include the respective successors or assigns of either, and all rights, privileges, and obligations herein conferred shall bind and run to the benefit of such successors or assigns of the Municipality or of the Grantor. Further, if during the term of this franchise, the boundaries of the Municipality are expanded, the Municipality will promptly notify Grantor in writing of any geographic areas annexed by the Municipality ("Annexation Notice"). Any such Annexation Notice shall be sent to Grantor by certified mail, return receipt requested, and shall contain the effective date of the annexation, maps showing the annexed areas and such other information as may be reasonably required to ascertain whether Grantor serves any customers in the annexed area. To the extent there are such customers of Grantor situated in the annexed area, then the revenues provided for in Section 1 of this Ordinance shall be calculated to include those customers effective on the first day of Grantor's billing cycle immediately following Grantor's receipt of the Annexation Notice. Failure by the Municipality to advise Grantor in writing through the proper Annexation Notice of any geographic areas which are annexed by the Municipality shall relieve Grantor from any obligation to send any franchise fees to the Municipality based upon gross revenues derived from customers within the annexed area until the Municipality delivers an Annexation Notice in accordance with the terms set forth herein.

SECTION 10. This franchise is in addition to and supplemental to any and all such rights as the Grantor may have by virtue of the provisions of Title 27, Chapter 3, of the Mississippi Code of 1972, as amended, and any other section of the Mississippi Code of 1972, as amended, and the same may be legally binding or applicable to the Municipality or this franchise Ordinance, and its acceptance and exercise by the Grantor shall never be construed as a waiver, abandonment, or termination upon the rights now vested in or being exercised by the Grantor under any statute

FF2-3

STATE OF MISSISSIPPI
 COUNTY OF FORREST

CERTIFICATE

I, Melissa Martin, Clerk of the Municipality of Petal, Mississippi, do hereby certify that the within foregoing pages numbered from FF2-1 to FF2-5, inclusive, are a true and correct copy of an ordinance adopted by the Municipality of Petal, Mississippi, at a meeting held on the 5th day of May, 2020, and filed; AN ORDINANCE GRANTING A NON-EXCLUSIVE ELECTRIC FRANCHISE TO MISSISSIPPI POWER COMPANY, ITS SUCCESSORS, AND ASSIGNS, IN THE MUNICIPALITY OF PETAL, MISSISSIPPI. This Ordinance has been recorded in Minute Book 37, on Pages 148 of the Minutes of the Board of Aldermen of Petal, Mississippi.

WITNESS my signature this the 14 day of May, 2020.

 Melissa Martin
 Clerk, Municipality of Petal, Mississippi

FF2-6

Whereupon the motion was declared carried and the Ordinance declared adopted.
 APPROVED this 5th day of May, 2020.



(Certificate Page Follows)

CITY OF PETAL
 MINUTE BOOK 37
 EXHIBIT "E"